

# SECTION 2

## 15 SERIES

### MOUNTING BRACKETS

Brackets

#### CORNER BRACKETS



#### JOINING PLATES

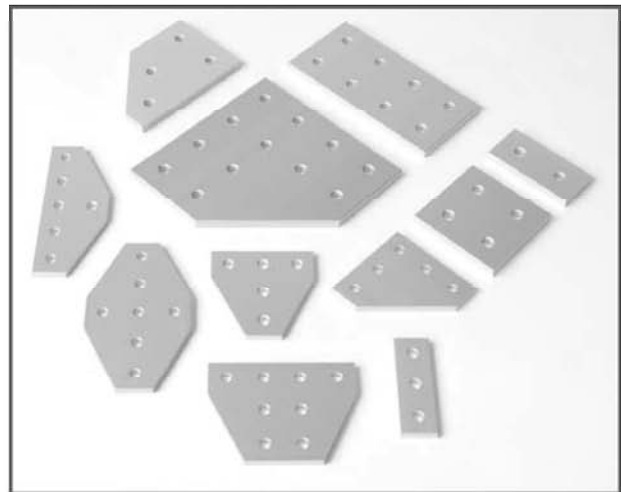

#### 45° SUPPORTS

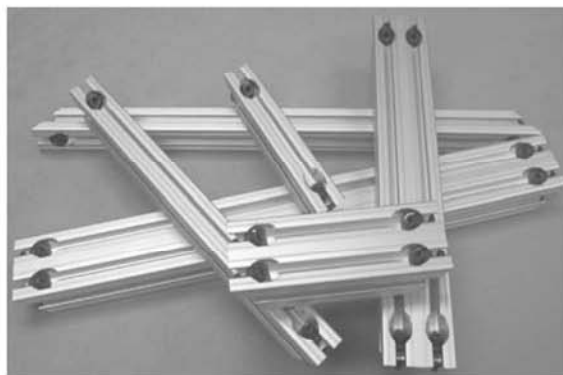

# BOLT PATTERN DIMENSIONS

## 15 Series Dimensions

The following patterns are for all  
Joining Plates and Inside Corner Brackets

### Joining Strips

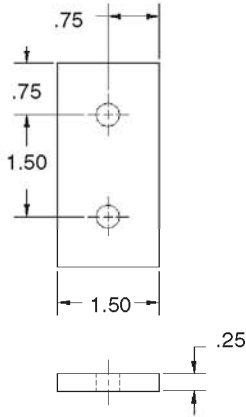

### Joining Plates

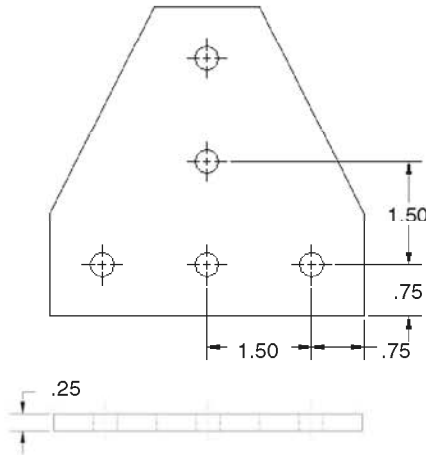

### Corner Brackets

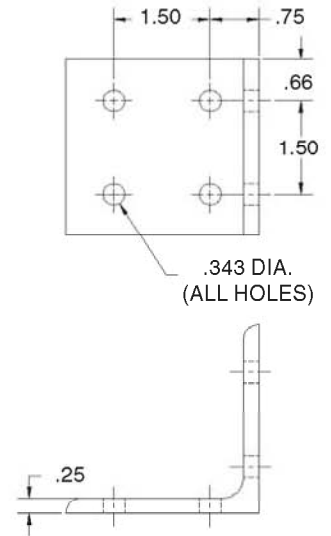

All Joining Plates and Corner  
Brackets are made from 6061-T6  
& 6063-T6 clear anodized aluminum

Don't Let



OSHA

Catch You



With

Your Guarding

Down!

- 2D & 3D CAD Support
- Full Inventory of Products
- Completely Modular

- FAST Shipments!



- Free Design Assistance

- Made in the USA
- Free Kit Packaging
- Competitive Pricing

# 15CB4000

15 SERIES  
2 HOLE SLOTTED INSIDE CORNER BRACKET

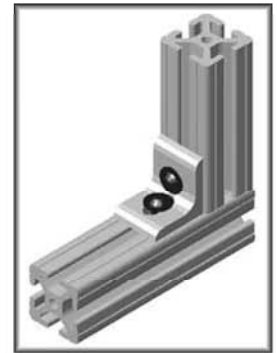
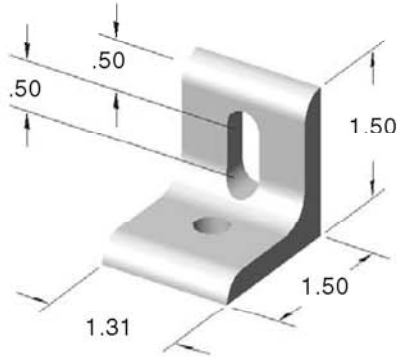

Part Wt: .075 lbs

RECOMMENDED HARDWARE

QTY	DESCRIPTION	PART #
2	5/16-18 x 5/8 FBHSCS	13FA3331
2	5/16-18 ECONOMY T-NUT	15FA3501

For additional fasteners and t-nuts, see pages 130-135

# 15CB4001

15 SERIES  
6 HOLE SLOTTED INSIDE CORNER BRACKET

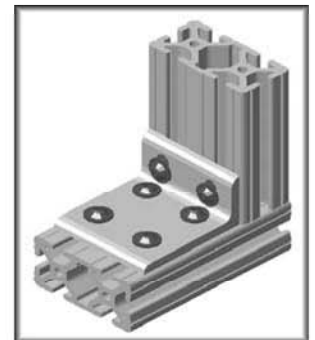
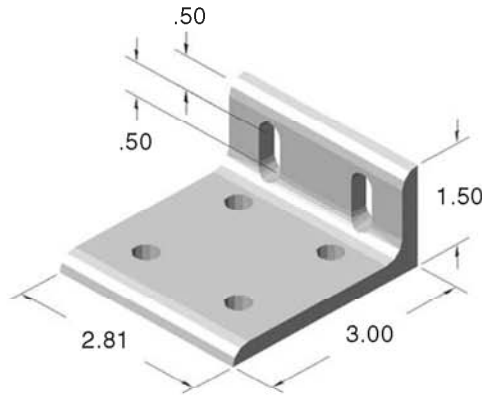

Part Wt: .265 lbs

RECOMMENDED HARDWARE

QTY	DESCRIPTION	PART #
6	5/16-18 x 5/8 FBHSCS	13FA3331
6	5/16-18 ECONOMY T-NUT	15FA3501

For additional fasteners and t-nuts, see pages 130-135

# 15CB4002

15 SERIES  
4 HOLE SLOTTED INSIDE CORNER BRACKET

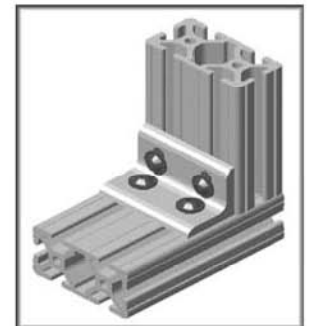
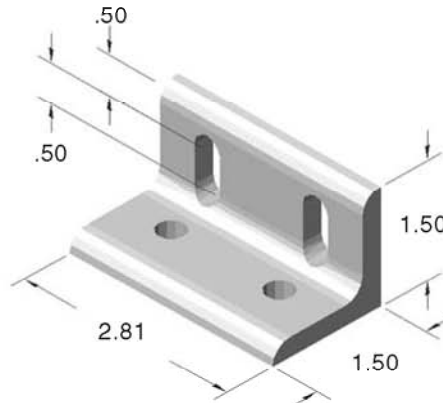

Part Wt: .170 lbs

RECOMMENDED HARDWARE

QTY	DESCRIPTION	PART #
4	5/16-18 x 5/8 FBHSCS	13FA3331
4	5/16-18 ECONOMY T-NUT	15FA3501

For additional fasteners and t-nuts, see pages 130-135

### 15CB4003

15 SERIES  
6 HOLE SLOTTED INSIDE CORNER BRACKET

FOR FAST ASSEMBLY  
USE 15FA3502



OR

FOR FASTER ASSEMBLY  
USE 15FA3520

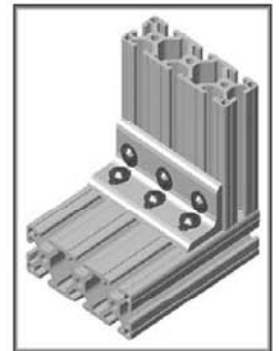
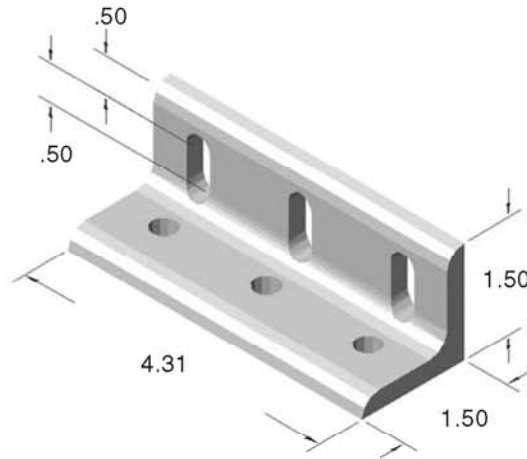

Part Wt: .265 lbs

RECOMMENDED HARDWARE

QTY	DESCRIPTION	PART #
6	5/16-18 x 5/8 FBHSCS	13FA3331
6	5/16-18 ECONOMY T-NUT	15FA3501

For additional fasteners and t-nuts, see pages 130-135

### 15CB4004

15 SERIES  
9 HOLE SLOTTED INSIDE CORNER BRACKET

FOR FAST ASSEMBLY  
USE 15FA3502



OR

FOR FASTER ASSEMBLY  
USE 15FA3520

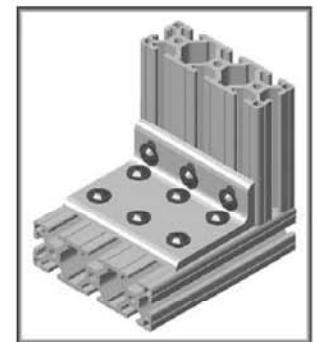
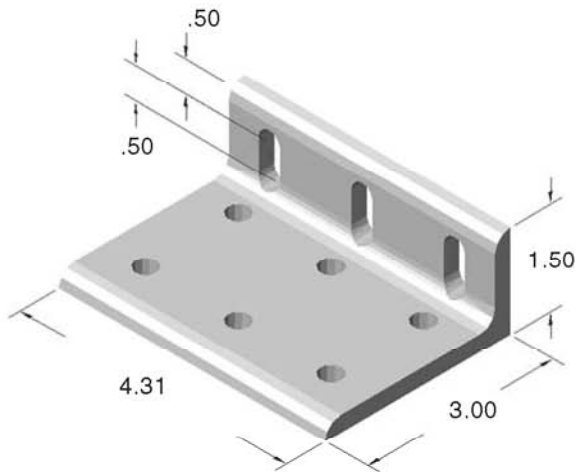

Part Wt: .410 lbs

RECOMMENDED HARDWARE

QTY	DESCRIPTION	PART #
9	5/16-18 x 5/8 FBHSCS	13FA3331
9	5/16-18 ECONOMY T-NUT	15FA3501

For additional fasteners and t-nuts, see pages 130-135

### 15CB4005

15 SERIES  
3 HOLE SLOTTED INSIDE CORNER BRACKET

FOR FAST ASSEMBLY  
USE 15FA3502

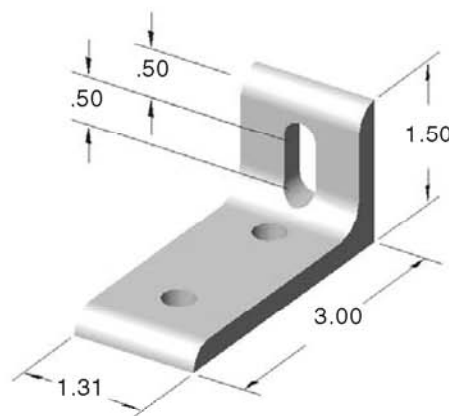

Part Wt: .120 lbs

RECOMMENDED HARDWARE

QTY	DESCRIPTION	PART #
3	5/16-18 x 5/8 FBHSCS	13FA3331
3	5/16-18 ECONOMY T-NUT	15FA3501

For additional fasteners and t-nuts, see pages 130-135



*Fast-Flexible-Functional*

## MACHINE GUARDING



- Safety & Protection
- Machines, Conveyors
- Robotics, Walkways
- Guard from debris, dust & liquids
- Lockout switches available
- Ultra-Lite materials available
- Extremely cost effective

[www.faztek.net](http://www.faztek.net)

Brackets

# 15CB4801

15 SERIES  
2 HOLE INSIDE CORNER BRACKET

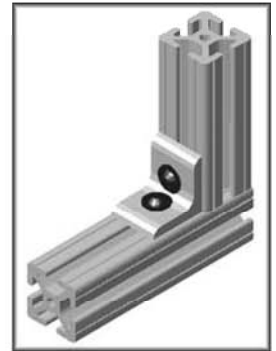
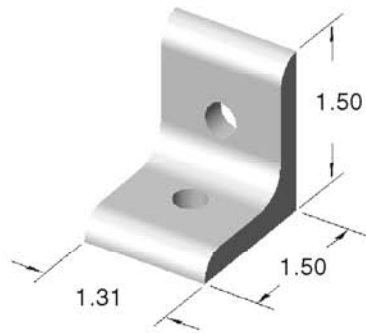

Part Wt: .080 lbs

RECOMMENDED HARDWARE

QTY	DESCRIPTION	PART #
2	5/16-18 x 5/8 FBHSCS	13FA3331
2	5/16-18 ECONOMY T-NUT	15FA3501

For additional fasteners and t-nuts, see pages 130-135

# 15CB4802

15 SERIES  
3 HOLE INSIDE CORNER BRACKET

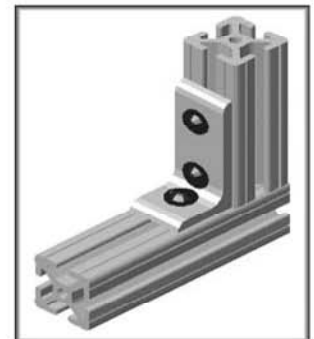
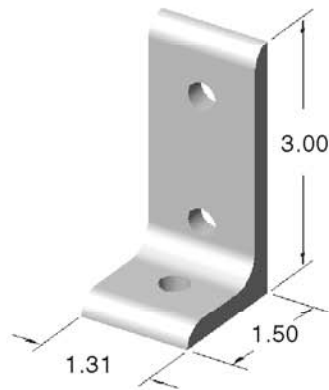

Part Wt: .130 lbs

RECOMMENDED HARDWARE

QTY	DESCRIPTION	PART #
3	5/16-18 x 5/8 FBHSCS	13FA3331
3	5/16-18 ECONOMY T-NUT	15FA3501

For additional fasteners and t-nuts, see pages 130-135

# 15CB4803

15 SERIES  
4 HOLE INSIDE CORNER BRACKET

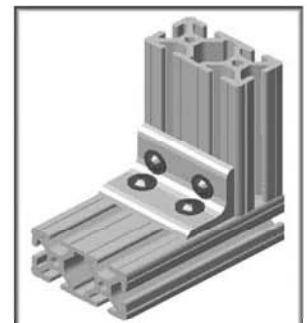
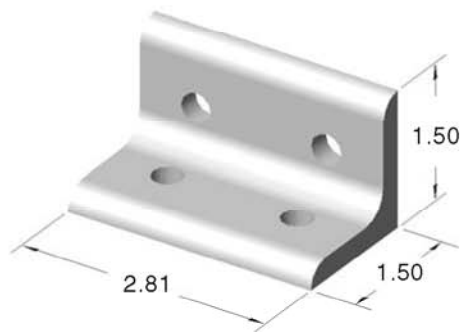

Part Wt: .175 lbs

RECOMMENDED HARDWARE

QTY	DESCRIPTION	PART #
4	5/16-18 x 5/8 FBHSCS	13FA3331
4	5/16-18 ECONOMY T-NUT	15FA3501

For additional fasteners and t-nuts, see pages 130-135

# 15CB4804

15 SERIES  
4 HOLE INSIDE CORNER BRACKET



FOR FAST ASSEMBLY  
USE 15FA3502

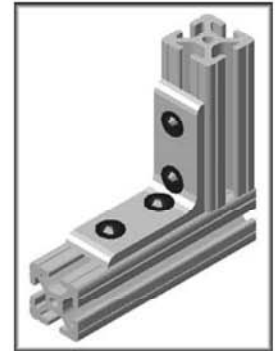
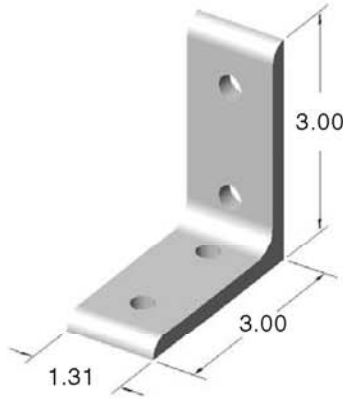

Part Wt: .170 lbs

RECOMMENDED HARDWARE

QTY	DESCRIPTION	PART #
4	5/16-18 x 5/8 FBHSCS	13FA3331
4	5/16-18 ECONOMY T-NUT	15FA3501

For additional fasteners and t-nuts, see pages 130-135

# 15CB4805

15 SERIES  
8 HOLE INSIDE CORNER BRACKET



FOR FAST ASSEMBLY  
USE 15FA3502

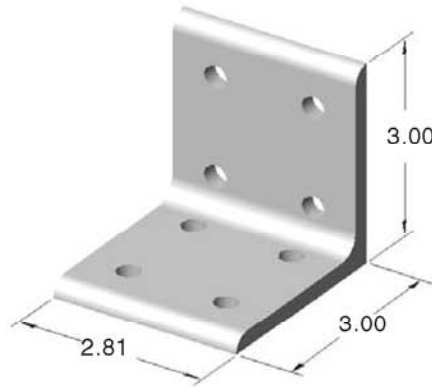

Part Wt: .365 lbs

RECOMMENDED HARDWARE

QTY	DESCRIPTION	PART #
8	5/16-18 x 5/8 FBHSCS	13FA3331
8	5/16-18 ECONOMY T-NUT	15FA3501

For additional fasteners and t-nuts, see pages 130-135

# 15CB4806

15 SERIES  
6 HOLE INSIDE CORNER BRACKET



FOR FAST ASSEMBLY  
USE 15FA3502

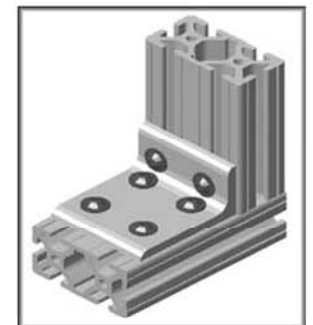
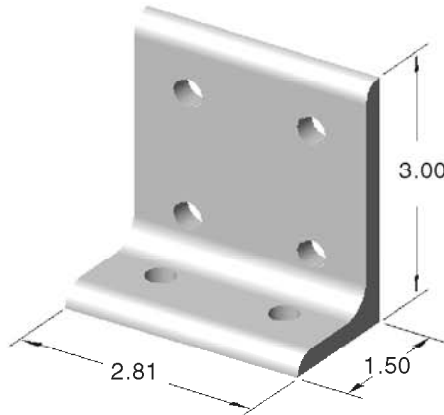

Part Wt: .285 lbs

RECOMMENDED HARDWARE

QTY	DESCRIPTION	PART #
6	5/16-18 x 5/8 FBHSCS	13FA3331
6	5/16-18 ECONOMY T-NUT	15FA3501

For additional fasteners and t-nuts, see pages 130-135

Brackets

# 15CB4808

15 SERIES  
12 HOLE CENTER INSIDE CORNER BRACKET

FOR FAST ASSEMBLY  
USE 15FA3502



OR

FOR FASTER ASSEMBLY  
USE 15FA3520



RECOMMENDED HARDWARE

QTY	DESCRIPTION	PART #
12	5/16-18 x 5/8 FBHSCS	13FA3331
12	5/16-18 ECONOMY T-NUT	15FA3501

For additional fasteners and t-nuts, see pages 130-135

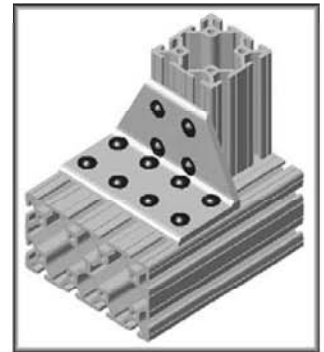
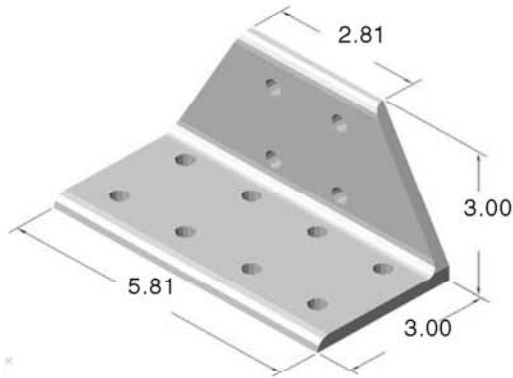

Part Wt: .665 lbs

# 15CB4811

15 SERIES  
6 HOLE RIGHT INSIDE CORNER BRACKET

FOR FAST ASSEMBLY  
USE 15FA3502



RECOMMENDED HARDWARE

QTY	DESCRIPTION	PART #
6	5/16-18 x 5/8 FBHSCS	13FA3331
6	5/16-18 ECONOMY T-NUT	15FA3501

For additional fasteners and t-nuts, see pages 130-135

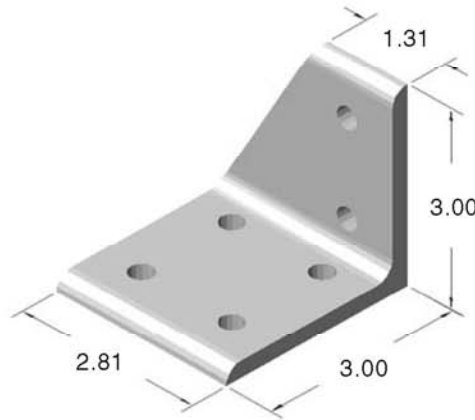

Part Wt: .330 lbs

# 15CB4812

15 SERIES  
6 HOLE LEFT INSIDE CORNER BRACKET

FOR FAST ASSEMBLY  
USE 15FA3502



RECOMMENDED HARDWARE

QTY	DESCRIPTION	PART #
6	5/16-18 x 5/8 FBHSCS	13FA3331
6	5/16-18 ECONOMY T-NUT	15FA3501

For additional fasteners and t-nuts, see pages 130-135

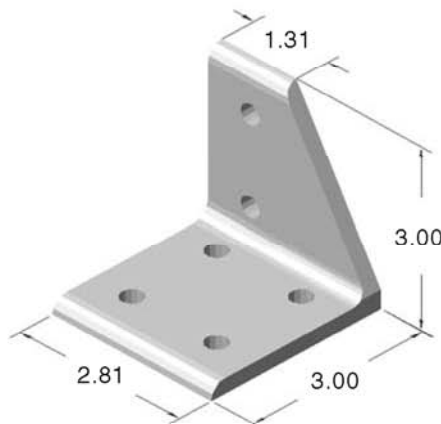

Part Wt: .320 lbs



# 15CB4813

15 SERIES  
6 HOLE CENTER INSIDE CORNER BRACKET



FOR FAST ASSEMBLY  
USE 15FA3502

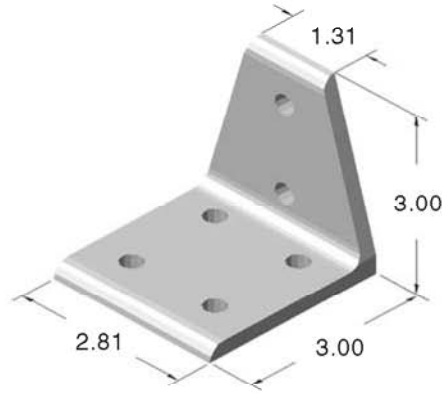

Part Wt: .335 lbs

RECOMMENDED HARDWARE

QTY	DESCRIPTION	PART #
6	5/16-18 x 5/8 FBHSCS	13FA3331
6	5/16-18 ECONOMY T-NUT	15FA3501

For additional fasteners and t-nuts, see pages 130-135

Brackets

# 15CB4815

15 SERIES  
6 HOLE INSIDE CORNER BRACKET



FOR FAST ASSEMBLY  
USE 15FA3502

OR



FOR FASTER ASSEMBLY  
USE 15FA3520

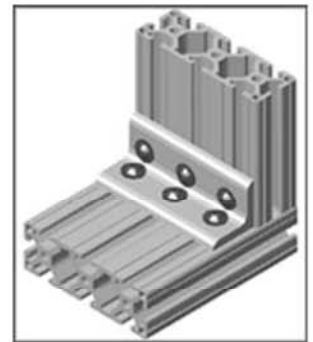
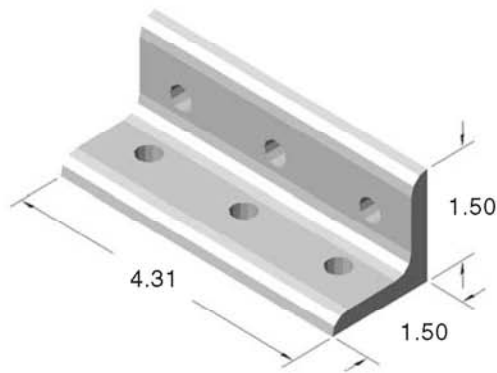

Part Wt: .275 lbs

RECOMMENDED HARDWARE

QTY	DESCRIPTION	PART #
6	5/16-18 x 5/8 FBHSCS	13FA3331
6	5/16-18 ECONOMY T-NUT	15FA3501

For additional fasteners and t-nuts, see pages 130-135

# 15CB4816

15 SERIES  
12 HOLE INSIDE CORNER BRACKET



FOR FAST ASSEMBLY  
USE 15FA3502

OR



FOR FASTER ASSEMBLY  
USE 15FA3520

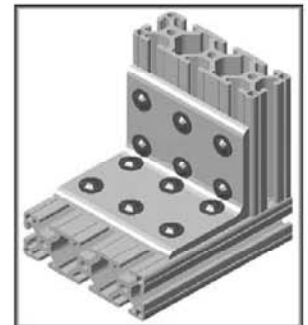
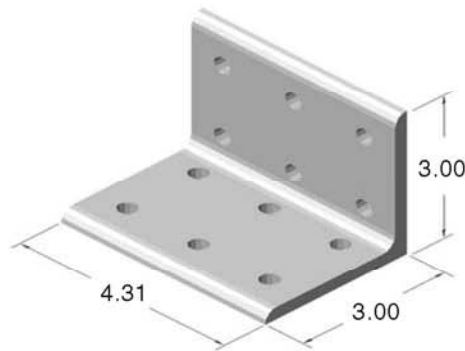

Part Wt: .550 lbs

RECOMMENDED HARDWARE

QTY	DESCRIPTION	PART #
12	5/16-18 x 5/8 FBHSCS	13FA3331
12	5/16-18 ECONOMY T-NUT	15FA3501

For additional fasteners and t-nuts, see pages 130-135

# 15CB4840

15 SERIES  
2 HOLE INSIDE GUSSET CORNER BRACKET

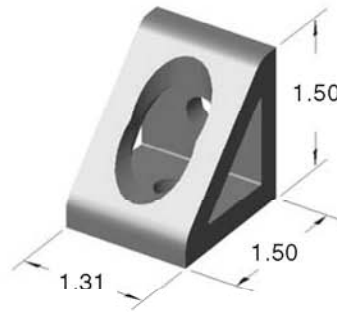

Part Wt: .115 lbs

**Strongest of all corner brackets!**

RECOMMENDED HARDWARE

QTY	DESCRIPTION	PART #
2	5/16 18 x 5/8 FBHSCS	13FA3331
2	5/16-18 ECONOMY T-NUT	15FA3501

*For additional fasteners and t-nuts, see pages 130-135*

# 15CB4857

15 SERIES  
2 HOLE INSIDE GUSSET CORNER BRACKET

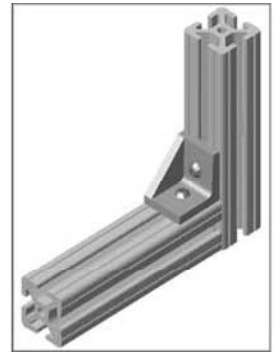
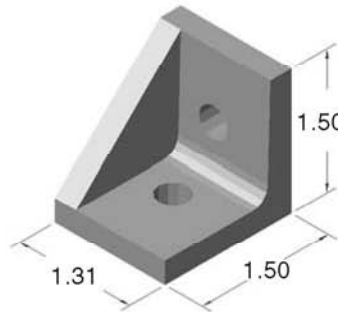

Part Wt: .115 lbs

**Strongest of all corner brackets!**

RECOMMENDED HARDWARE

QTY	DESCRIPTION	PART #
2	5/16-18 x 5/8 BHSCS	13FA3322
2	5/16-18 ECONOMY T-NUT	15FA3501

*For additional fasteners and t-nuts, see pages 130-135*

# 15CB4860

15 SERIES  
2 HOLE INSIDE GUSSET CORNER BRACKET

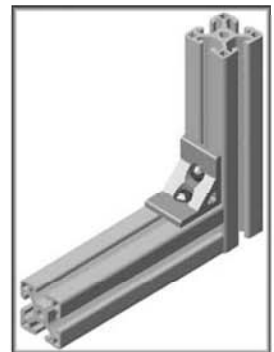
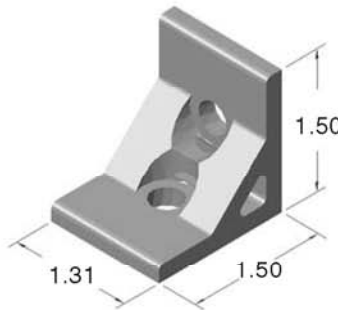

Part Wt: .115 lbs

**Strongest of all corner brackets!**

RECOMMENDED HARDWARE

QTY	DESCRIPTION	PART #
2	5/16-18 x 5/8 BHSCS	13FA3322
2	5/16-18 ECONOMY T-NUT	15FA3501

*For additional fasteners and t-nuts, see pages 130-135*

## 15CB4841

15 SERIES  
4 HOLE INSIDE GUSSET CORNER BRACKET



FOR FAST ASSEMBLY  
USE 15FA3502

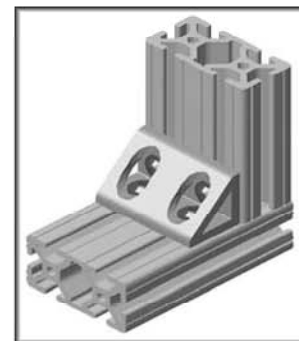
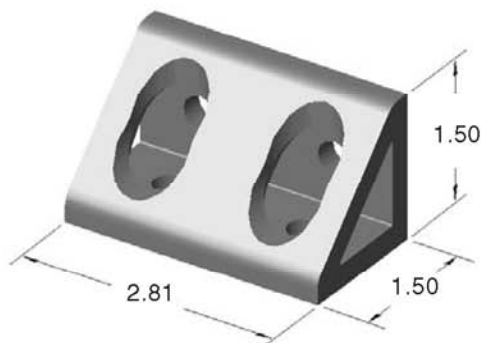

Part Wt: .245 lbs

RECOMMENDED HARDWARE

QTY	DESCRIPTION	PART #
4	5/16-18 x 5/8 FBHSCS	13FA3331
4	5/16-18 ECONOMY T-NUT	15FA3501

For additional fasteners and t-nuts, see pages 130-135

**Strongest of all  
corner brackets!**

Brackets

## 15CB4861

15 SERIES  
4 HOLE INSIDE GUSSET CORNER BRACKET



FOR FAST ASSEMBLY  
USE 15FA3502

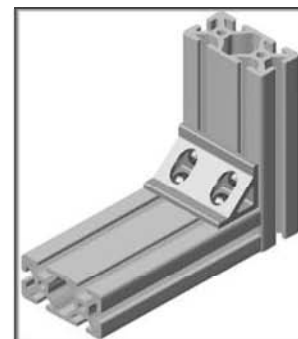
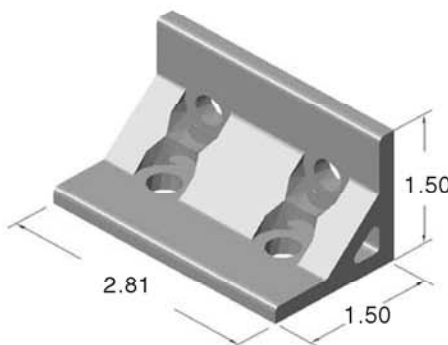

Part Wt: .245 lbs

RECOMMENDED HARDWARE

QTY	DESCRIPTION	PART #
4	5/16-18 x 5/8 BHSCS	13FA3322
4	5/16-18 ECONOMY T-NUT	15FA3501

For additional fasteners and t-nuts, see pages 130-135



**Strongest of all  
corner brackets!**



**ACCESS HOLE  
MACHINE**

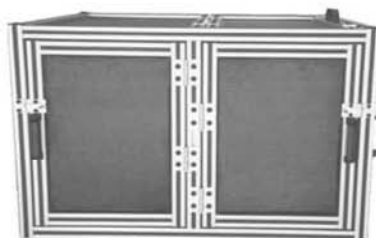

**SOUND ENCLOSURES**

**MACHINE  
BASES**



**MACHINE  
ENCLOSURE**



**PALLET  
HORSES**

# 15CB4840

15 SERIES  
2 HOLE INSIDE GUSSET CORNER BRACKET

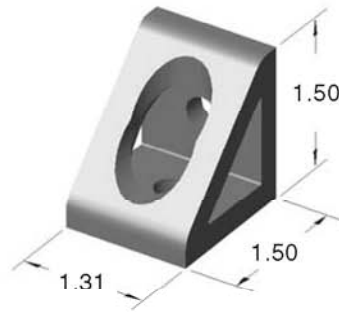

Part Wt: .115 lbs

**Strongest of all corner brackets!**

RECOMMENDED HARDWARE

QTY	DESCRIPTION	PART #
2	5/16 18 x 5/8 FBHSCS	13FA3331
2	5/16-18 ECONOMY T-NUT	15FA3501

For additional fasteners and t-nuts, see pages 130-135

# 15CB4857

15 SERIES  
2 HOLE INSIDE GUSSET CORNER BRACKET

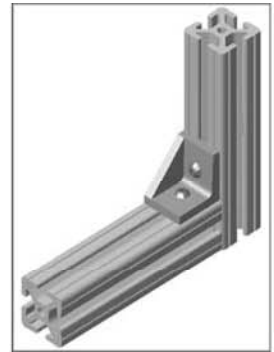
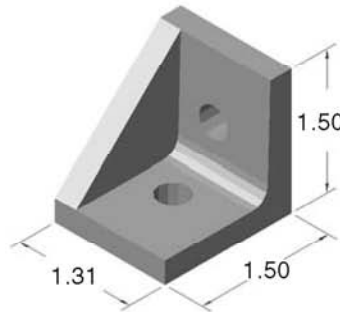

Part Wt: .115 lbs

**Strongest of all corner brackets!**

RECOMMENDED HARDWARE

QTY	DESCRIPTION	PART #
2	5/16-18 x 5/8 BHSCS	13FA3322
2	5/16-18 ECONOMY T-NUT	15FA3501

For additional fasteners and t-nuts, see pages 130-135

# 15CB4860

15 SERIES  
2 HOLE INSIDE GUSSET CORNER BRACKET

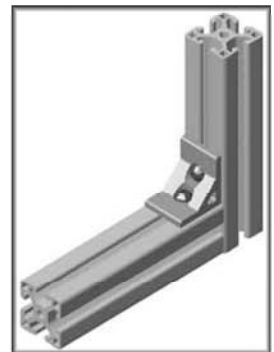
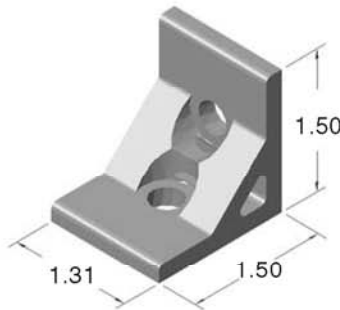

Part Wt: .115 lbs

**Strongest of all corner brackets!**

RECOMMENDED HARDWARE

QTY	DESCRIPTION	PART #
2	5/16-18 x 5/8 BHSCS	13FA3322
2	5/16-18 ECONOMY T-NUT	15FA3501

For additional fasteners and t-nuts, see pages 130-135

# 15CB4841

15 SERIES  
4 HOLE INSIDE GUSSET CORNER BRACKET

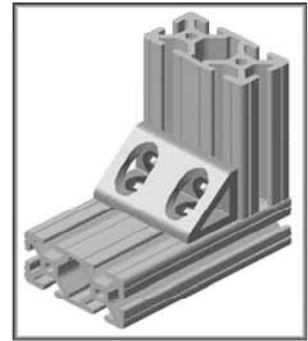
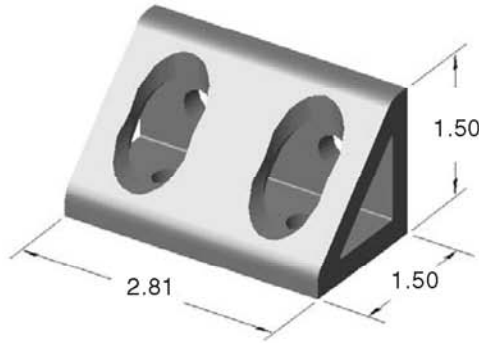

Part Wt: .245 lbs

RECOMMENDED HARDWARE

QTY	DESCRIPTION	PART #
4	5/16-18 x 5/8 FBHSCS	13FA3331
4	5/16-18 ECONOMY T-NUT	15FA3501

For additional fasteners and t-nuts, see pages 130-135

**Strongest of all corner brackets!**

Brackets

# 15CB4861

15 SERIES  
4 HOLE INSIDE GUSSET CORNER BRACKET

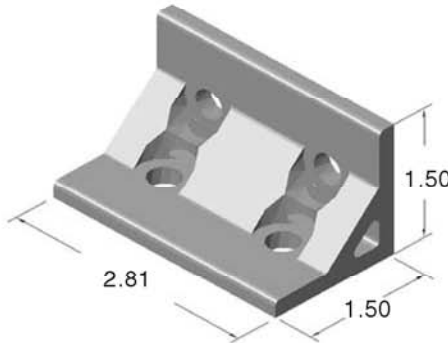

Part Wt: .245 lbs

RECOMMENDED HARDWARE

QTY	DESCRIPTION	PART #
4	5/16-18 x 5/8 BHSCS	13FA3322
4	5/16-18 ECONOMY T-NUT	15FA3501

For additional fasteners and t-nuts, see pages 130-135



**Strongest of all corner brackets!**



**ACCESS HOLE MACHINE**

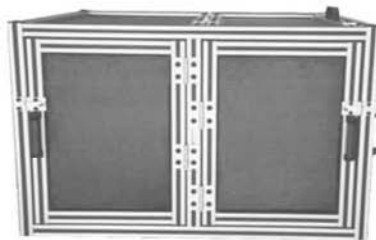

**SOUND ENCLOSURES**



**MACHINE BASES**



**MACHINE ENCLOSURE**



**PALLET HORSES**

### 15CB4842

15 SERIES  
4 HOLE INSIDE GUSSET CORNER BRACKET



FOR FAST ASSEMBLY  
USE 15FA3502

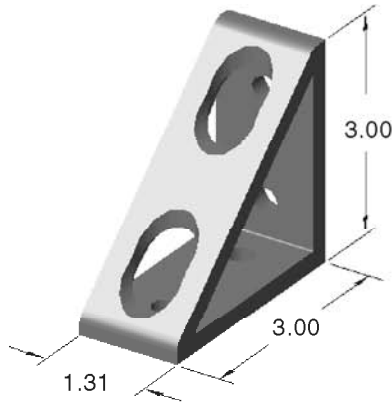

Part Wt: .250 lbs

**Strongest of all  
corner brackets!**

RECOMMENDED HARDWARE

QTY	DESCRIPTION	PART #
4	5/16-18 x 5/8 FBHSCS	13FA3331
4	5/16-18 ECONOMY T-NUT	15FA3501

For additional fasteners and t-nuts, see pages 130-135

### 15CB4862

15 SERIES  
4 HOLE INSIDE GUSSET CORNER BRACKET



FOR FAST ASSEMBLY  
USE 15FA3502

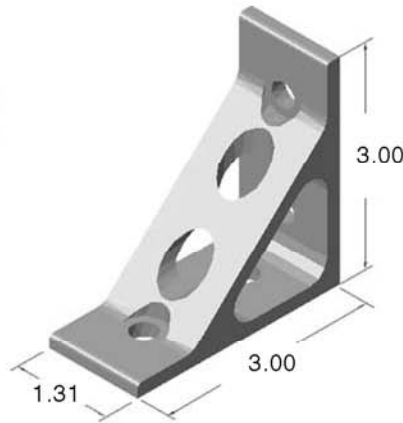

Part Wt: .250 lbs

**Strongest of all  
corner brackets!**

RECOMMENDED HARDWARE

QTY	DESCRIPTION	PART #
4	5/16-18 x 5/8 BHSCS	13FA3322
4	5/16-18 ECONOMY T-NUT	15FA3501

For additional fasteners and t-nuts, see pages 130-135

### 15CB4856

15 SERIES  
4 HOLE INSIDE GUSSET CORNER BRACKET



FOR FAST ASSEMBLY  
USE 15FA3502

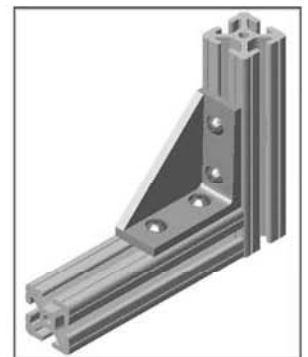
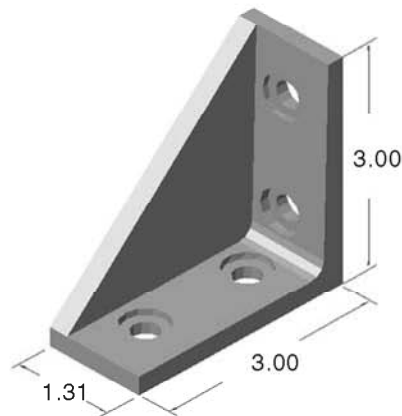

Part Wt: .31 lbs

**Strongest of all  
corner brackets!**

RECOMMENDED HARDWARE

QTY	DESCRIPTION	PART #
4	5/16-18 x 5/8 BHSCS	13FA3322
4	5/16-18 ECONOMY T-NUT	15FA3501

For additional fasteners and t-nuts, see pages 130-135

### 15CB4843

15 SERIES  
8 HOLE INSIDE GUSSET CORNER BRACKET

FOR FAST ASSEMBLY  
USE 15FA3502



RECOMMENDED HARDWARE

QTY	DESCRIPTION	PART #
8	5/16-18 x 5/8 FBHSCS	13FA3331
8	5/16-18 ECONOMY T-NUT	15FA3501

For additional fasteners and t-nuts, see pages 130-135

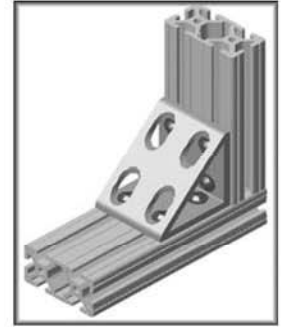
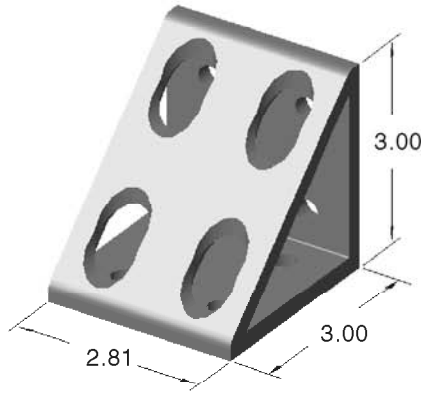

Part Wt: .540 lbs

**Strongest of all  
corner brackets!**

Brackets

### 15CB4863

15 SERIES  
8 HOLE INSIDE GUSSET CORNER BRACKET

FOR FAST ASSEMBLY  
USE 15FA3502



RECOMMENDED HARDWARE

QTY	DESCRIPTION	PART #
8	5/16-18 x 5/8 BHSCS	13FA3322
8	5/16-18 ECONOMY T-NUT	15FA3501

For additional fasteners and t-nuts, see pages 130-135

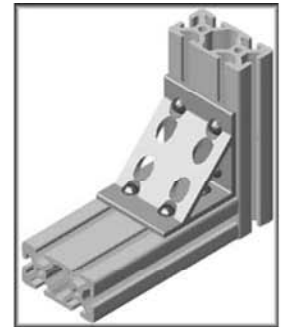
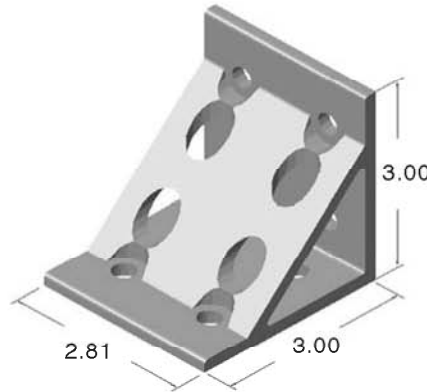

Part Wt: .540 lbs

**Strongest of all  
corner brackets!**

### 15CB4844

15 SERIES  
16 HOLE INSIDE GUSSET CORNER BRACKET

FOR FAST ASSEMBLY  
USE 15FA3502



RECOMMENDED HARDWARE

QTY	DESCRIPTION	PART #
16	5/16-18 x 5/8 FBHSCS	13FA3331
16	5/16-18 ECONOMY T-NUT	15FA3501

For additional fasteners and t-nuts, see pages 130-135

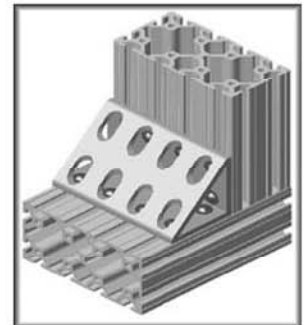
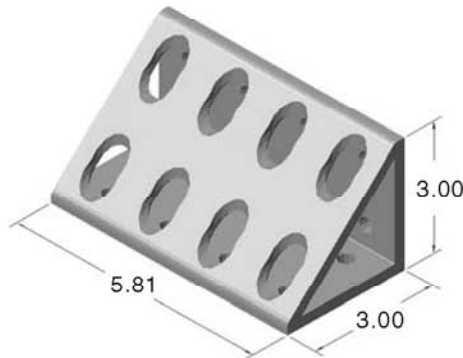

Part Wt: 1.160 lbs

**Strongest of all  
corner brackets!**

# 15CB4846

15 SERIES  
SQUARE TRI - CORNER BRACKET

Drill thru & C-bore for  
5/16 LHSCS

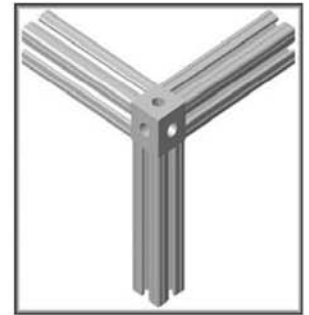
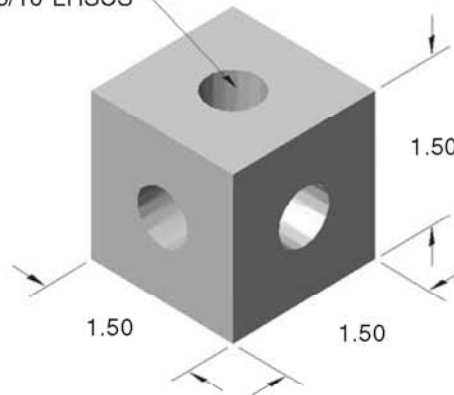

Part Wt: .270 lbs

RECOMMENDED HARDWARE

QTY	DESCRIPTION	PART #
3	5/16-18 x 1 1/4 LHSCS	13FA3710

For additional fasteners and t-nuts, see pages 130-135

• Tapping service for 15EX1515, 15EX1515L, 15EX1515UL on page 161

# 15CB4850

15 SERIES  
QUARTER ROUND TRI - CORNER BRACKET

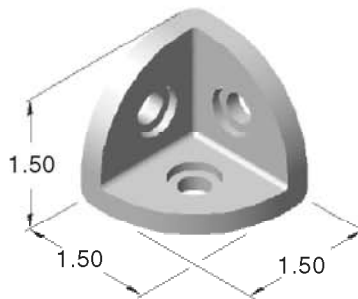

Part Wt: .110 lbs

RECOMMENDED HARDWARE

QTY	DESCRIPTION	PART #
3	5/16-18 x 1 1/4 LHSCS	13FA3710

For additional fasteners and t-nuts, see pages 130-135

• Tapping service for 15EX1517L on page 161

# 15CB4865

15 SERIES  
45° SUPPORT BLOCK

**HARDWARE  
INCLUDED!**

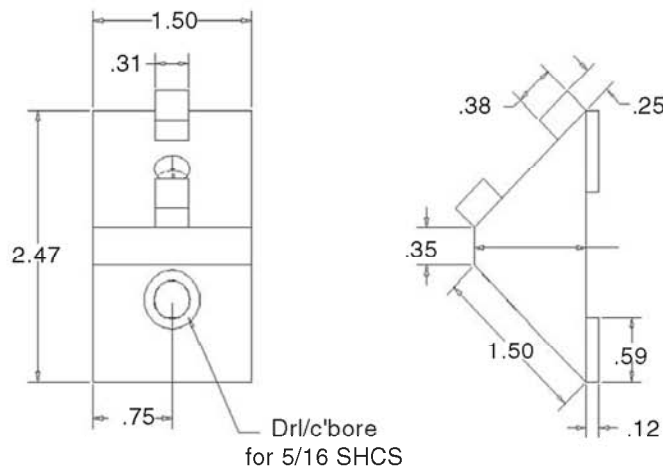

Part Wt: .110 lbs

- For extra corner support
- Eliminate machining service of extrusion
- Made of black delrin
- Expand support length beyond 72"





# 15CB4866

15 SERIES  
45° SUPPORT BLOCK

**HARDWARE  
INCLUDED!**

- *For extra corner support*
- *Eliminate machining service of extrusion*
- *Made of black delrin*
- *Expand support length beyond 72"*

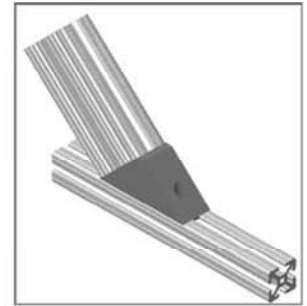
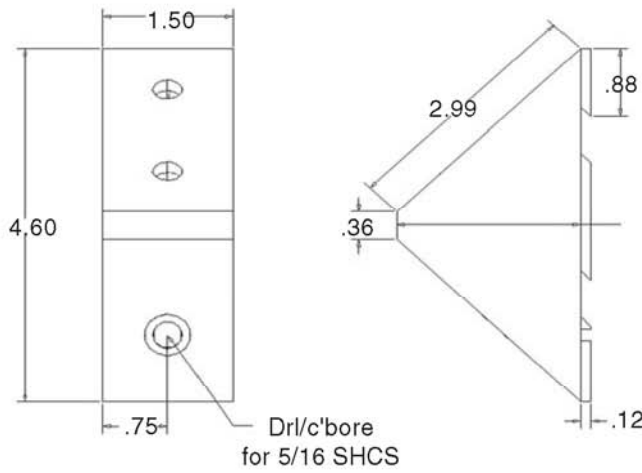

Part Wt: .110 lbs



Brackets



MACHINE GUARD



PERIMETER GUARD



HEAVY DUTY CART

PNEUMATIC TEST STAND

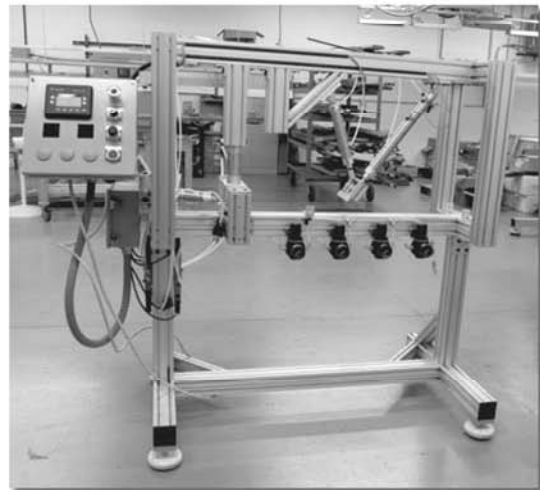

**15JP4500**  
15 SERIES  
4 HOLE 75 JOINING PLATE

FOR FAST ASSEMBLY  
USE 15FA3502

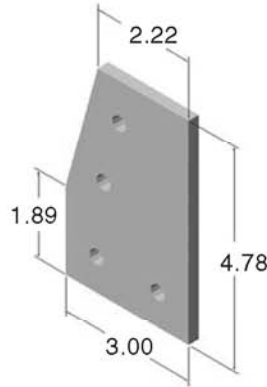

Part Wt: .290 lbs

RECOMMENDED HARDWARE

QTY	DESCRIPTION	PART #
4	5/16-18 x 5/8 FBHSCS	13FA3331
4	5/16-18 ECONOMY T-NUT	15FA3501

For additional fasteners and t-nuts, see pages 130-135

**15JP4501**  
15 SERIES  
2 HOLE JOINING STRIP

FOR FAST ASSEMBLY  
USE 15FA3502

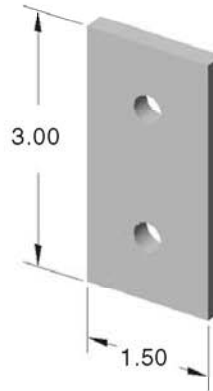

Part Wt: .105 lbs

RECOMMENDED HARDWARE

QTY	DESCRIPTION	PART #
2	5/16-18 x 5/8 FBHSCS	13FA3331
2	5/16-18 ECONOMY T-NUT	15FA3501

For additional fasteners and t-nuts, see pages 130-135

**15JP4502**  
15 SERIES  
3 HOLE JOINING STRIP

FOR FASTER ASSEMBLY  
USE 15FA3520

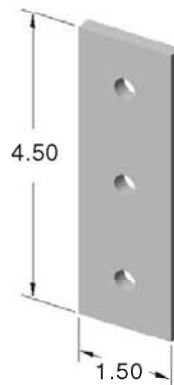

Part Wt: .155 lbs

RECOMMENDED HARDWARE

QTY	DESCRIPTION	PART #
3	5/16-18 x 5/8 FBHSCS	13FA3331
3	5/16-18 ECONOMY T-NUT	15FA3501

For additional fasteners and t-nuts, see pages 130-135

### 15JP4503

15 SERIES  
4 HOLE JOINING STRIP



OR

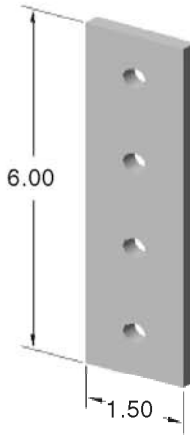

Part Wt: .205 lbs

RECOMMENDED HARDWARE

QTY	DESCRIPTION	PART #
4	5/16-18 x 5/8 FBHSCS	13FA3331
4	5/16-18 ECONOMY T-NUT	15FA3501

For additional fasteners and t-nuts, see pages 130-135

### 15JP4504

15 SERIES  
4 HOLE JOINING PLATE

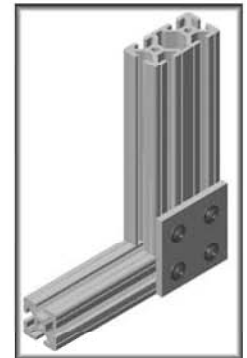
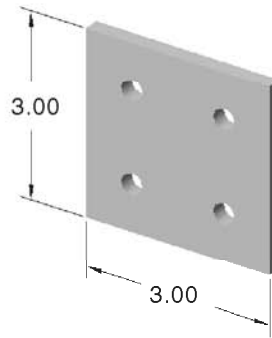

Part Wt: .210 lbs

RECOMMENDED HARDWARE

QTY	DESCRIPTION	PART #
4	5/16-18 x 5/8 FBHSCS	13FA3331
4	5/16-18 ECONOMY T-NUT	15FA3501

For additional fasteners and t-nuts, see pages 130-135

### 15JP4505

15 SERIES  
4 HOLE 90° JOINING PLATE



OR

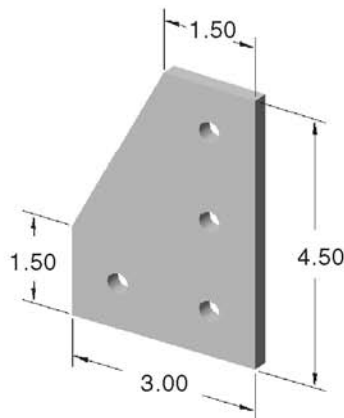

Part Wt: .265 lbs

RECOMMENDED HARDWARE

QTY	DESCRIPTION	PART #
4	5/16-18 x 5/8 FBHSCS	13FA3331
4	5/16-18 ECONOMY T-NUT	15FA3501

For additional fasteners and t-nuts, see pages 130-135

Brackets

### 15JP4506

15 SERIES  
5 HOLE TEE JOINING PLATE

FOR FAST ASSEMBLY  
USE 15FA3502



OR

FOR FASTER ASSEMBLY  
USE 15FA3520

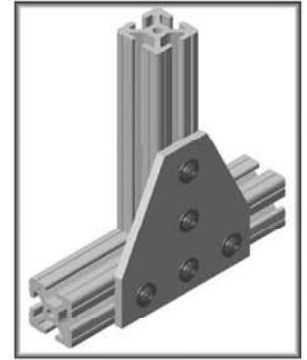
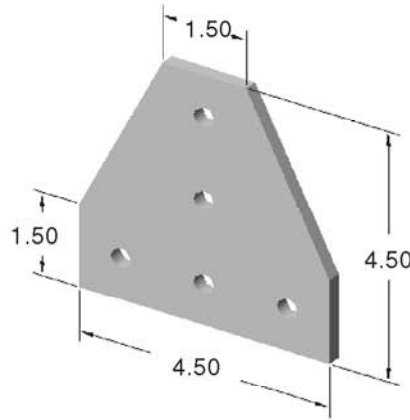
Part Wt: .370 lbs

RECOMMENDED HARDWARE

QTY	DESCRIPTION	PART #
5	5/16-18 x 5/8 FBHSCS	13FA3331
5	5/16-18 ECONOMY T-NUT	15FA3501

For additional fasteners and t-nuts, see pages 130-135

### 15JP4507

15 SERIES  
5 HOLE 90° JOINING PLATE



OR

FOR FASTER ASSEMBLY  
USE 15FA3520

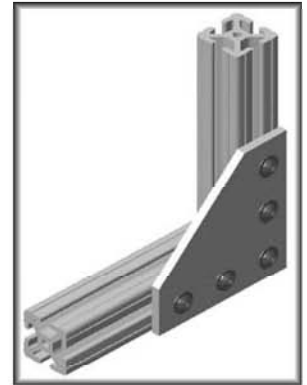
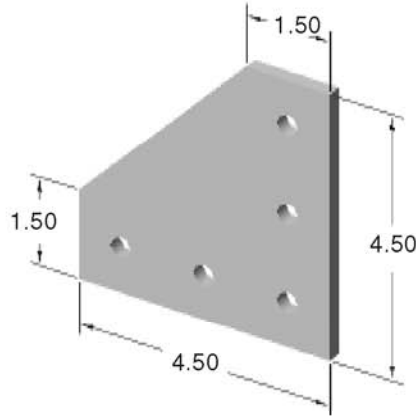
Part Wt: .375 lbs

RECOMMENDED HARDWARE

QTY	DESCRIPTION	PART #
5	5/16-18 x 5/8 FBHSCS	13FA3331
5	5/16-18 ECONOMY T-NUT	15FA3501

For additional fasteners and t-nuts, see pages 130-135

### 15JP4508

15 SERIES  
7 HOLE 90° JOINING PLATE



OR

FOR FASTER ASSEMBLY  
USE 15FA3520

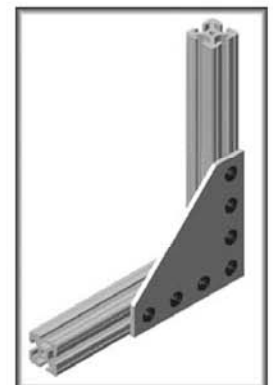
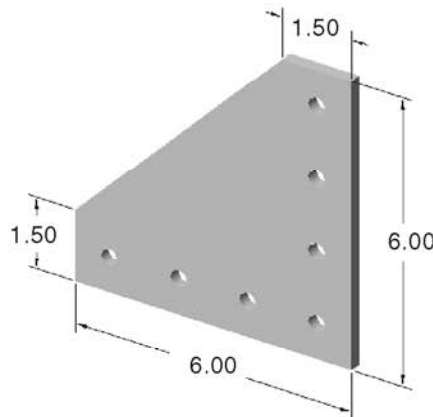
Part Wt: .605 lbs

RECOMMENDED HARDWARE

QTY	DESCRIPTION	PART #
7	5/16-18 x 5/8 FBHSCS	13FA3331
7	5/16-18 ECONOMY T-NUT	15FA3501

For additional fasteners and t-nuts, see pages 130-135

**15JP4509**  
15 SERIES  
8 HOLE JOINING PLATE

FOR FAST ASSEMBLY  
USE 15FA3502



OR

FOR FASTER ASSEMBLY  
USE 15FA3520

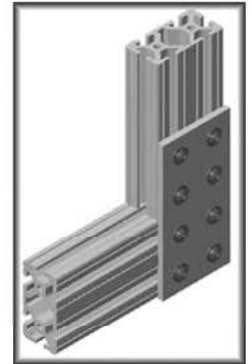
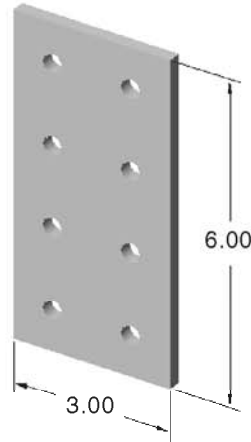

Part Wt: .415 lbs

RECOMMENDED HARDWARE

QTY	DESCRIPTION	PART #
8	5/16-18 x 5/8 FBHSCS	13FA3331
8	5/16-18 ECONOMY T-NUT	15FA3501

For additional fasteners and t-nuts, see pages 130-135

**15JP4510**

15 SERIES  
12 HOLE 90° JOINING PLATE

FOR FAST ASSEMBLY  
USE 15FA3502



OR

FOR FASTER ASSEMBLY  
USE 15FA3520

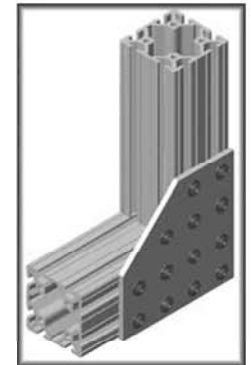
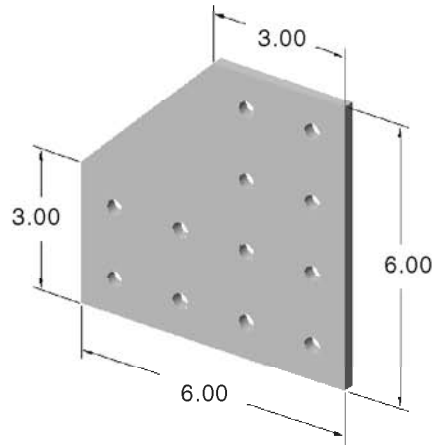

Part Wt: .735 lbs

RECOMMENDED HARDWARE

QTY	DESCRIPTION	PART #
12	5/16-18 x 5/8 FBHSCS	13FA3331
12	5/16-18 ECONOMY T-NUT	15FA3501

For additional fasteners and t-nuts, see pages 130-135

**15JP4511**

15 SERIES  
16 HOLE CROSS JOINING PLATE

FOR FAST ASSEMBLY  
USE 15FA3502



OR

FOR FASTER ASSEMBLY  
USE 15FA3520

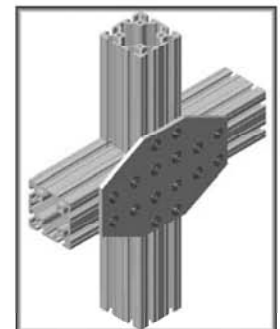
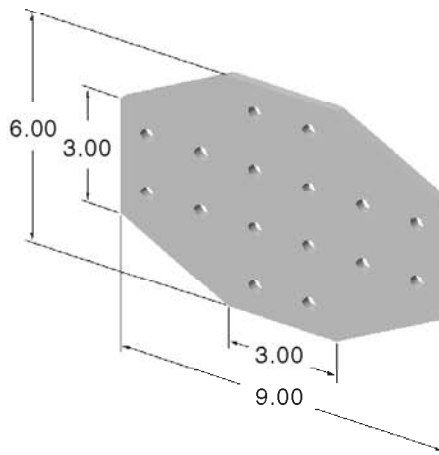

Part Wt: 1.065 lbs

RECOMMENDED HARDWARE

QTY	DESCRIPTION	PART #
16	5/16-18 x 5/8 FBHSCS	13FA3331
16	5/16-18 ECONOMY T-NUT	15FA3501

For additional fasteners and t-nuts, see pages 130-135

# 15JP4512

15 SERIES  
6 HOLE TEE JOINING PLATE



OR

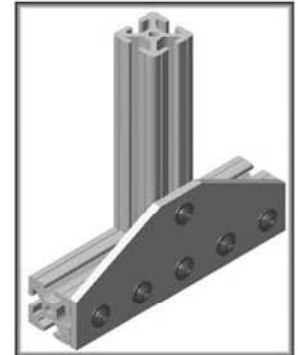
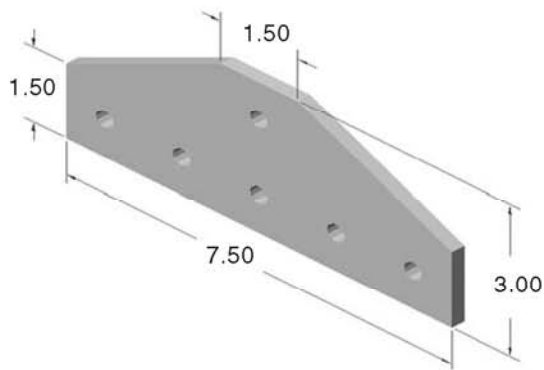

Part Wt: .415 lbs

RECOMMENDED HARDWARE

QTY	DESCRIPTION	PART #
6	5/16-18 x 5/8 FBHSCS	13FA3331
6	5/16-18 ECONOMY T-NUT	15FA3501

For additional fasteners and t-nuts, see pages 130-135

# 15JP4513

15 SERIES  
32 HOLE JOINING PLATE



OR

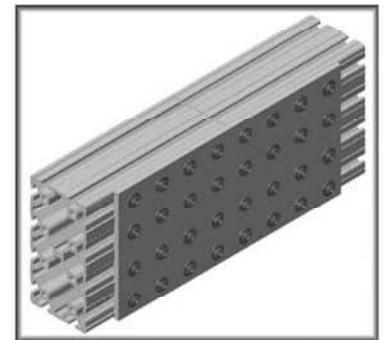
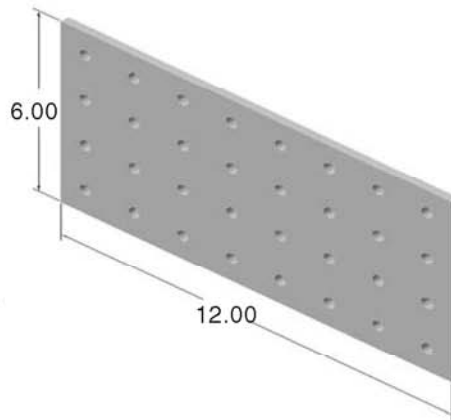

Part Wt: 1.650 lbs

RECOMMENDED HARDWARE

QTY	DESCRIPTION	PART #
32	5/16-18 x 5/8 FBHSCS	13FA3331
32	5/16-18 ECONOMY T-NUT	15FA3501

For additional fasteners and t-nuts, see pages 130-135

# 15JP4514

15 SERIES  
20 HOLE 90° JOINING PLATE



OR

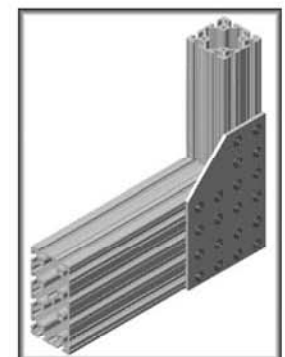
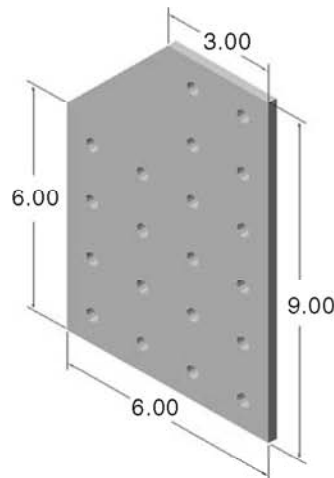

Part Wt: 1.140 lbs

RECOMMENDED HARDWARE

QTY	DESCRIPTION	PART #
20	5/16-18 x 5/8 FBHSCS	13FA3331
20	5/16-18 ECONOMY T-NUT	15FA3501

For additional fasteners and t-nuts, see pages 130-135

# 15JP4515

15 SERIES  
20 HOLE TEE JOINING PLATE

FOR FAST ASSEMBLY  
USE 15FA3502



OR

FOR FASTER ASSEMBLY  
USE 15FA3520



RECOMMENDED HARDWARE

QTY	DESCRIPTION	PART #
20	5/16-18 x 5/8 FBHSCS	13FA3331
20	5/16-18 ECONOMY T-NUT	15FA3501

For additional fasteners and t-nuts, see pages 130-135

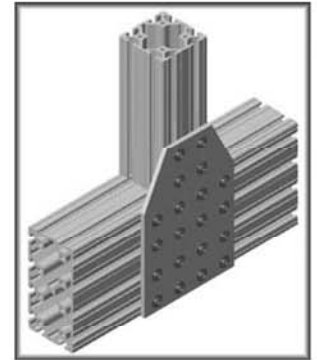
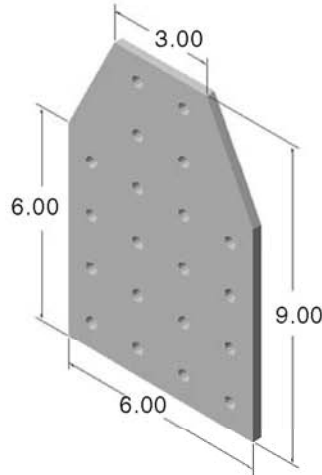

Part Wt: 1.175 lbs

Brackets

# 15JP4516

15 SERIES  
7 HOLE TEE JOINING PLATE

FOR FAST ASSEMBLY  
USE 15FA3502



OR

FOR FASTER ASSEMBLY  
USE 15FA3520



RECOMMENDED HARDWARE

QTY	DESCRIPTION	PART #
7	5/16-18 x 5/8 FBHSCS	13FA3331
7	5/16-18 ECONOMY T-NUT	15FA3501

For additional fasteners and t-nuts, see pages 130-135

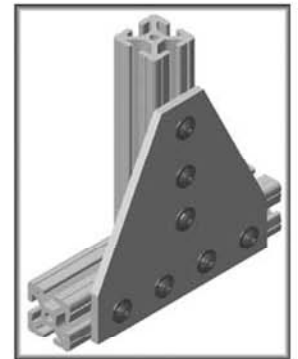
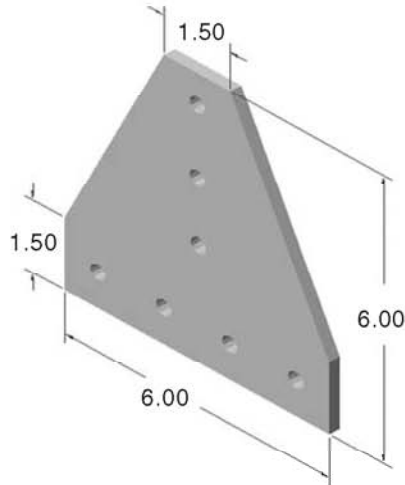

Part Wt: .615 lbs

# 15JP4517

15 SERIES  
6 HOLE 15° JOINING PLATE

FOR FAST ASSEMBLY  
USE 15FA3502



RECOMMENDED HARDWARE

QTY	DESCRIPTION	PART #
6	5/16-18 x 5/8 FBHSCS	13FA3331
6	5/16-18 ECONOMY T-NUT	15FA3501

For additional fasteners and t-nuts, see pages 130-135

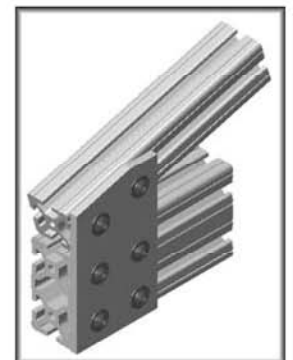
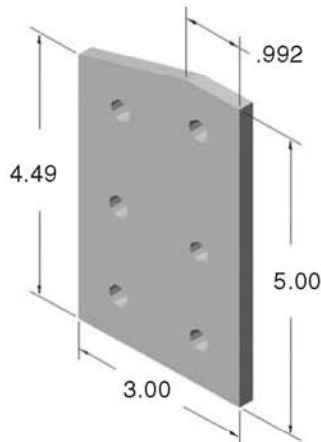

Part Wt: .335 lbs

# 15JP4518

15 SERIES  
4 HOLE 15° JOINING PLATE



FOR FAST ASSEMBLY  
USE 15FA3502

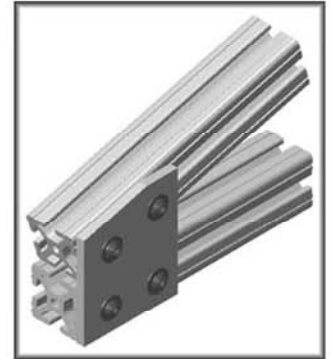
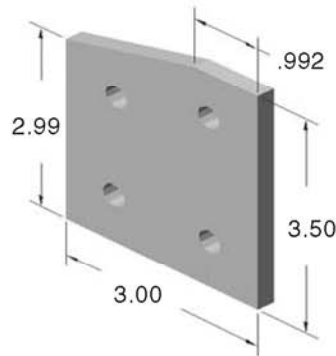

Part Wt: .230 lbs

RECOMMENDED HARDWARE

QTY	DESCRIPTION	PART #
4	5/16-18 x 5/8 FBHSCS	13FA3331
4	5/16-18 ECONOMY T-NUT	15FA3501

For additional fasteners and t-nuts, see pages 130-135

# 15JP4519

15 SERIES  
6 HOLE 90° JOINING PLATE



FOR FAST ASSEMBLY  
USE 15FA3502

OR



FOR FASTER ASSEMBLY  
USE 15FA3520

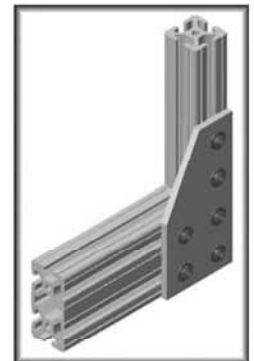
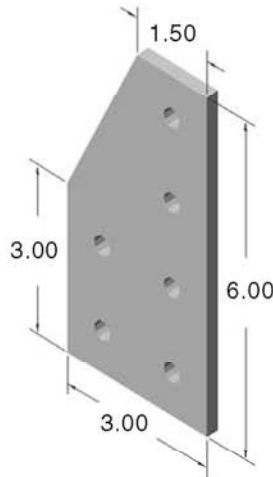

Part Wt: .370 lbs

RECOMMENDED HARDWARE

QTY	DESCRIPTION	PART #
6	5/16-18 x 5/8 FBHSCS	13FA3331
6	5/16-18 ECONOMY T-NUT	15FA3501

For additional fasteners and t-nuts, see pages 130-135

# 15JP4520

15 SERIES  
12 HOLE TEE JOINING PLATE



FOR FAST ASSEMBLY  
USE 15FA3502

OR



FOR FASTER ASSEMBLY  
USE 15FA3520

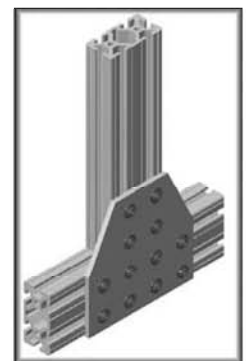
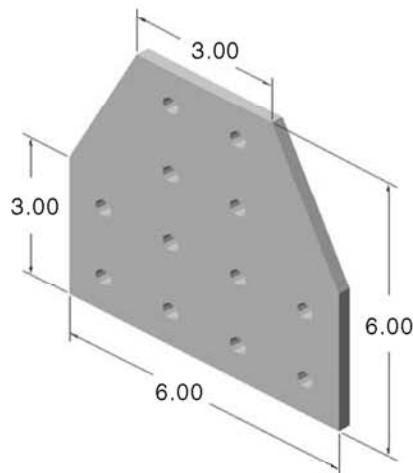

Part Wt: .730 lbs

RECOMMENDED HARDWARE

QTY	DESCRIPTION	PART #
12	5/16-18 x 5/8 FBHSCS	13FA3331
12	5/16-18 ECONOMY T-NUT	15FA3501

For additional fasteners and t-nuts, see pages 130-135



### 15JP4521

15 SERIES  
9 HOLE 90° JOINING PLATE

FOR FAST ASSEMBLY  
USE 15FA3502



OR

FOR FASTER ASSEMBLY  
USE 15FA3520

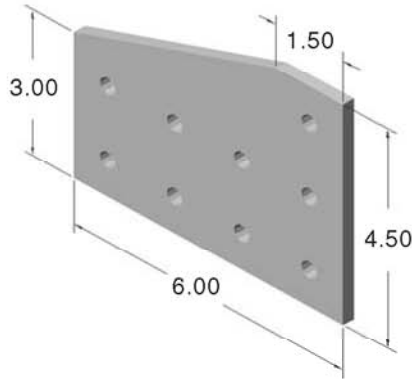
Part Wt: .545 lbs

RECOMMENDED HARDWARE

QTY	DESCRIPTION	PART #
9	5/16-18 x 5/8 FBHSCS	13FA3331
9	5/16-18 ECONOMY T-NUT	15FA3501

For additional fasteners and t-nuts, see pages 130-135

Brackets

### 15JP4522

15 SERIES  
10 HOLE 90° JOINING PLATE

FOR FAST ASSEMBLY  
USE 15FA3502



OR

FOR FASTER ASSEMBLY  
USE 15FA3520

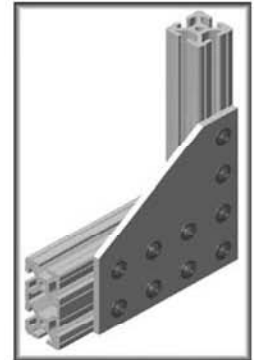
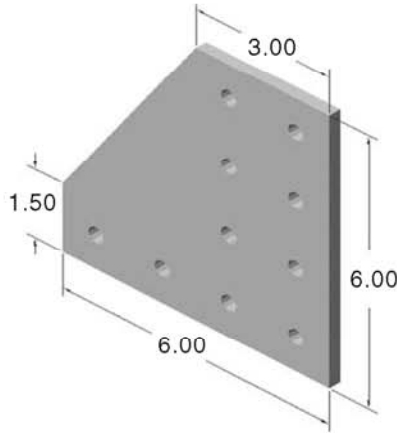
Part Wt: .690 lbs

RECOMMENDED HARDWARE

QTY	DESCRIPTION	PART #
10	5/16-18 x 5/8 FBHSCS	13FA3331
10	5/16-18 ECONOMY T-NUT	15FA3501

For additional fasteners and t-nuts, see pages 130-135

### 15JP4523

15 SERIES  
7 HOLE 90° JOINING PLATE

FOR FAST ASSEMBLY  
USE 15FA3502



OR

FOR FASTER ASSEMBLY  
USE 15FA3520

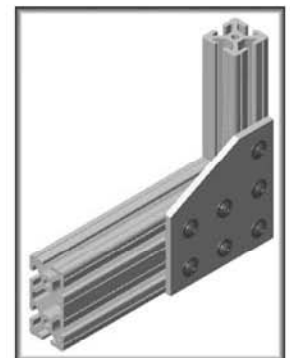
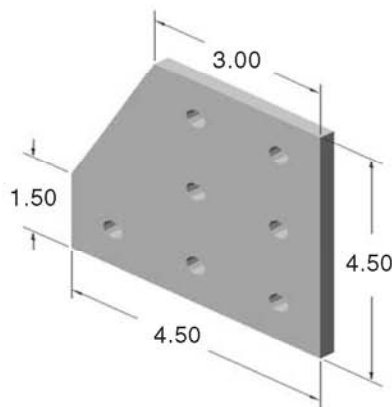
Part Wt: .415 lbs

RECOMMENDED HARDWARE

QTY	DESCRIPTION	PART #
7	5/16-18 x 5/8 FBHSCS	13FA3331
7	5/16-18 ECONOMY T-NUT	15FA3501

For additional fasteners and t-nuts, see pages 130-135

# 15JP4524

15 SERIES  
6 HOLE 30° JOINING PLATE



FOR FAST ASSEMBLY  
USE 15FA3502

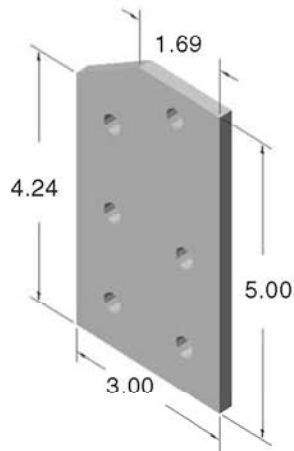

Part Wt: .335 lbs

RECOMMENDED HARDWARE

QTY	DESCRIPTION	PART #
6	5/16-18 x 5/8 FBHSCS	13FA3331
6	5/16-18 ECONOMY T-NUT	15FA3501

For additional fasteners and t-nuts, see pages 130-135

# 15JP4525

15 SERIES  
4 HOLE 30° JOINING PLATE



FOR FAST ASSEMBLY  
USE 15FA3502

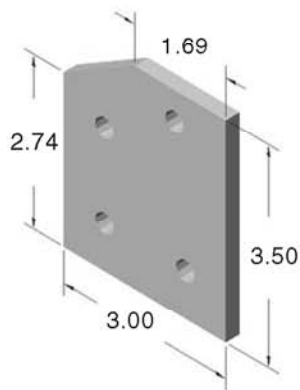

Part Wt: .230 lbs

RECOMMENDED HARDWARE

QTY	DESCRIPTION	PART #
4	5/16-18 x 5/8 FBHSCS	13FA3331
4	5/16-18 ECONOMY T-NUT	15FA3501

For additional fasteners and t-nuts, see pages 130-135

# 15JP4526

15 SERIES  
7 HOLE CROSS JOINING PLATE



FOR FAST ASSEMBLY  
USE 15FA3502

OR



FOR FASTER ASSEMBLY  
USE 15FA3520

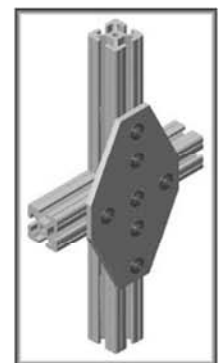
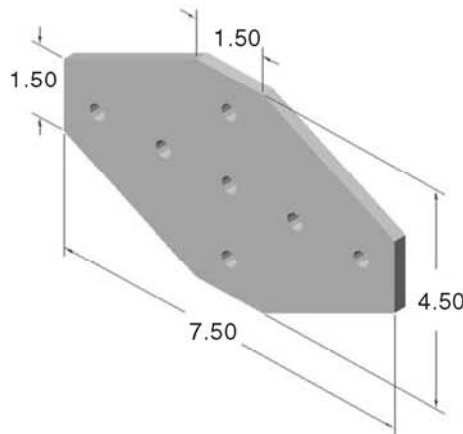

Part Wt: .580 lbs

RECOMMENDED HARDWARE

QTY	DESCRIPTION	PART #
7	5/16-18 x 5/8 FBHSCS	13FA3331
7	5/16-18 ECONOMY T-NUT	15FA3501

For additional fasteners and t-nuts, see pages 130-135

### 15JP4527

15 SERIES  
4 HOLE TEE JOINING PLATE



FOR FAST ASSEMBLY  
USE 15FA3502

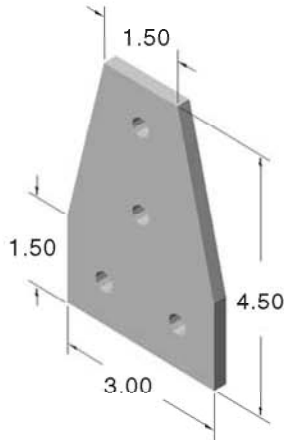

Part Wt: .260 lbs

RECOMMENDED HARDWARE

QTY	DESCRIPTION	PART #
4	5/16-18 x 5/8 FBHSCS	13FA3331
4	5/16-18 ECONOMY T-NUT	15FA3501

For additional fasteners and t-nuts, see pages 130-135

Brackets

### 15JP4528

15 SERIES  
6 HOLE 45° JOINING PLATE



FOR FAST ASSEMBLY  
USE 15FA3502

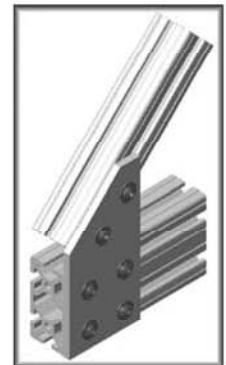
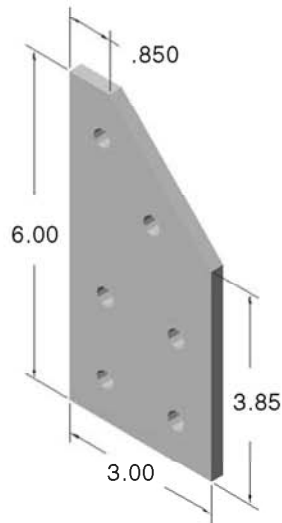

Part Wt: .365 lbs

RECOMMENDED HARDWARE

QTY	DESCRIPTION	PART #
6	5/16-18 x 5/8 FBHSCS	13FA3331
6	5/16-18 ECONOMY T-NUT	15FA3501

For additional fasteners and t-nuts, see pages 130-135

### 15JP4529

15 SERIES  
4 HOLE 45° JOINING PLATE



FOR FAST ASSEMBLY  
USE 15FA3502

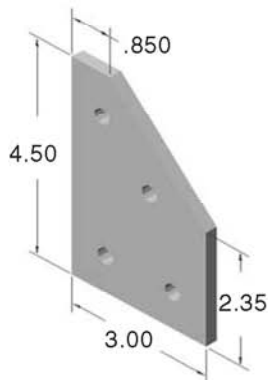

Part Wt: .260 lbs

RECOMMENDED HARDWARE

QTY	DESCRIPTION	PART #
4	5/16-18 x 5/8 FBHSCS	13FA3331
4	5/16-18 ECONOMY T-NUT	15FA3501

For additional fasteners and t-nuts, see pages 130-135

# 15JP4530

15 SERIES  
8 HOLE TEE JOINING PLATE



OR

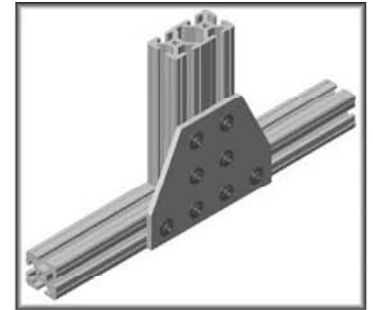
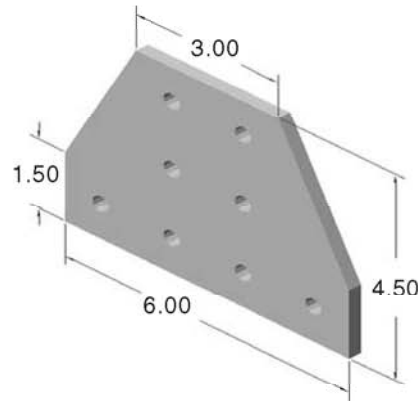

Part Wt: .525 lbs

RECOMMENDED HARDWARE

QTY	DESCRIPTION	PART #
8	5/16-18 x 5/8 FBHSCS	13FA3331
8	5/16-18 ECONOMY T-NUT	15FA3501

For additional fasteners and t-nuts, see pages 58, 63 - 64

# 15JP4531

15 SERIES  
12 HOLE CROSS JOINING PLATE



OR

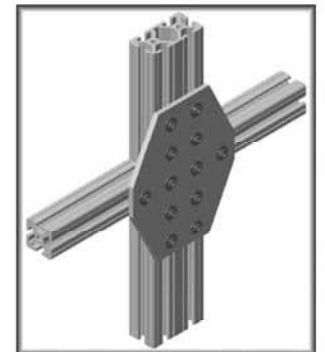
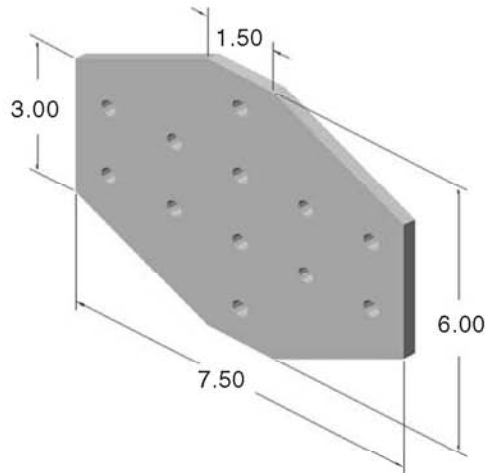

Part Wt: .850 lbs

RECOMMENDED HARDWARE

QTY	DESCRIPTION	PART #
12	5/16-18 x 5/8 FBHSCS	13FA3331
12	5/16-18 ECONOMY T-NUT	15FA3501

For additional fasteners and t-nuts, see pages 58, 63 - 64

# 15JP4532

15 SERIES  
4 HOLE 60° JOINING PLATE

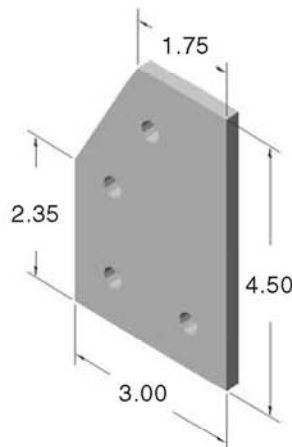

Part Wt: .280 lbs

RECOMMENDED HARDWARE

QTY	DESCRIPTION	PART #
4	5/16-18 x 5/8 FBHSCS	13FA3331
4	5/16-18 ECONOMY T-NUT	15FA3501

For additional fasteners and t-nuts, see pages 58, 63 - 64

### 15JP4533

15 SERIES  
6 HOLE 60° JOINING PLATE



FOR FAST ASSEMBLY  
USE 15FA3502

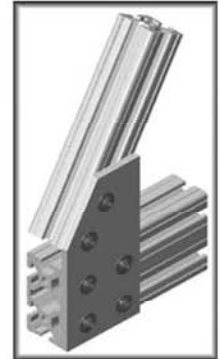
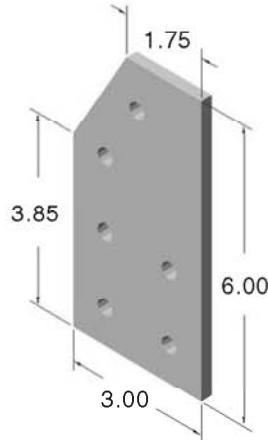

Part Wt: .395 lbs

RECOMMENDED HARDWARE

QTY	DESCRIPTION	PART #
6	5/16-18 x 5/8 FBHSCS	13FA3331
6	5/16-18 ECONOMY T-NUT	15FA3501

For additional fasteners and t-nuts, see pages 130-135

Brackets

### 15JP4534

15 SERIES  
6 HOLE JOINING PLATE



FOR FAST ASSEMBLY  
USE 15FA3502

OR



FOR FASTER ASSEMBLY  
USE 15FA3520

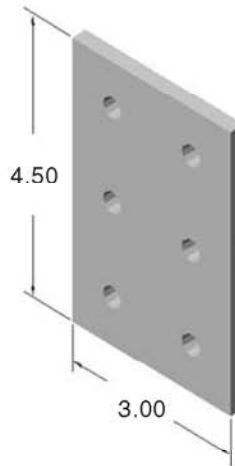

Part Wt: .310 lbs

RECOMMENDED HARDWARE

QTY	DESCRIPTION	PART #
6	5/16-18 x 5/8 FBHSCS	13FA3331
6	5/16-18 ECONOMY T-NUT	15FA3501

For additional fasteners and t-nuts, see pages 130-135

### 15JP4535

15 SERIES  
11 HOLE TEE JOINING PLATE



FOR FAST ASSEMBLY  
USE 15FA3502

OR



FOR FASTER ASSEMBLY  
USE 15FA3520

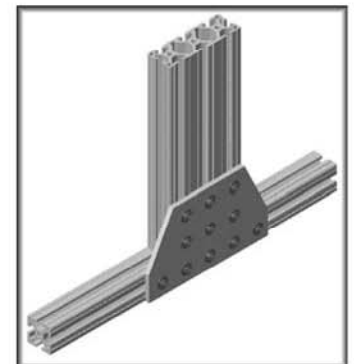
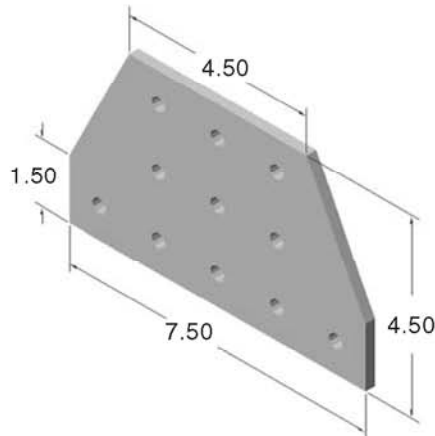

Part Wt: .680 lbs

RECOMMENDED HARDWARE

QTY	DESCRIPTION	PART #
11	5/16-18 x 5/8 FBHSCS	13FA3331
11	5/16-18 ECONOMY T-NUT	15FA3501

For additional fasteners and t-nuts, see pages 130-135

### 15JP4536

15 SERIES  
16 HOLE TEE JOINING PLATE



OR



FOR FASTER ASSEMBLY  
USE 15FA3520

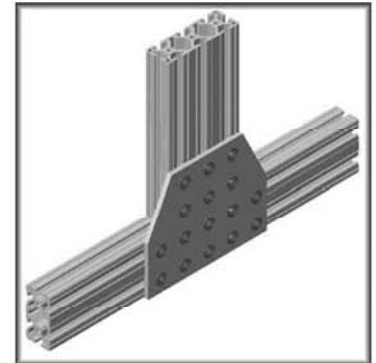
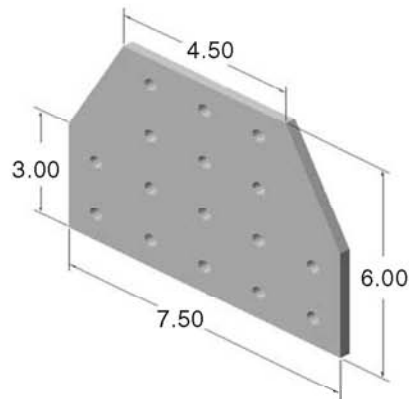

Part Wt: .995 lbs

RECOMMENDED HARDWARE

QTY	DESCRIPTION	PART #
16	5/16-18 x 5/8 FBHSCS	13FA3331
16	5/16-18 ECONOMY T-NUT	15FA3501

For additional fasteners and t-nuts, see pages 130-135

### 15JP4537

15 SERIES  
20 HOLE CROSS JOINING PLATE



FOR FAST ASSEMBLY  
USE 15FA3502

OR



FOR FASTER ASSEMBLY  
USE 15FA3520

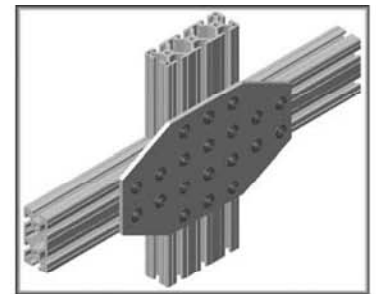
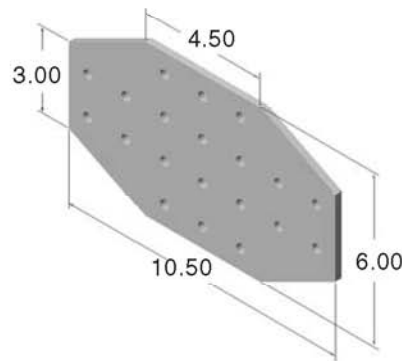

Part Wt: 1.290 lbs

RECOMMENDED HARDWARE

QTY	DESCRIPTION	PART #
20	5/16-18 x 5/8 FBHSCS	13FA3331
20	5/16-18 ECONOMY T-NUT	15FA3501

For additional fasteners and t-nuts, see pages 130-135

### 15JP4538

15 SERIES  
6 HOLE 75° JOINING PLATE



FOR FAST ASSEMBLY  
USE 15FA3502

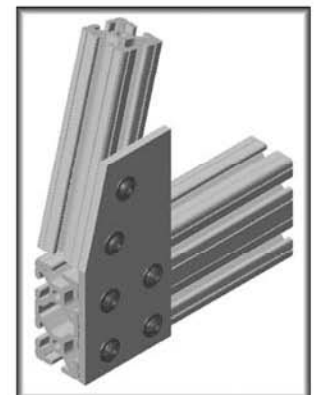
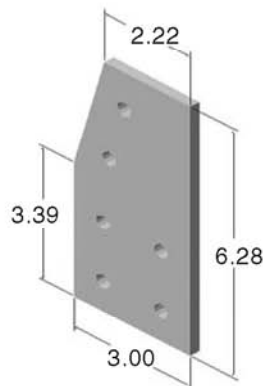

Part Wt: .400 lbs

RECOMMENDED HARDWARE

QTY	DESCRIPTION	PART #
20	5/16-18 x 5/8 FBHSCS	13FA3331
20	5/16-18 ECONOMY T-NUT	15FA3501

For additional fasteners and t-nuts, see pages 130-135

# 15JP4539

15 SERIES  
4 HOLE CONDUIT JOINING PLATE



FOR USE WITH 1/2"  
CONDUIT CONNECTORS

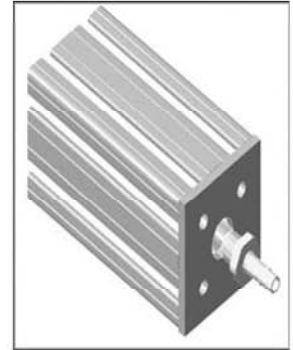
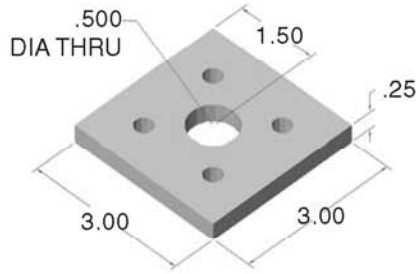

Part Wt: .105 lbs

RECOMMENDED HARDWARE

QTY	DESCRIPTION	PART #
4	5/16-18 x 5/8 BHSCS	13FA3322

For additional fasteners and t-nuts, see pages 130-135

Brackets

# 15JP4540

15 SERIES  
4 HOLE CONDUIT JOINING PLATE



FOR USE WITH 3/4"  
CONDUIT CONNECTORS

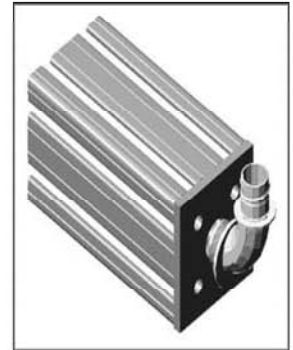
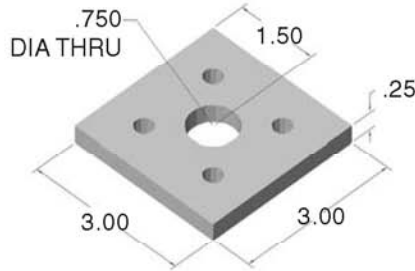

Part Wt: .105 lbs

RECOMMENDED HARDWARE

QTY	DESCRIPTION	PART #
4	5/16-18 x 5/8 BHSCS	13FA3322

For additional fasteners and t-nuts, see pages 130-135

# 15JP4545

15 SERIES  
2 HOLE JOINING PLATE



FOR USE WITH  
15QE1717L

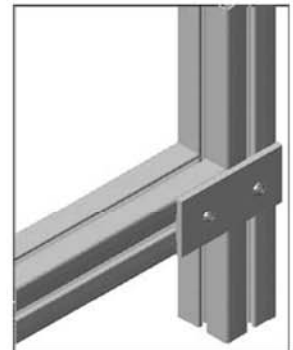
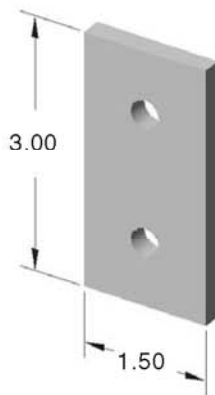

Part Wt: .105 lbs

RECOMMENDED HARDWARE

QTY	DESCRIPTION	PART #
2	5/16-18 x 5/8 BHSCS	13FA3322
2	5/16-18 ECONOMY T-NUT	15FA3501

For additional fasteners and t-nuts, see pages 130-135

**15JP4546**  
15 SERIES  
4 HOLE JOINING PLATE



FOR USE WITH  
15QE1717L

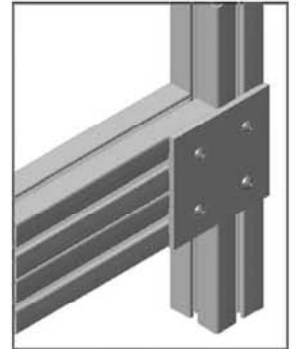
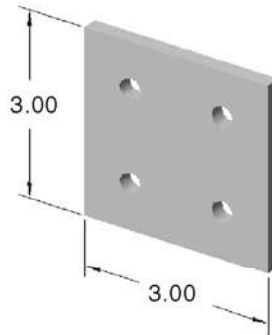

Part Wt: .105 lbs

RECOMMENDED HARDWARE

QTY	DESCRIPTION	PART #
4	5/16-18 x 5/8 BHSCS	13FA3322
4	5/16-18 ECONOMY T-NUT	15FA3501

For additional fasteners and t-nuts, see pages 130-135

**15JP4547**  
15 SERIES  
2 HOLE JOINING PLATE



FOR USE WITH  
15QE2323L

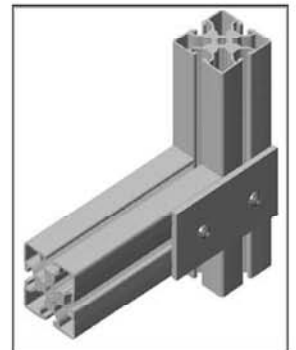
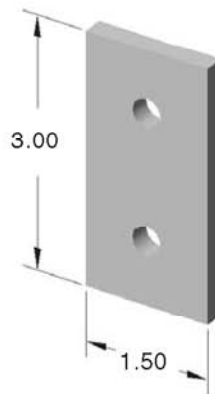

Part Wt: .105 lbs

RECOMMENDED HARDWARE

QTY	DESCRIPTION	PART #
2	5/16-18 x 5/8 BHSCS	13FA3322
2	5/16-18 ECONOMY T-NUT	15FA3501

For additional fasteners and t-nuts, see pages 130-135

**15JP4548**  
15 SERIES  
4 HOLE JOINING PLATE



FOR USE WITH  
15QE2323L

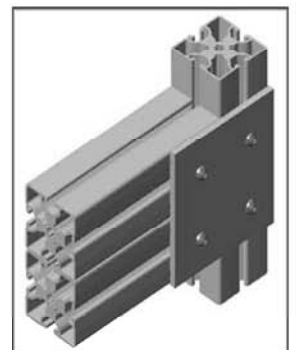
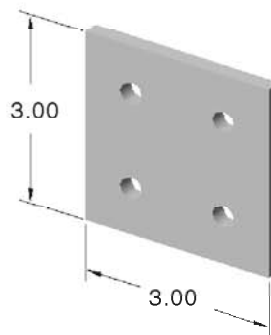

Part Wt: .105 lbs

RECOMMENDED HARDWARE

QTY	DESCRIPTION	PART #
4	5/16-18 x 5/8 BHSCS	13FA3322
4	5/16-18 ECONOMY T-NUT	15FA3501

For additional fasteners and t-nuts, see pages 130-135



# 45° SUPPORTS

## Hardware Included!

- Great For Strong Right Angles
- We Make Custom 45° Supports (See Page 169)

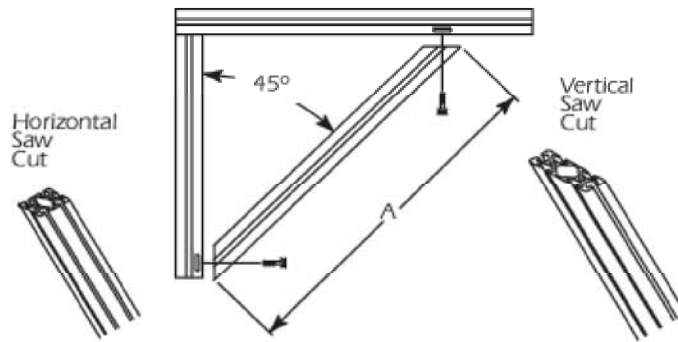
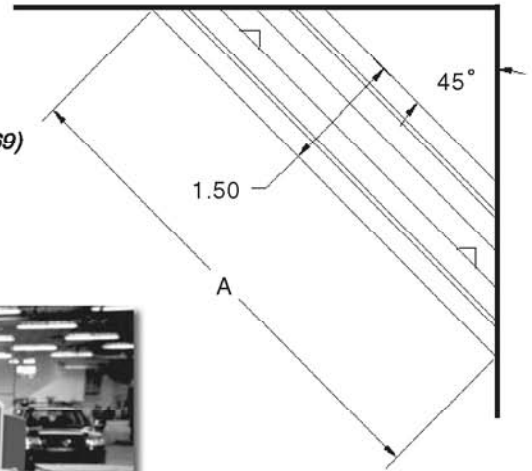

Extrusion	Length A	Mounting Hardware (Included)	Part #
15EX1515	6.00"	(2) 5/16x3/4 SHCS,Washer, & Econo T-nut	15SP1850
15EX1515	12.00"	(2) 5/16x3/4 SHCS,Washer, & Econo T-nut	15SP1851
15EX1515	18.00"	(2) 5/16x3/4 SHCS,Washer, & Econo T-nut	15SP1852
15EX1515	24.00"	(2) 5/16x3/4 SHCS,Washer, & Econo T-nut	15SP1853
15EX1515L	6.00"	(2) 5/16x3/4 SHCS,Washer, & Econo T-nut	15SP1854
15EX1515L	12.00"	(2) 5/16x3/4 SHCS,Washer, & Econo T-nut	15SP1855
15EX1515L	18.00"	(2) 5/16x3/4 SHCS,Washer, & Econo T-nut	15SP1856
15EX1515L	24.00"	(2) 5/16x3/4 SHCS,Washer, & Econo T-nut	15SP1857
15EX1530	6.00"	(4) 5/16x3/4 SHCS,Washer, & Econo T-nut	15SP1860
15EX1530	12.00"	(4) 5/16x3/4 SHCS,Washer, & Econo T-nut	15SP1861
15EX1530	18.00"	(4) 5/16x3/4 SHCS,Washer, & Econo T-nut	15SP1862
15EX1530	24.00"	(4) 5/16x3/4 SHCS,Washer, & Econo T-nut	15SP1863
15EX1530L	6.00"	(4) 5/16x3/4 SHCS,Washer, & Econo T-nut	15SP1865
15EX1530L	12.00"	(4) 5/16x3/4 SHCS,Washer, & Econo T-nut	15SP1866
15EX1530L	18.00"	(4) 5/16x3/4 SHCS,Washer, & Econo T-nut	15SP1867
15EX1530L	24.00"	(4) 5/16x3/4 SHCS,Washer, & Econo T-nut	15SP1868

# 45° SUPPORTS

## Hardware Included!

- Great For Strong Right Angles
- We Make Custom 45° Supports (See Page 169)

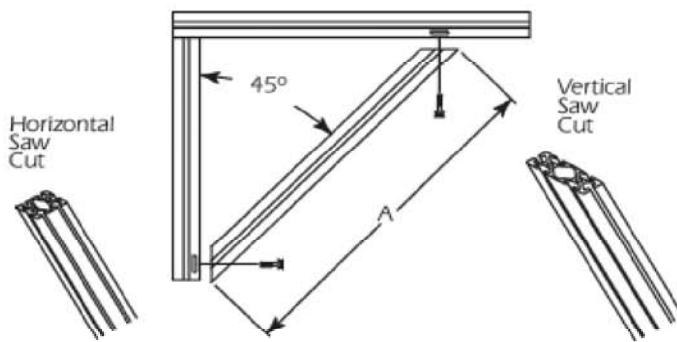
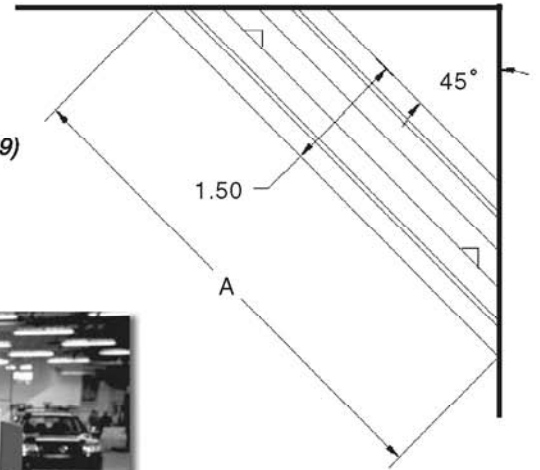

Extrusion	Length A	Mounting Hardware (Included)	Part #
15QE1515	6.00"	(2) 5/16x3/4 SHCS, Washer, & Econo T-nut	15SP1870
15QE1515	12.00"	(2) 5/16x3/4 SHCS, Washer, & Econo T-nut	15SP1871
15QE1515	18.00"	(2) 5/16x3/4 SHCS, Washer, & Econo T-nut	15SP1872
15QE1515	24.00"	(2) 5/16x3/4 SHCS, Washer, & Econo T-nut	15SP1873
15QE1515L	6.00"	(2) 5/16x3/4 SHCS, Washer, & Econo T-nut	15SP1874
15QE1515L	12.00"	(2) 5/16x3/4 SHCS, Washer, & Econo T-nut	15SP1875
15QE1515L	18.00"	(2) 5/16x3/4 SHCS, Washer, & Econo T-nut	15SP1876
15QE1515L	24.00"	(2) 5/16x3/4 SHCS, Washer, & Econo T-nut	15SP1877
15QE1530	6.00"	(4) 5/16x3/4 SHCS, Washer, & Econo T-nut	15SP1878
15QE1530	12.00"	(4) 5/16x3/4 SHCS, Washer, & Econo T-nut	15SP1879
15QE1530	18.00"	(4) 5/16x3/4 SHCS, Washer, & Econo T-nut	15SP1880
15QE1530	24.00"	(4) 5/16x3/4 SHCS, Washer, & Econo T-nut	15SP1881
15QE1530L	12.00"	(2) 5/16x3/4 SHCS, Washer, & Econo T-nut	15SP1882
15QE1530L	18.00"	(2) 5/16x3/4 SHCS, Washer, & Econo T-nut	15SP1883
15QE1530L	24.00"	(2) 5/16x3/4 SHCS, Washer, & Econo T-nut	15SP1884