

SECTION 23

25 SERIES

MACHINING SERVICES

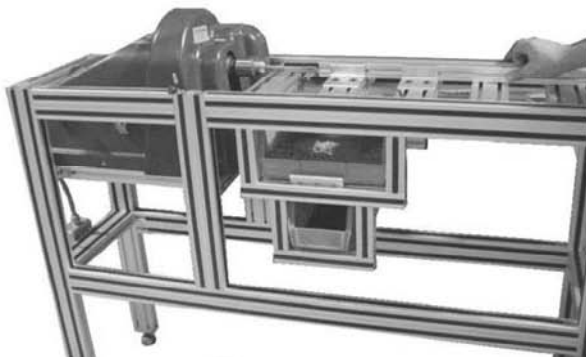
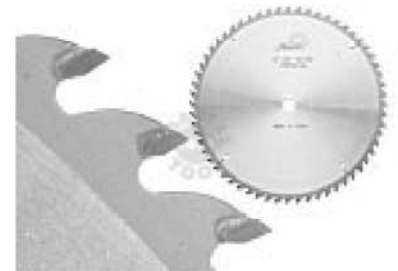
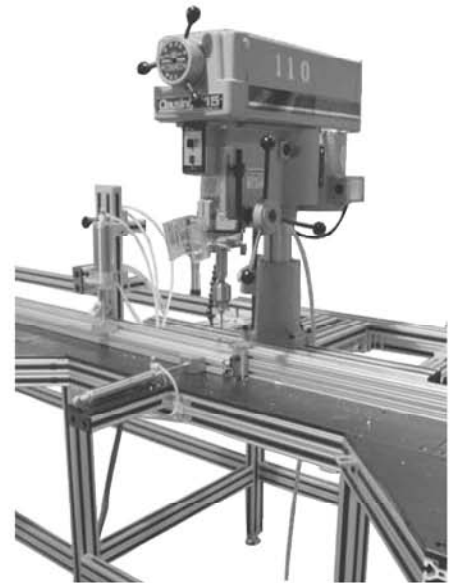
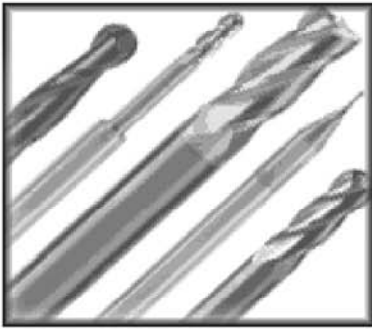

ADVANTAGES

- FAST
- CLEAN
- ACCURATE
- CONVENIENT
- COST EFFECTIVE

25 SERIES CUT TO LENGTH SERVICES (T-Slotted Extrusions)

SERVICE NUMBER	DESCRIPTION
10MA9000	CUT TO LENGTH 25QE2525, 25QEA2525
	25QEB2525, 25QEM2525, 25QE2530
10MA9001	CUT TO LENGTH 25QE2550
10MA9003	CUT TO LENGTH 25QE2575
10MA9002	CUT TO LENGTH 25QE5050

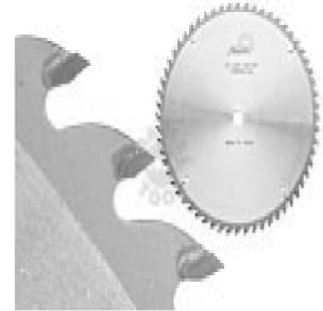

Faztek will cut your order for you on our state of the art saw equipment!

BENEFITS:

- *State of the art saws*
- *Tolerance on cuts are +/- .015"*
- *Squareness of cuts are .002" per inch*
- *Extrusions up to 100" can be shipped via*



UPS and the UPS brandmark are registered trademarks that are used with permission by its owner, United Parcel Service of America, Inc. All rights reserved.

25 SERIES EXTRUSION END TAPS

SERVICE NUMBER	DESCRIPTION
10MA9010	1/4-20 TAP FOR 25QE2525, 25QEA2525
	25QEB2525, 25QEM2525, 25QE2530
10MA9051	1/4-20 TAP FOR 25QE2550
10MA9056	1/4-20 TAP FOR 25QE2575
10MA9052	1/4-20 TAP FOR 25QE5050
10MA9053	M6 x 1.00 TAP FOR 25QE2525, 25QEA2525
	25QEB2525, 25QEM2525, 25QE2530
10MA9054	M6 x 1.00 TAP FOR 25QE2550
10MA9058	M6 x 1.00 TAP FOR 25QE2575
10MA9055	M6 x 1.00 TAP FOR 25QE5050

WHY TAP YOUR EXTRUSIONS?

- *End fasteners - page 306*
- *Casters - page 228-234*
- *Base plates - pages 360-361*
- *Leveling feet - page 234-235*
- *Endcaps - page 381*

NOTE:

- **Service is per end**

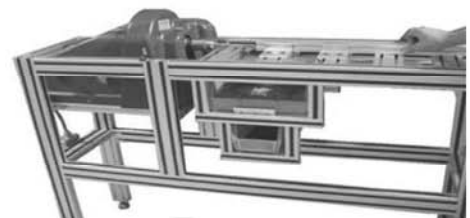

25 SERIES BANJO / BUTT FASTENER COUNTERBORES

SERVICE NUMBER	DESCRIPTION
10MA9036	25 SERIES COUNTERBORE DRILLING SERVICE
	ANCHOR / BUTT FASTENERS - USE SAME SERVICE

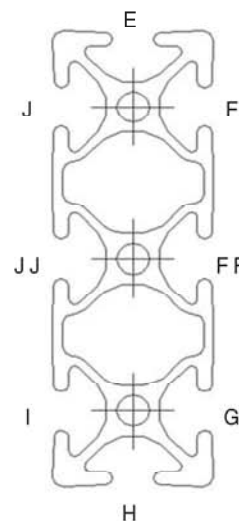
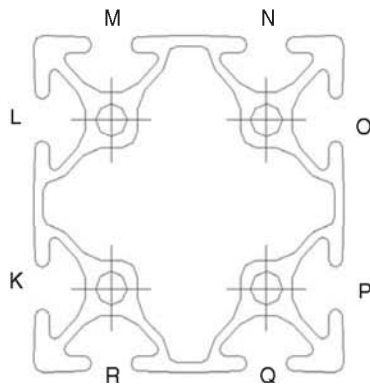
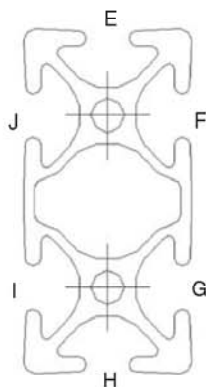
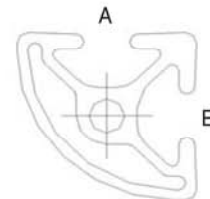
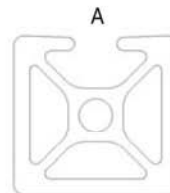
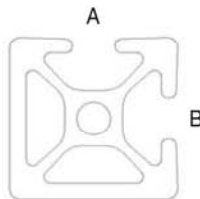
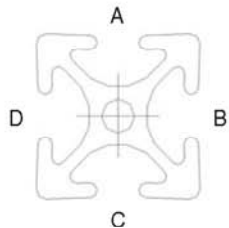

BENEFITS:

- **STRONGEST** of all connections
- Tolerance on counterbores are +/- .015"
- Infinite positioning when using anchors
- Clean, flush look!



Assembly Tip

Extrusions shorter than 4.00" Long cannot be assembled if counterbored "A" both ends. The part does not provide enough clearance for a wrench to access the fastener and properly tighten it down.

EXTRUSION DETAIL

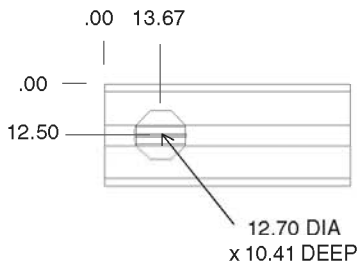

STYLE EXAMPLE

25QE2525 x 889.00 W/10MA9036 IN A BOTH ENDS

(this service will include 2 counterbores)

25QE5050 x 1574.80 W/ 10MA9036 IN KLOP BOTH ENDS

(this service will include 8 counterbores)

25 SERIES ACCESS HOLE DRILLING SERVICE

SERVICE#	DESCRIPTION
10MA9020	ACCESS HOLE DRILLING SERVICE (.218 DIA) - STANDARD
10MA9021	ACCESS HOLE DRILLING SERVICE (.06 TO .217 DIA)
10MA9022	ACCESS HOLE DRILLING SERVICE (.219 TO .375 DIA)

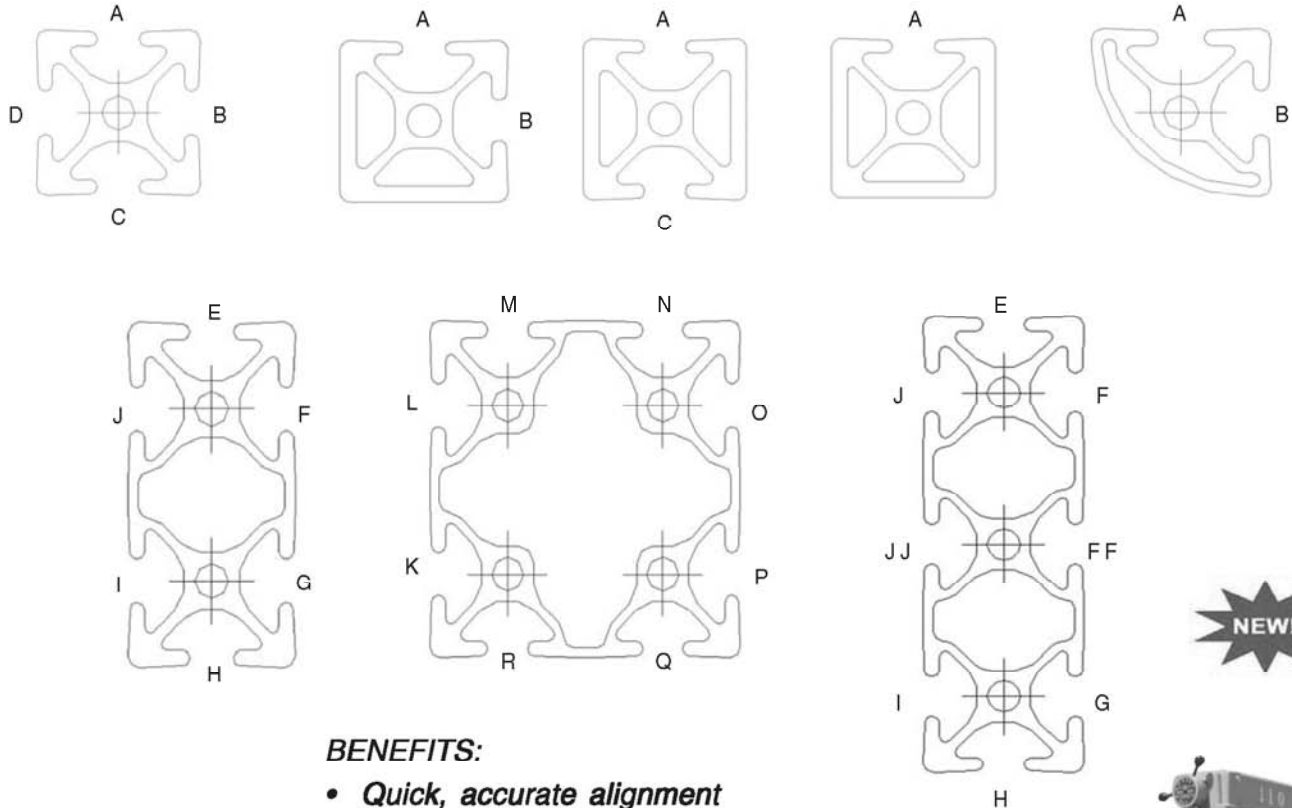

BENEFITS:

- **Quick, accurate alignment**
- **Tolerance on access holes are +/- .030"**
- **Allows for smaller panel notches**
- **Clean, hidden look!**

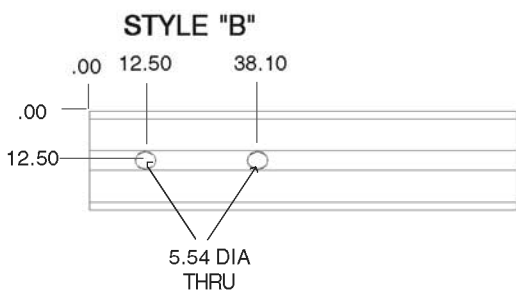
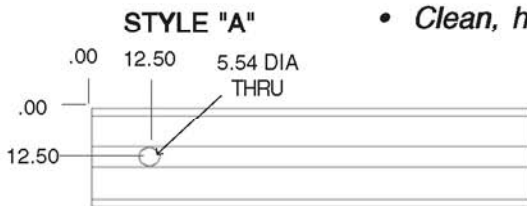

TO DRILL YOUR OWN
ACCESS HOLES, SEE
PAGE 327

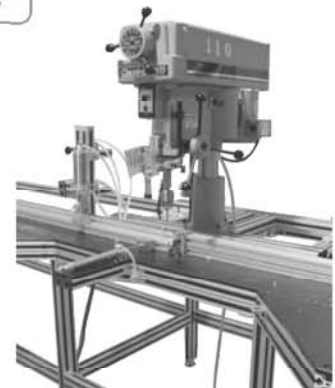

OPEN STYLE EXAMPLE

25QE2550 x 381.00 W/10MA9020 IN U @ 12.5, 127.00 AND IN V @ 12.5, 266.7
(this service will include 4 access holes)

STYLE A EXAMPLE

25QE2525x 1143.00 W/10MA9020 IN R @ STYLE A BOTH ENDS
(this service will include 2 access holes)



WORK STATION



OFFICE CUBICALS



CONVEYOR SYSTEM

25 SERIES CUSTOM MITER CUTS

Contact Faztek to request a standard miter cut template!

SERVICE NO.	DESCRIPTION
10MA9025	MITER CUT SERVICE FOR 25QE2525, 25QEA2525
	25QEB2525, 25QEM2525, 25QE2530
10MA9026	MITER CUT SERVICE FOR 25QE2550
10MA9032	MITER CUT SERVICE FOR 25QE2575
10MA9027	MITER CUT SERVICE FOR 25QE5050

- *Please submit a drawing with all miter cuts*
- *Service is per end*
- *Great support for heavy duty applications*
- *For standard 45° supports, see page 358*

• *All 25 series extrusions can be miter cut from 30° to 90°*

25 SERIES MITER CUTS AND COUNTERBORES

SERVICE NO.	DESCRIPTION
10MA9030	MITER CUT & C-BORE FOR 25QE2525
10MA9031	MITER CUT & C-BORE FOR 25QE2550
10MA9033	MITER CUT & C-BORE FOR 25QE2575

HARDWARE INCLUDED!

- *25 series extrusions can be miter cut and counterbored from 45° to 90°*
- *Please submit a drawing with any mitercut and c-bore*
- *Maximum length of 72" - DUE TO SAFETY ISSUES!!*
- *Service is per end*

Contact Faztek to request a standard miter cut template!

