

SECTION 1

15 SERIES T-SLOTTED ALUMINUM EXTRUSIONS

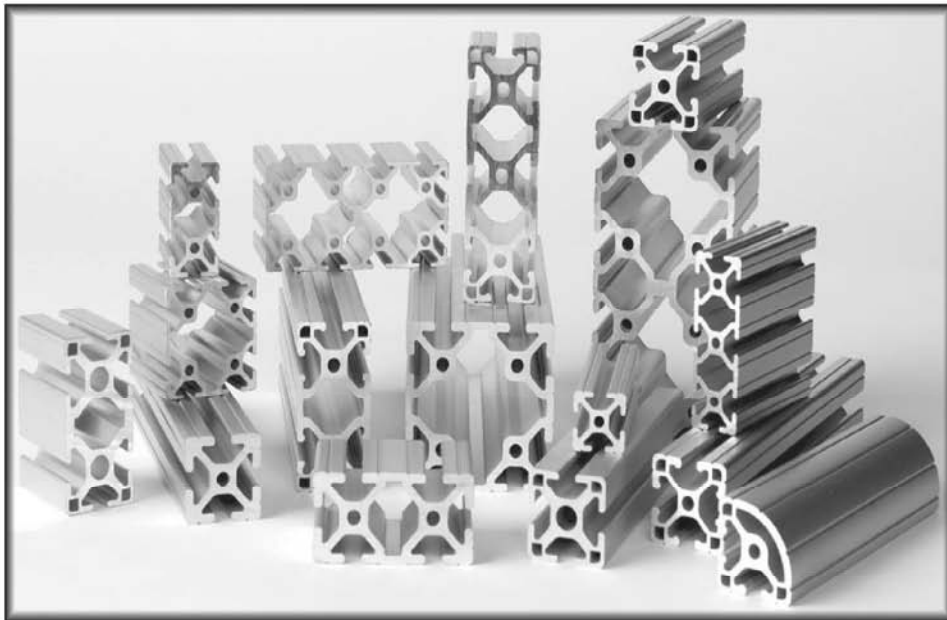

15EX1515UL

1.5" x 1.5" ULTRA-LITE T-SLOTTED ALUMINUM EXTRUSION

See page 21 for details on the drop-lock feature

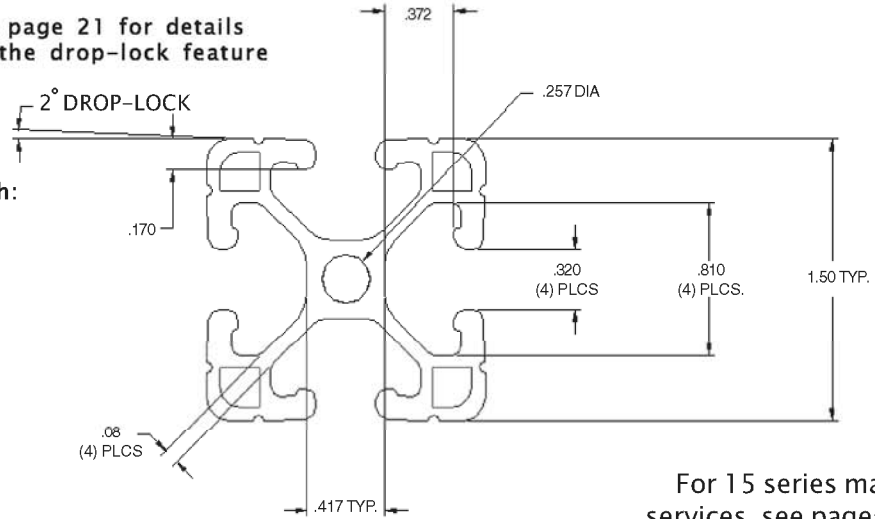

Not recommended for use with:

- Drop-in t-nut w/ alignment ball
- Drop-in t-nut w/ set screw
- U-shaped panel gasket
- Taps larger than 5/16-18
- Leveling feet larger than 5/16-18

When sizing panels, add .062 per side.

For 15 series machining services, see pages 160-170

MATERIAL SPECIFICATIONS

15EX1515UL T-SLOTTED EXTRUSION

MATERIAL	6063-T6
FINISH	CLEAR ANODIZE
	204R1 / .0004dp
SURFACE HARDNESS	250HV
WEIGHT PER FOOT	.936 LBS
STOCK LENGTHS	97" +/- .125
	145" +/- .125
	242" +/- .125
MOMENT OF INERTIA	IX = .1802" ⁴
	IY = .1802" ⁴
ESTIMATED AREA	0.780 Sq. In.

Not recommended for use in load applications, such as workstations, shop carts, material shelves, etc...

Applications for 15EX1515UL:

- *Guarding Projects*
- *Light Duty Carts*
- *Sound Enclosures*
- *Office Partitions*
- *Trade Show Displays*



MACHINE GUARDS



PERIMETER GUARDS

SOUND ENCLOSURES

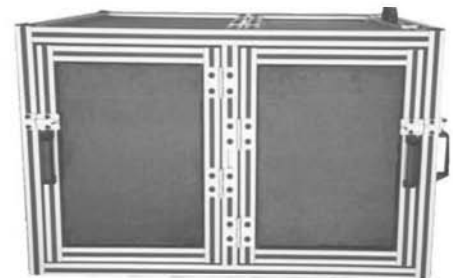

TRADE SHOW UNITS



15EX1515L

1.5" x 1.5" LITE T-SLOTTED ALUMINUM EXTRUSION

See page 21 for details on the drop-lock feature

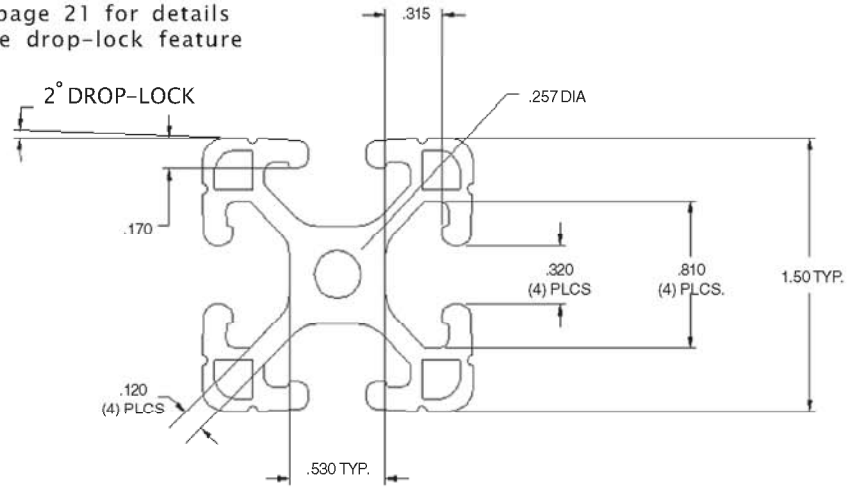

For 15 series machining services, see pages 160-170

MATERIAL SPECIFICATIONS

15EX1515L T-SLOTTED EXTRUSION

MATERIAL	6063-T6
FINISH	CLEAR ANODIZE
	204R1 / .0004dp
SURFACE HARDNESS	250HV
WEIGHT PER FOOT	1.092 LBS
STOCK LENGTHS	97" +/- .125
	145" +/- .125
	242" +/- .125
MOMENT OF INERTIA	IX = .1861" ⁴
	IY = .1861" ⁴
ESTIMATED AREA	0.910 Sq. In.

Applications for 15EX1515L:

- Large Guarding Projects
- Custom Workstations
- Material Carts
- Trade Show Units
- Guarding for Integrated Machines

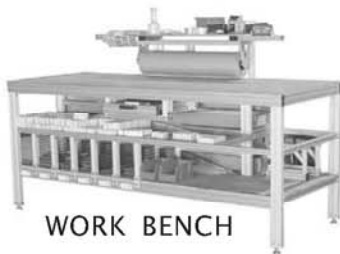

ENCLOSURES



CARTS



15QE1515L

1.5" x 1.5" LITE T-SLOTTED ALUMINUM EXTRUSION

See page 21 for details on the drop-lock feature

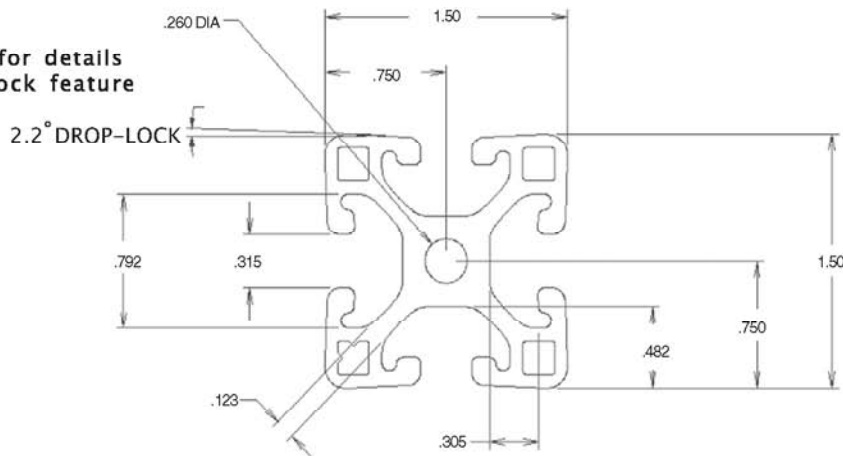

Extrusions

MATERIAL SPECIFICATIONS

15QE1515L T-SLOTTED EXTRUSION	
MATERIAL	6063-T6
FINISH	CLEAR ANODIZE
	204R1 / .0004dp
SURFACE HARDNESS	250HV
WEIGHT PER FOOT	1.114 LBS
STOCK LENGTHS	97" +/- .125
	145" +/- .125
	242" +/- .125
MOMENT OF INERTIA	IX = .1994" ⁴
	IY = .1994" ⁴
ESTIMATED AREA	0.9473 Sq. In.

For 15 series machining services, see pages 160-170

Applications for 15QE1515L:

- Large Guarding Projects
- Custom Workstations
- Material Carts
- Trade Show Units
- Guarding for Integrated Machines



WORK STATION CELL



WORK BENCH



TEST STATION

15SM1515L

1.5" x 1.5" LITE SMOOTH T-SLOTTED ALUMINUM EXTRUSION

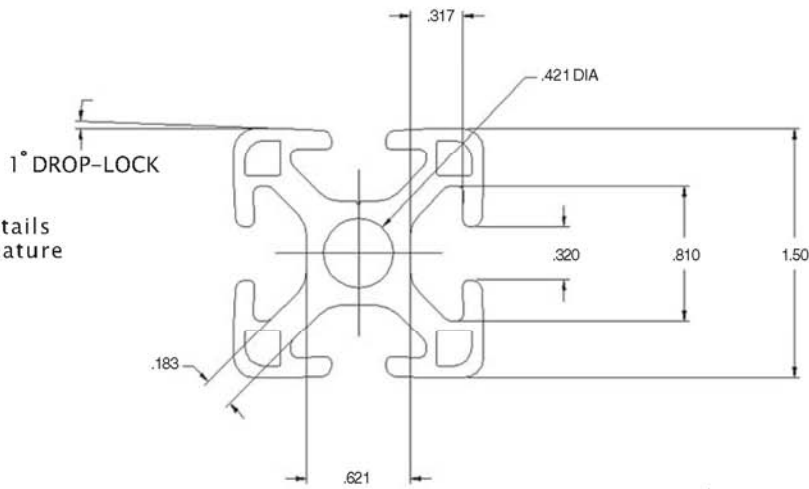

See page 21 for details on the drop-lock feature



Larger center hole for new "T" anchor fastener

Strongest Fastener - See page 136

MATERIAL SPECIFICATIONS

15SM1515L SMOOTH T-SLOTTED EXTRUSION	
MATERIAL	6063-T6
FINISH	CLEAR ANODIZE
	204R1 / .0004dp
SURFACE HARDNESS	250HV
WEIGHT PER FOOT	1.117 LBS
STOCK LENGTHS	97" +/- .125
	145" +/- .125
MOMENT OF INERTIA	IX = .2000" ⁴
	IY = .2000" ⁴
ESTIMATED AREA	0.950 Sq. In.

Applications for 15SM1515L:

- Trade Show Units
- Sound Enclosures
- Billboards
- Perimeter Guards
- Kiosks / Display Units



TRADE SHOW UNITS



TRADE SHOW DISPLAYS



MACHINE BASES

CARTS



15QEM1515L

1.5" x 1.5" LITE MONO SLOTTED T-ALUMINUM EXTRUSION

See page 21 for details on the drop-lock feature

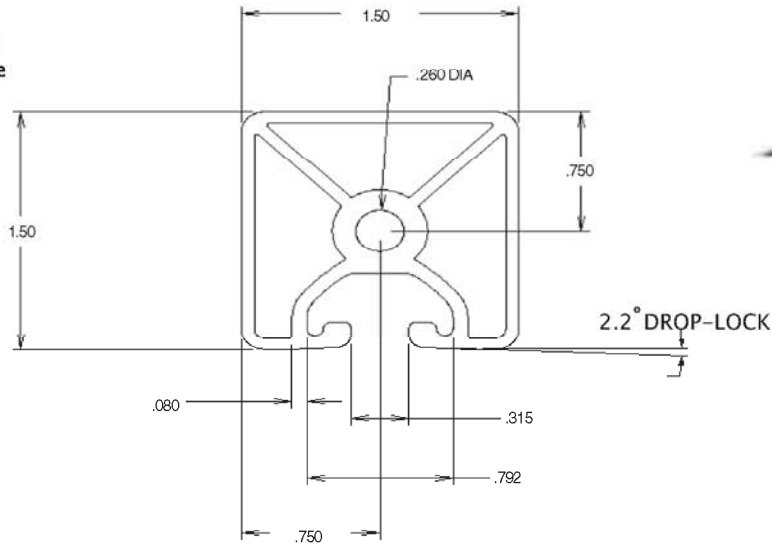

Extrusions

MATERIAL SPECIFICATIONS

15QEM1515L SMOOTH T-SLOTTED EXTRUSION

MATERIAL	6063-T6
FINISH	CLEAR ANODIZE
	204R1 / .0004dp
SURFACE HARDNESS	250HV
WEIGHT PER FOOT	1.288 LBS
STOCK LENGTHS	97" +/- .125
	145" +/- .125
MOMENT OF INERTIA	IX = .1715" ⁴
	IY = .1675" ⁴
ESTIMATED AREA	0.7502 Sq. In.

For 15 series machining services, see pages 160-170

Applications for 15QEM1515L:

- Trade Show Units
- Sound Enclosures
- Billboards
- Perimeter Guards
- Kiosks / Display Units
- Clean Rooms
- Medical, Agricultural, & Other Sanitary Environments



DISPLAY BOARD



AUTOMATED MACHINERY

15QEA1515L

1.5" x 1.5" LITE 180° BI-SLOTTED ALUMINUM EXTRUSION

See page 21 for details on the drop-lock feature

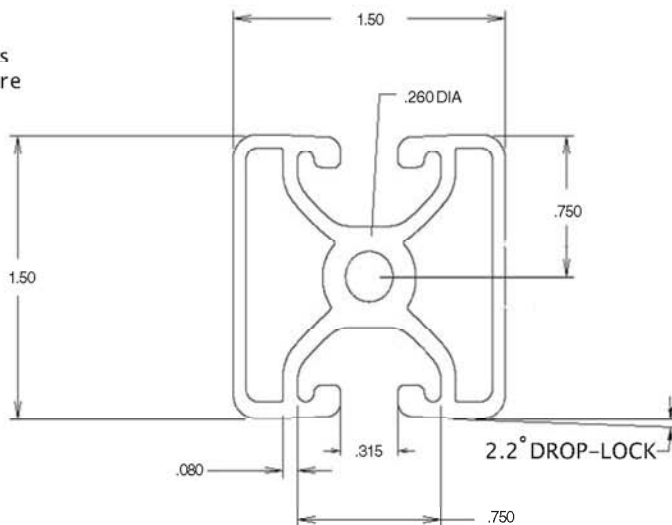

MATERIAL SPECIFICATIONS

15QEA1515L T-SLOTTED EXTRUSION	
MATERIAL	6063-T6
FINISH	CLEAR ANODIZE
	204R1 / .0004dp
SURFACE HARDNESS	250HV
WEIGHT PER FOOT	1.298 LBS
STOCK LENGTHS	97" +/- .125
	145" +/- .125
	242" +/- .125
MOMENT OF INERTIA	IX = .1780" ⁴
	IY = .1780" ⁴
ESTIMATED AREA	0.810 Sq. In.

For 15 series machining services, see pages 160-170

Applications for 15QEA1515L:

- Large Guarding Projects
- Custom Workstations
- Material Carts
- Trade Show Units
- Guarding for Integrated Machines
- Clean Rooms
- Medical, Agricultural, & Other Sanitary Environments

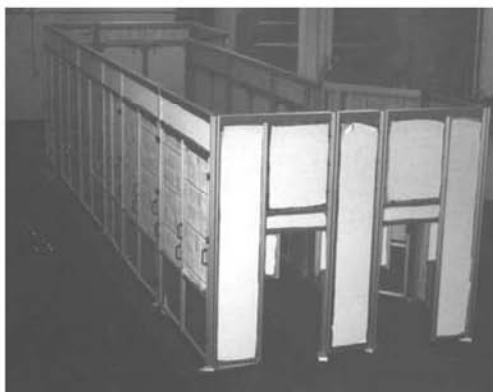

15QE1515L

1.5" x 1.5" LITE 90° BI-SLOTTED ALUMINUM EXTRUSION

See page 21 for details on the drop-lock feature

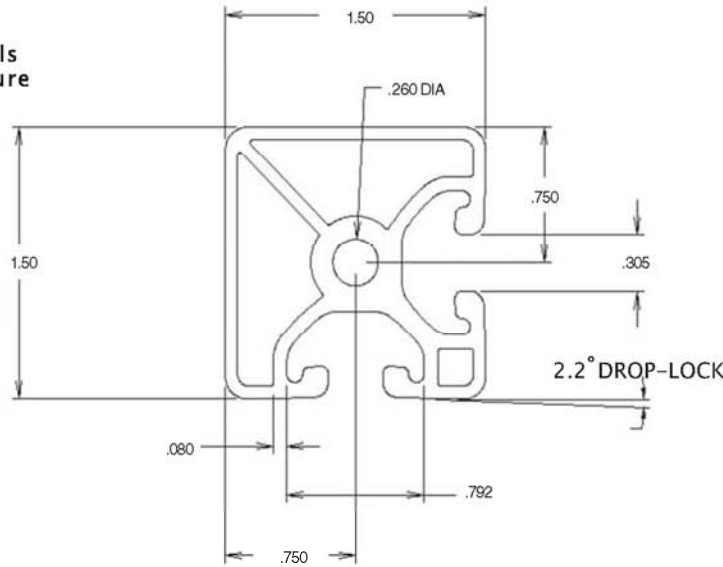

Extrusions

MATERIAL SPECIFICATIONS

15QE1515L T-SLOTTED EXTRUSION

MATERIAL	6063-T6
FINISH	CLEAR ANODIZE 204R1 / .0004dp
SURFACE HARDNESS	250HV
WEIGHT PER FOOT	1.298 LBS
STOCK LENGTHS	97" +/- .125 145" +/- .125 242" +/- .125
MOMENT OF INERTIA	IX = .2450" ⁴ IY = .2450" ⁴
ESTIMATED AREA	1.075 Sq. In.

For 15 series machining services, see pages 160-170

Applications for 15QE1515L:

- Large Guarding Projects
- Custom Workstations
- Material Carts
- Trade Show Units
- Guarding for Integrated Machines
- Clean Rooms
- Medical, Agricultural, & Other Sanitary Environments

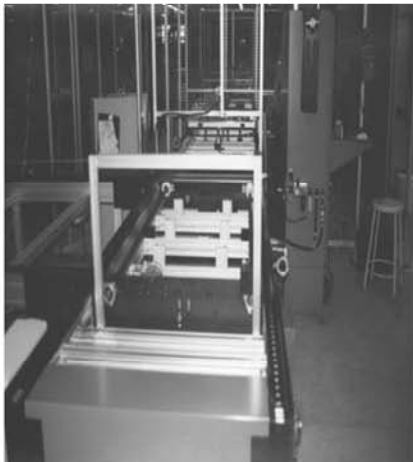

15LG1515L

1.5" x 1.5" LITE T-SLOTTED ALUMINUM EXTRUSION

See page 21 for details on the drop-lock feature

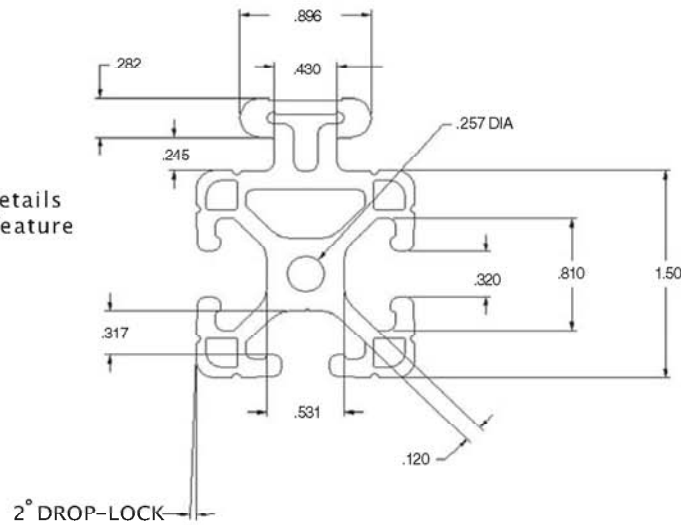

For 15 series machining services, see pages 160-170

For use with 15LM8570, 15LM8572, 15LM8574

See page 202-203 for more details

MATERIAL SPECIFICATIONS

15LG1515L T-SLOTTED EXTRUSION

MATERIAL	6063-T6
FINISH	CLEAR ANODIZE
	204R1 / .0004dp
SURFACE HARDNESS	250HV
WEIGHT PER FOOT	1.404 LBS
STOCK LENGTHS	97" +/- .125
	145" +/- .125
	242" +/- .125
MOMENT OF INERTIA	IX = .2070" ⁴
	IY = .4190" ⁴
ESTIMATED AREA	1.194 Sq. In.

Applications for 15LG1515L:

- *Pick & Place Units*
- *Washdown Applications*
- *Digital Length Systems*
- *Sorting Machines*
- *Sliding Doors*

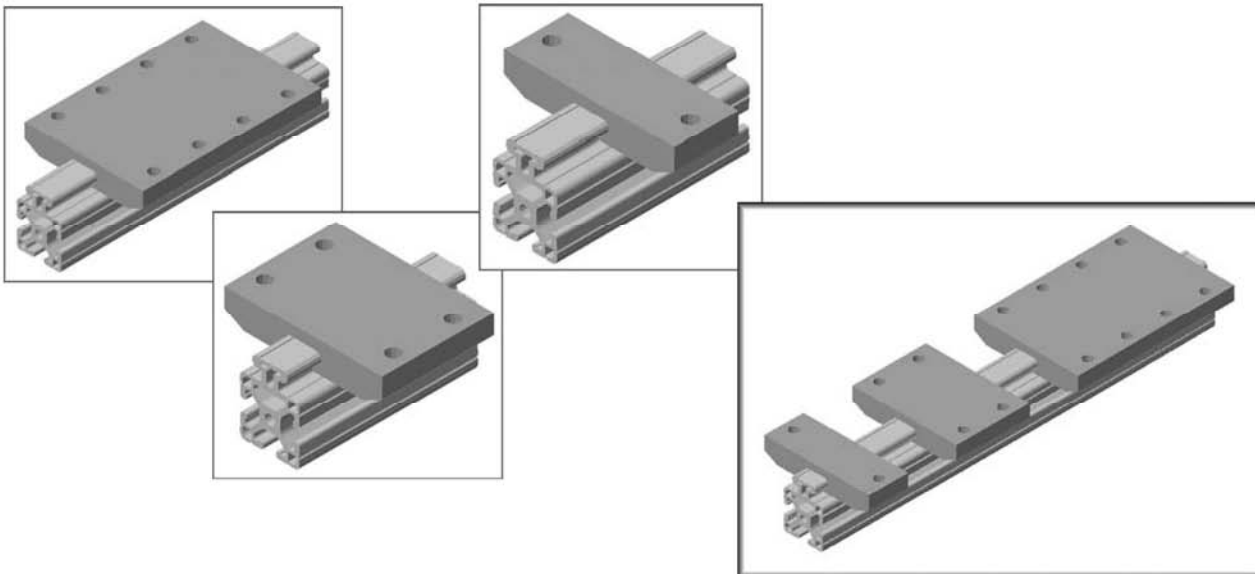

15EX1517L

1.5" x 1.5" LITE QUARTER ROUND T-SLOTTED ALUMINUM EXTRUSION

See page 21 for details on the drop-lock feature

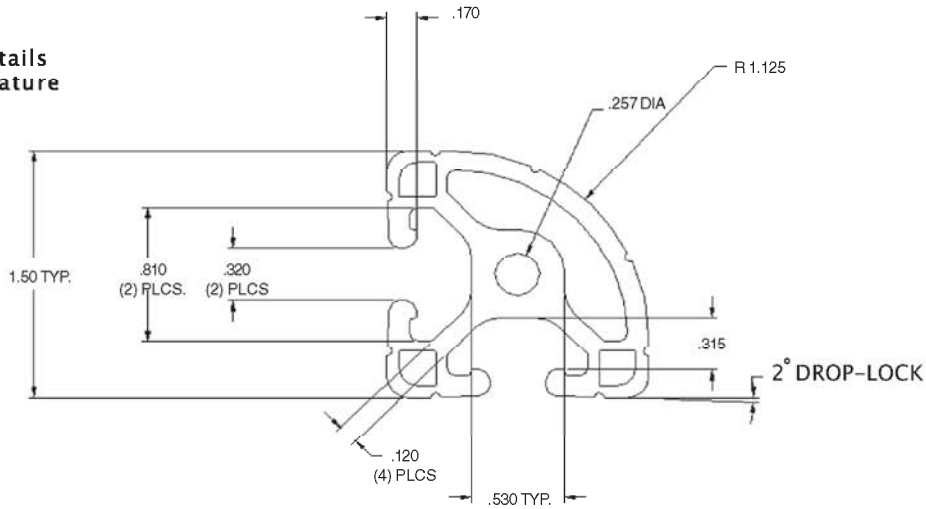

MATERIAL SPECIFICATIONS

15EX1517L T-SLOTTED EXTRUSION

MATERIAL	6063-T6
FINISH	CLEAR ANODIZE
	204R1 / .0004dp
SURFACE HARDNESS	250HV
WEIGHT PER FOOT	1.092 LBS
STOCK LENGTHS	97" +/- .125
	145" +/- .125
MOMENT OF INERTIA	IX = .1861" ⁴
	IY = .1861" ⁴
ESTIMATED AREA	0.910 Sq. In.

For 15 series machining services, see pages 160-170

Applications for 15EX1517L:

- Trade Show Units
- Sound Enclosures
- Billboards
- Perimeter Guards
- Kiosks / Display Units
- Office Furniture

CARTS

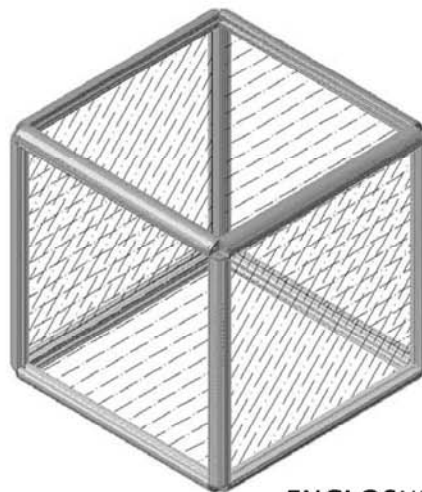

ENCLOSURES

15QE1517L

1.5" x 1.5" LITE QUARTER ROUND T-SLOTTED ALUMINUM EXTRUSION

See page 21 for details on the drop-lock feature

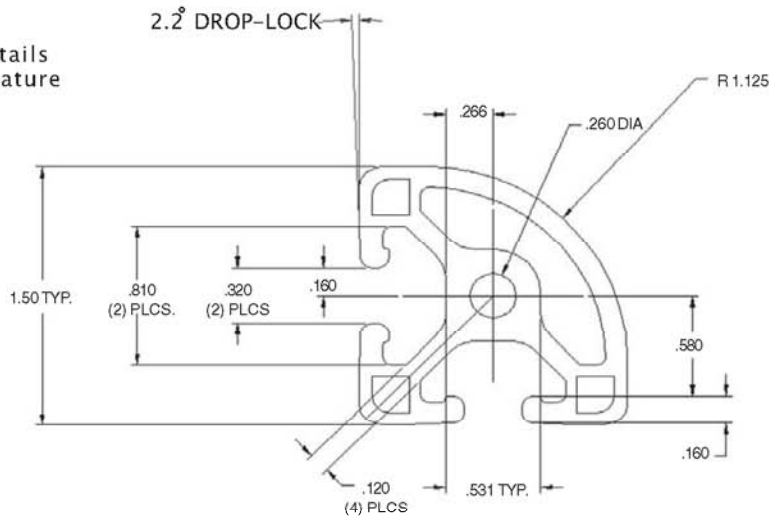

For 15 series machining services, see pages 160-170

MATERIAL SPECIFICATIONS

15QE1517L T-SLOTTED EXTRUSION

MATERIAL	6063-T6
FINISH	CLEAR ANODIZE
	204R1 / .0004dp
SURFACE HARDNESS	250HV
WEIGHT PER FOOT	0.998 LBS
STOCK LENGTHS	97" +/- .125
	145" +/- .125
MOMENT OF INERTIA	IX = .1659" ⁴
	IY = .1657" ⁴
ESTIMATED AREA	0.8324 Sq. In.

Applications for 15QE1517L:

- Trade Show Units
- Sound Enclosures
- Billboards
- Perimeter Guards
- Kiosks / Display Units
- Office Furniture
- Clean Room

CARTS



DISPLAYS

15EX1515

1.5" x 1.5" HEAVY T-SLOTTED ALUMINUM EXTRUSION

See page 21 for details on the drop-lock feature

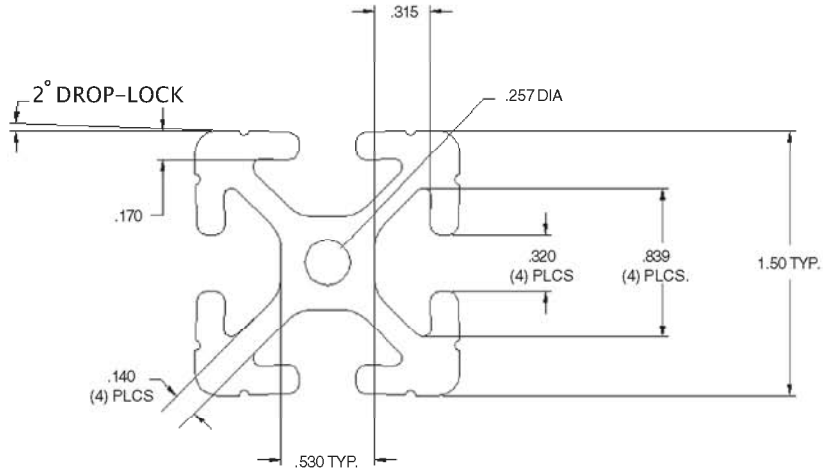

For 15 series machining services, see pages 160-170

MATERIAL SPECIFICATIONS

15EX1515 T-SLOTTED EXTRUSION	
MATERIAL	6063-T6
FINISH	CLEAR ANODIZE
	204R1 / .0004dp
SURFACE HARDNESS	250HV
WEIGHT PER FOOT	1.356 LBS
STOCK LENGTHS	97" +/- .125
	145" +/- .125
	242" +/- .125
MOMENT OF INERTIA	IX = .2511" ⁴
	IY = .2511" ⁴
ESTIMATED AREA	1.130 Sq. In.

Applications for 15EX1515:

- End of Arm Tooling
- Test Stations
- Housekeeping Carts / Racks
- Machine Guarding
- Material Stands



TEST STATION

BROOM STAND



GUARDING FOR SPECIAL MACHINES

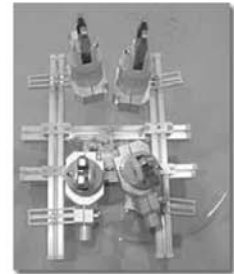
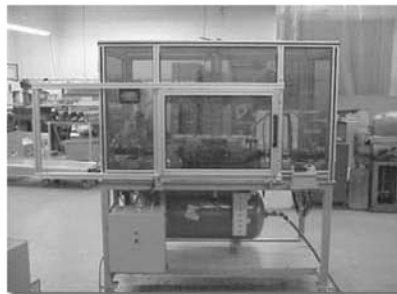

END OF ARM TOOLING



CARPET STAND

15QE1515

1.5" x 1.5" HEAVY T-SLOTTED ALUMINUM EXTRUSION

See page 21 for details on the drop-lock feature

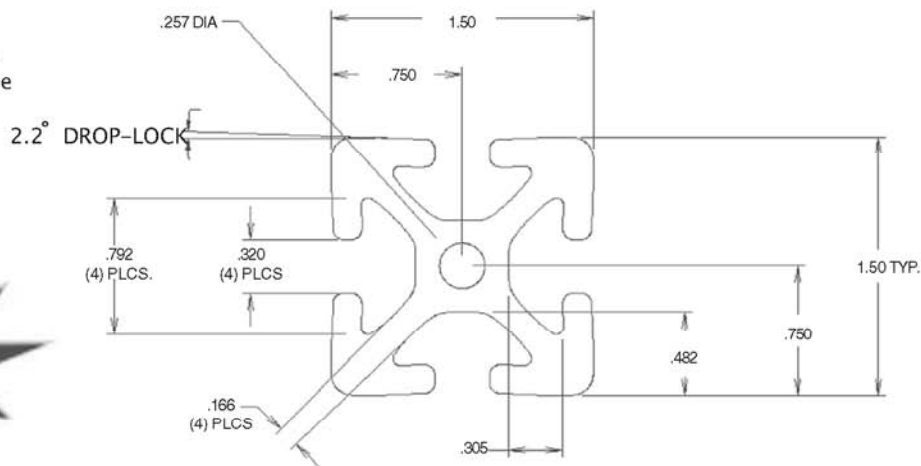

MATERIAL SPECIFICATIONS

15QE1515 T-SLOTTED EXTRUSION

MATERIAL	6063-T6
FINISH	CLEARANODIZE
	204R1 / .0004dp
SURFACE HARDNESS	250HV
WEIGHT PER FOOT	1.406 LBS
STOCK LENGTHS	97" +/- .125
	145" +/- .125
	242" +/- .125
MOMENT OF INERTIA	IX = .2671" ⁴
	IY = .2671" ⁴
ESTIMATED AREA	1.193 Sq. In.

For 15 series machining services, see pages 160-170

Applications for 15QE1515:

- End of Arm Tooling
- Test Stations
- Housekeeping Carts / Racks
- Machine Guarding
- Material Stands

OFFICE FURNITURE



TRADE SHOW BACKDROP



CONTROLS CART



15SM1515

1.5" x 1.5" HEAVY SMOOTH T-SLOTTED ALUMINUM EXTRUSION

See page 21 for details on the drop-lock feature

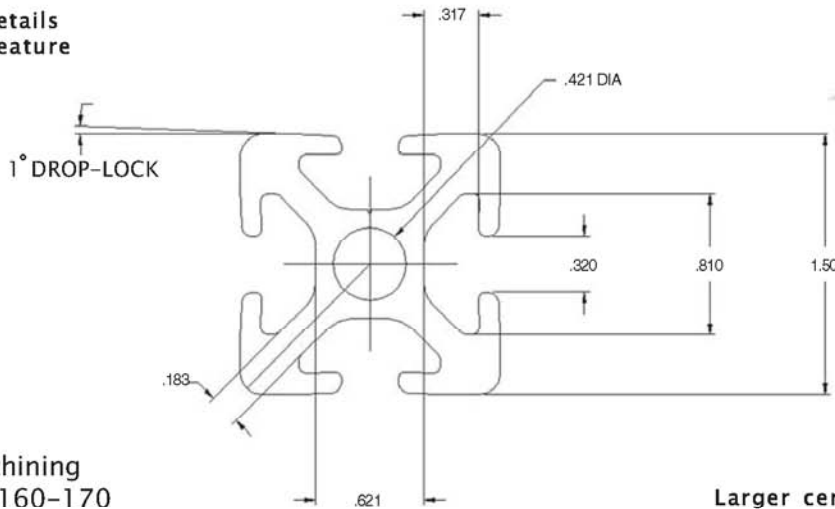

Extrusions

For 15 series machining services, see pages 160-170

Larger center hole for new "T" anchor fastener

Strongest Fastener - See page 136

MATERIAL SPECIFICATIONS

15SM1515 SMOOTH T-SLOTTED EXTRUSION	
MATERIAL	6063-T6
FINISH	CLEAR ANODIZE
	204R1 / .0004dp
SURFACE HARDNESS	250HV
WEIGHT PER FOOT	1.300 LBS
STOCK LENGTHS	97" +/- .125
	145" +/- .125
	242" +/- .125
MOMENT OF INERTIA	$I_x = .2530" ^4$
	$I_y = .2530" ^4$
ESTIMATED AREA	1.106 Sq. In.

Applications for 15SM1515:

- End of Arm Tooling
- Test Stations
- Housekeeping Carts / Racks
- Machine Guarding
- Material Stands



ASSEMBLY STATION



MACHINE GUARD



HEAVY DUTY GUARDING

15EX1530L

1.5" x 3.0" LITE T-SLOTTED ALUMINUM EXTRUSION

See page 21 for details on the drop-lock feature

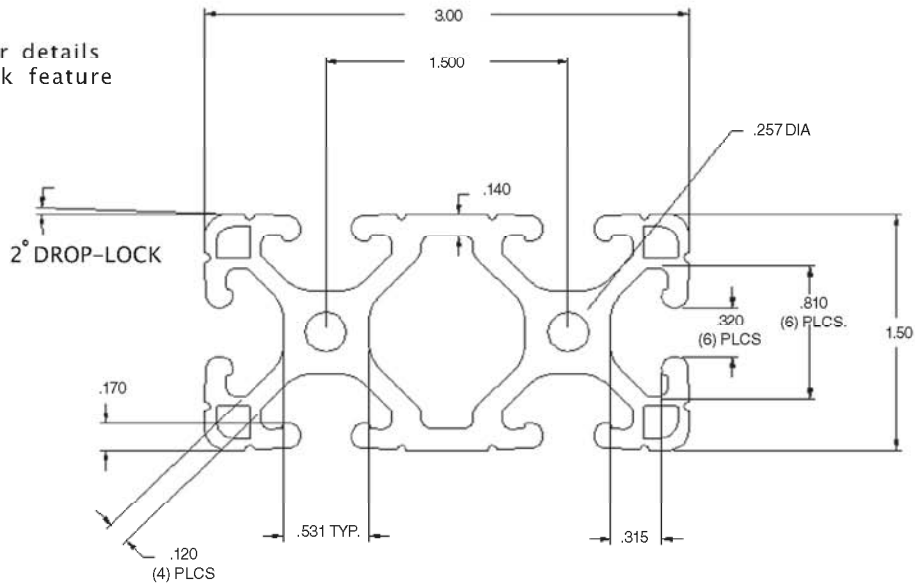

For 15 series machining services, see pages 160-170

MATERIAL SPECIFICATIONS

15EX1530L T-SLOTTED EXTRUSION	
MATERIAL	6063-T6
FINISH	CLEAR ANODIZE
	204R1 / .0004dp
SURFACE HARDNESS	250HV
WEIGHT PER FOOT	2.089 LBS
STOCK LENGTHS	97" +/- .125
	145" +/- .125
	242" +/- .125
MOMENT OF INERTIA	IX = .3910" ⁴
	IY = 1.3734" ⁴
ESTIMATED AREA	1.742 Sq. In.

Applications for 15EX1530L:

- Large Guarding Projects
- Custom Machine Bases
- Large Workstations Needing Air or Vacuum
- Material Handling Units
- Air Manifolds

SPECIAL MACHINE BASE



WORK BENCH

MACHINE BASES



HEAVY DUTY GUARDING



15QE1530L

1.5" x 3.0" LITE T-SLOTTED ALUMINUM EXTRUSION

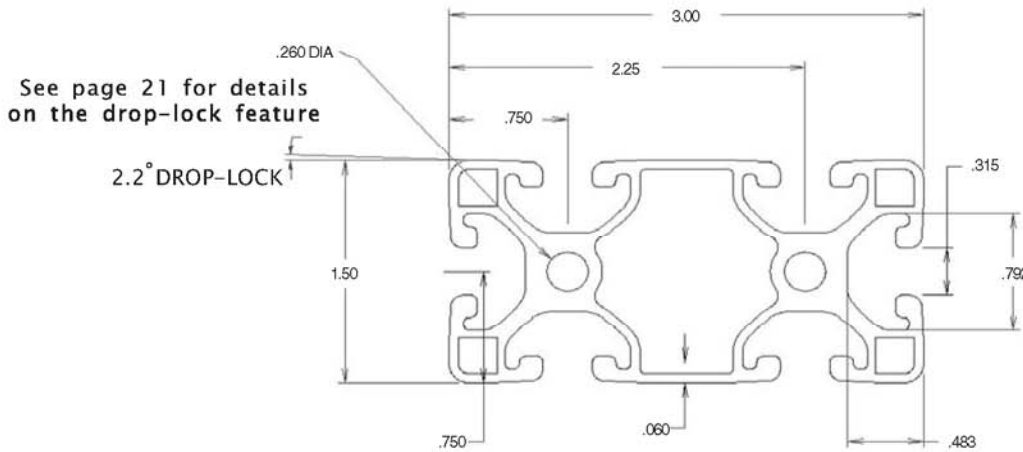

Extrusions

For 15 series machining services, see pages 160-170

MATERIAL SPECIFICATIONS

15QE1530L SMOOTH T-SLOTTED EXTRUSION	
MATERIAL	6063-T6
FINISH	CLEARANODIZE
	204R1 / .0004dp
SURFACE HARDNESS	250HV
WEIGHT PER FOOT	1.616 LBS
STOCK LENGTHS	97" +/- .125
	145" +/- .125
	242" +/- .125
MOMENT OF INERTIA	IX = .3046" ⁴
	IY = 1.2847" ⁴
ESTIMATED AREA	1.3742 Sq. In.

Applications for 15QE1530L:

- Large Guarding Projects
- Custom Machine Bases
- Large Workstations Needing Air or Vacuum
- Material Handling Units
- Air Manifolds

WORK CENTER



WORK STATION



15SM1530L

1.5" x 3.0" LITE SMOOTH T-SLOTTED ALUMINUM EXTRUSION

See page 21 for details on the drop-lock feature

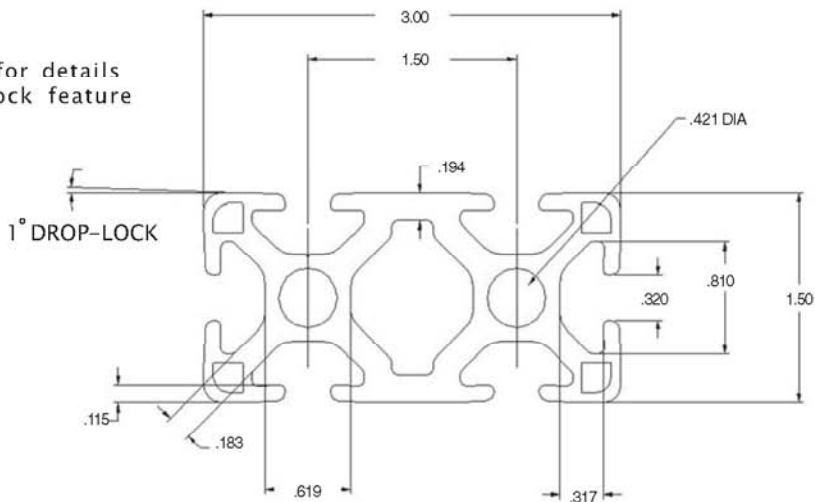

Larger center hole for new "T" anchor fastener

Strongest Fastener - See page 136

MATERIAL SPECIFICATIONS

15SM1530L SMOOTH T-SLOTTED EXTRUSION	
MATERIAL	6063-T6
FINISH	CLEAR ANODIZE
	204R1 / .0004dp
SURFACE HARDNESS	250HV
WEIGHT PER FOOT	2.167 LBS
STOCK LENGTHS	97" +/- .125
	145" +/- .125
	242" +/- .125
MOMENT OF INERTIA	IX = .4220" ⁴
	IY = 1.4430" ⁴
ESTIMATED AREA	1.842 Sq. In.

Applications for 15SM1530L:

- Large Guarding Projects
- Custom Machine Bases
- Large Workstations Needing Air or Vacuum
- Material Handling Units
- Air Manifolds



TAPPING MACHINE

ASSEMBLY STATION



WORKSTATION

15EX1530

1.5" x 3.0" HEAVY T-SLOTTED ALUMINUM EXTRUSION

See page 21 for details on the drop-lock feature

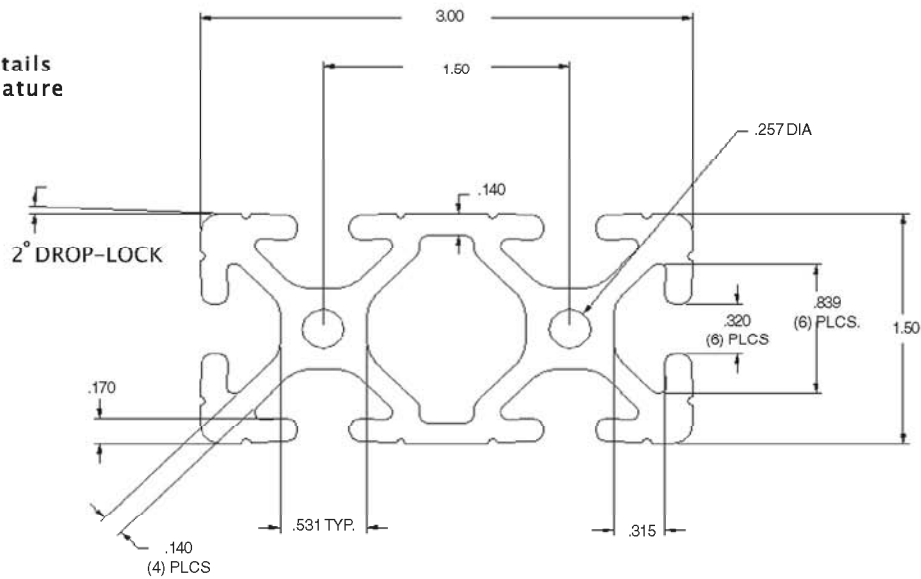

For 15 series machining services, see pages 160-170

MATERIAL SPECIFICATIONS

15EX1530 T-SLOTTED EXTRUSION

MATERIAL	6063-T6
FINISH	CLEAR ANODIZE
	204R1 / .0004dp
SURFACE HARDNESS	250HV
WEIGHT PER FOOT	2.386 LBS
STOCK LENGTHS	97" +/- .125
	145" +/- .125
	242" +/- .125
MOMENT OF INERTIA	$I_x = .4816 \text{ in}^4$
	$I_y = 1.8532 \text{ in}^4$
ESTIMATED AREA	1.987 Sq. In.

Applications for 15EX1530:

- Large Bases for Machines or Fixtures
- Custom Workstations
- Conveyors
- Air Manifolds
- Test Stands



AIR MANIFOLDS

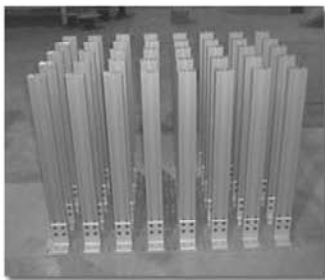

WORK STATION LEGS

CYLINDER MOUNTS



MATERIAL RACKS

15QE1530

1.5" x 3.0" HEAVY T-SLOTTED ALUMINUM EXTRUSION

See page 21 for details on the drop-lock feature

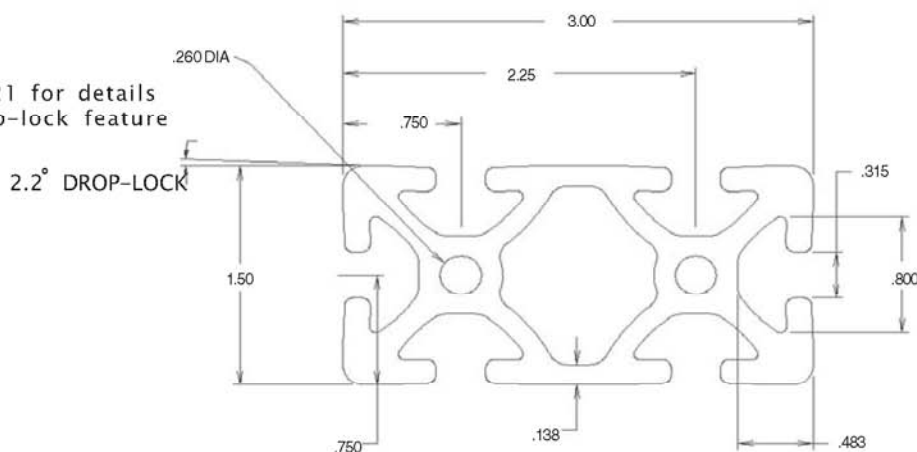

MATERIAL SPECIFICATIONS

15QE1530 T-SLOTTED EXTRUSION

MATERIAL	6063-T6
FINISH	CLEAR ANODIZE
	204R1 / .0004dp
SURFACE HARDNESS	250HV
WEIGHT PER FOOT	2.397 LBS
STOCK LENGTHS	97" +/- .125
	145" +/- .125
	242" +/- .125
MOMENT OF INERTIA	IX = .4839" ⁴
	IY = 1.8660" ⁴
ESTIMATED AREA	2.038 Sq. In.

For 15 series machining services, see pages 160-170

Applications for 15QE1530:

- Large Machine Bases
- Custom Workstations
- Conveyors
- Air Manifolds
- Test Stands
- Fixtures



WORK STATION



ERGONOMIC CART



TOOLING CART

15SM1530

1.5" x 3.0" HEAVY SMOOTH T-SLOTTED ALUMINUM EXTRUSION

See page 21 for details on the drop-lock feature

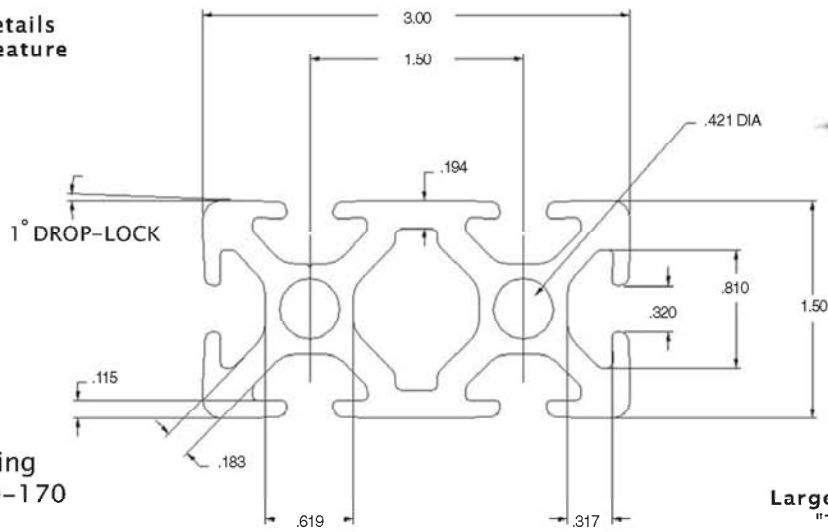

For 15 series machining services, see pages 160-170

Larger center hole for new "T" anchor fastener

Strongest Fastener - See page 136

Extrusions

MATERIAL SPECIFICATIONS

15SM1530 SMOOTH T-SLOTTED EXTRUSION	
MATERIAL	6063-T6
FINISH	CLEAR ANODIZE
	204R1 / .0004dp
SURFACE HARDNESS	250HV
WEIGHT PER FOOT	2.033 LBS
STOCK LENGTHS	97" +/- .125
	145" +/- .125
	242" +/- .125
MOMENT OF INERTIA	IX = .4830" ⁴
	IY = 1.7540" ⁴
ESTIMATED AREA	2.391 Sq. In.

Applications for 15SM1530:

- Large Bases for Machines or Fixtures
- Custom Workstations
- Conveyors
- Air Manifolds
- Test Stands

PART TRANSFER SYSTEM

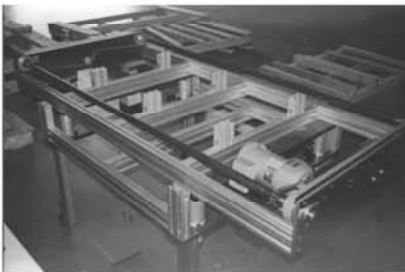

FIXTURE STATION



CORKBOARD CART



WHITEBOARD CART

15EX1545L

1.5" x 4.5" LITE T-SLOTTED ALUMINUM EXTRUSION

See page 21 for details on the drop-lock feature

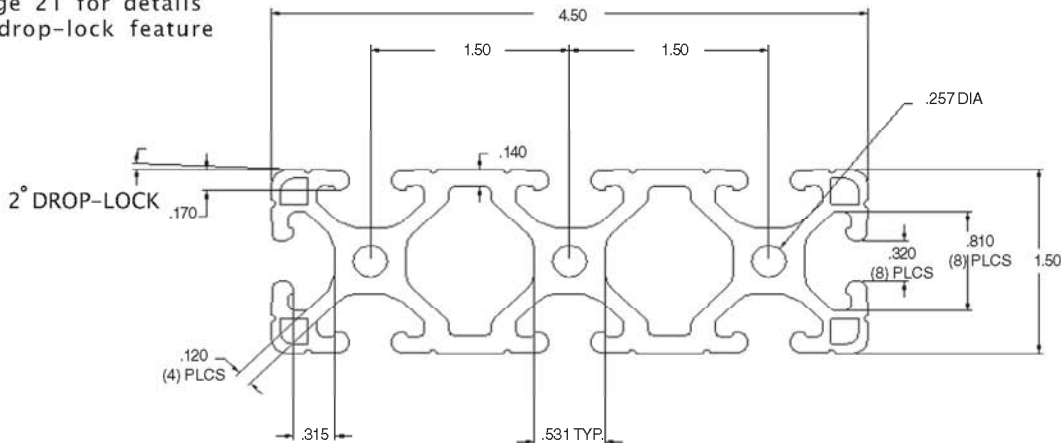

For 15 series machining services, see pages 160-170

MATERIAL SPECIFICATIONS

15EX1545L T-SLOTTED EXTRUSION	
MATERIAL	6063-T6
FINISH	CLEARANODIZE
	204R1 / .0004dp
SURFACE HARDNESS	250HV
WEIGHT PER FOOT	3.084 LBS
STOCK LENGTHS	97" +/- .125
	145" +/- .125
MOMENT OF INERTIA	IX = .6022" ⁴
	IY = 4.5845" ⁴
ESTIMATED AREA	2.573 Sq. In.

Applications for 15EX1545L:

- *Conveyors*
- *Custom Machine Bases*
- *Custom Workstations*
- *Dual Air Manifolds*
- *Material Handling Units*

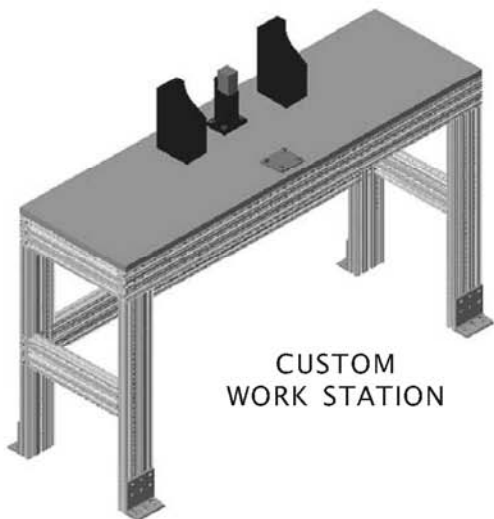

CUSTOM WORK STATION

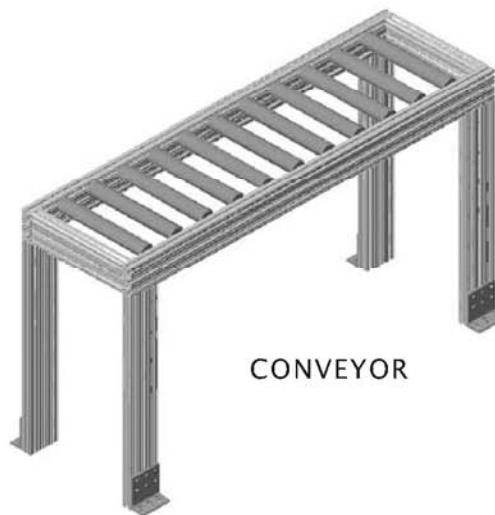

CONVEYOR

15QE3030L

3.0" x 3.0" LITE T-SLOTTED ALUMINUM EXTRUSION

See page 21 for details on the drop-lock feature

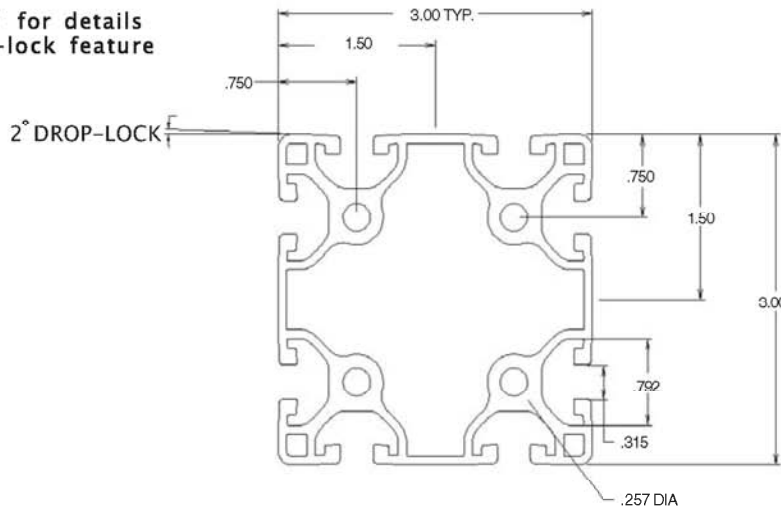

Extrusions

For 15 series machining services, see pages 160-170

MATERIAL SPECIFICATIONS

15QE3030L T-SLOTTED EXTRUSION

MATERIAL	6063-T6
FINISH	CLEAR ANODIZE
	204R1 / .0004dp
SURFACE HARDNESS	250HV
WEIGHT PER FOOT	2.559 LBS
STOCK LENGTHS	97" +/- .125
	145" +/- .125
MOMENT OF INERTIA	IX = 2.39410 ⁱⁿ⁴
	IY = 2.39410 ⁱⁿ⁴
ESTIMATED AREA	2.2953 Sq. In.

Applications for 15QE3030L:

- Large Machine Bases
- In Plant Offices
- Heavy Duty Material Handling
- Medium Duty Mezzanines
- Robot Stands
- Air Manifolds



HEAVY DUTY PERIMETER GUARD



CYLINDER MOUNTS



PALLET HORSE

15EX3030

3.0" x 3.0" HEAVY T-SLOTTED ALUMINUM EXTRUSION

See page 21 for details on the drop-lock feature

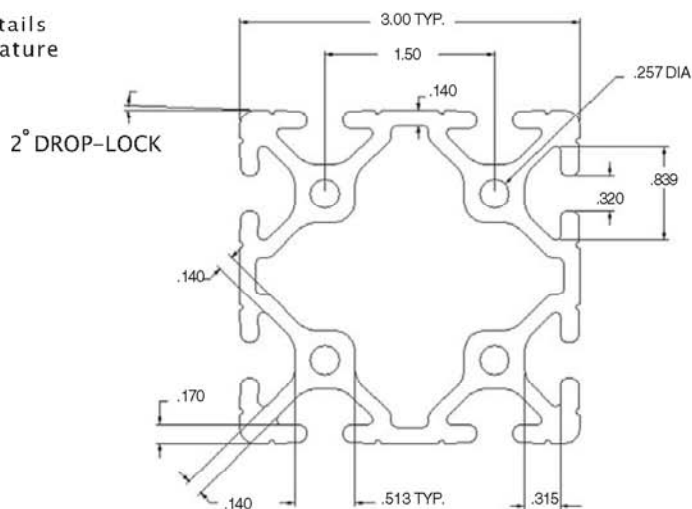

MATERIAL SPECIFICATIONS

15EX3030 T-SLOTTED EXTRUSION

MATERIAL	6063-T6
FINISH	CLEAR ANODIZE
	204R1 / .0004dp
SURFACE HARDNESS	250HV
WEIGHT PER FOOT	3.656 LBS
STOCK LENGTHS	97" +/- .125
	145" +/- .125
MOMENT OF INERTIA	$I_x = 3.3461''^4$
	$I_y = 3.3461''^4$
ESTIMATED AREA	3.044 Sq. In.

For 15 series machining services, see pages 160-170

Applications for 15EX3030:

- Large Machine Bases
- Tooling Carts
- Heavy Duty Material Handling
- Conveyor Base
- Robot Stands
- Air Manifolds



TOOLING CART



CONVEYOR BASE

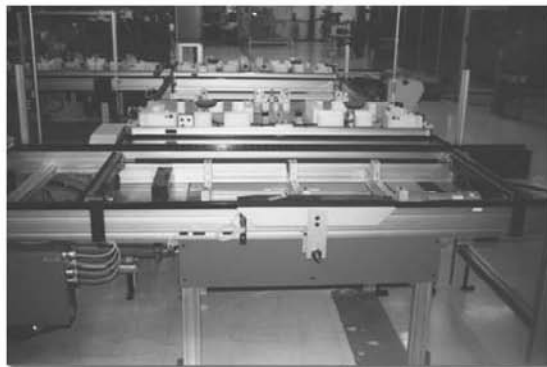

15QE3030

3.0" x 3.0" HEAVY T-SLOTTED ALUMINUM EXTRUSION

See page 21 for details on the drop-lock feature

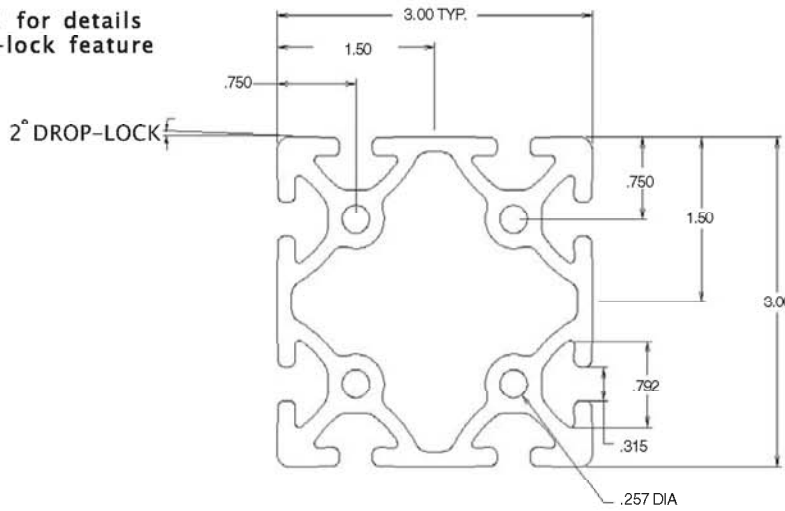

Extrusions

MATERIAL SPECIFICATIONS

15QE3030 T-SLOTTED EXTRUSION	
MATERIAL	6063-T6
FINISH	CLEAR ANODIZE
	204R1 / .0004dp
SURFACE HARDNESS	250HV
WEIGHT PER FOOT	3.611 LBS
STOCK LENGTHS	97" +/- .125
	145" +/- .125
MOMENT OF INERTIA	IX = 3.21130 ⁱⁿ⁴
	IY = 3.21130 ⁱⁿ⁴
ESTIMATED AREA	3.0704 Sq. In.

For 15 series machining services, see pages 160-170

Applications for 15QE3030:

- Large Machine Bases
- In Plant Offices
- Heavy Duty Material Handling
- Medium Duty Mezzanines
- Robot Stands
- Air Manifolds

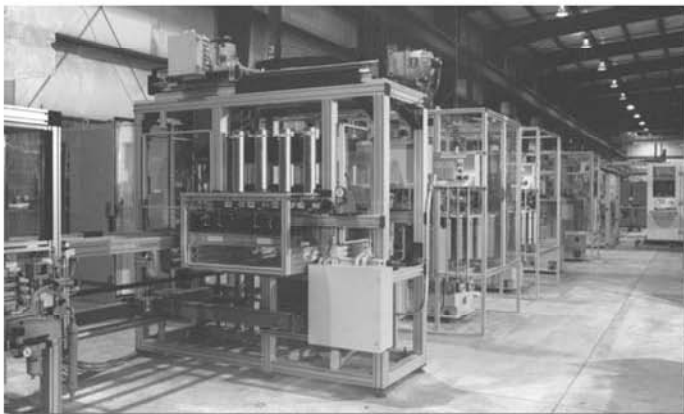

INDUSTRIAL WORK CELL

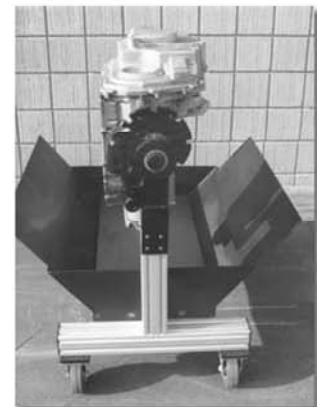

ENGINE STAND

15SM3030

3.0" x 3.0" HEAVY SMOOTH T-SLOTTED ALUMINUM EXTRUSION

See page 21 for details on the drop-lock feature

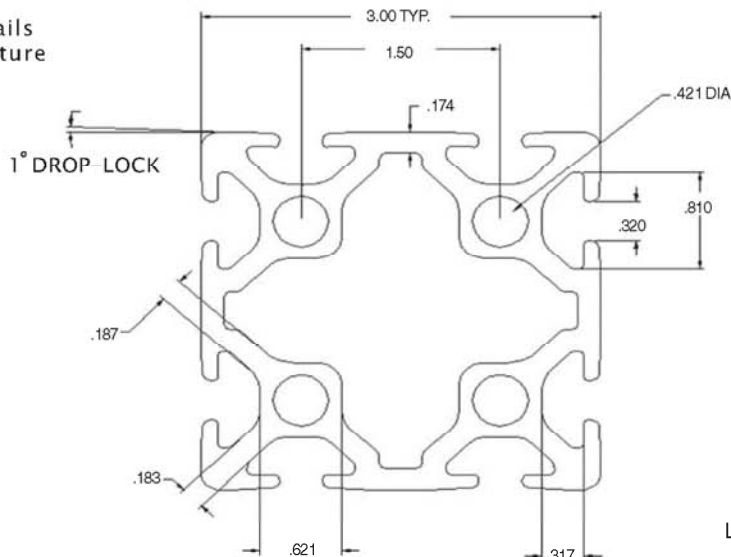

Larger center hole for new "T" anchor fastener

Strongest Fastener - See page 136

MATERIAL SPECIFICATIONS

15SM3030 SMOOTH T-SLOTTED EXTRUSION	
MATERIAL	6063-T6
FINISH	CLEAR ANODIZE
	204R1 / .0004dp
SURFACE HARDNESS	250HV
WEIGHT PER FOOT	3.125 LBS
STOCK LENGTHS	97" +/- .125
	145" +/- .125
MOMENT OF INERTIA	IX = 3.1510" ⁴
	IY = 3.1510" ⁴
ESTIMATED AREA	3.664 Sq. In.

Applications for 15SM3030:

- Large Machine Bases
- In Plant Offices
- Heavy Duty Material Handling
- Medium Duty Mezzanines
- Robot Stands
- Air Manifolds



MACHINE BASES

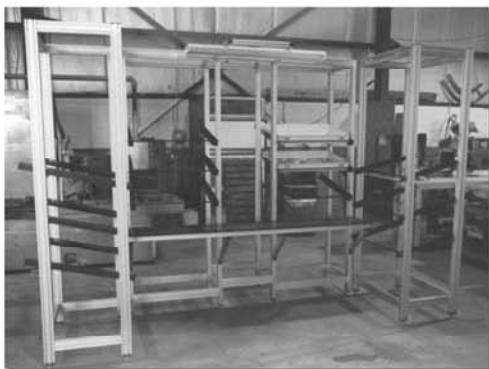

MATERIAL RACKS



MEZZANINE

15EX3060

3.0" x 6.0" HEAVY T-SLOTTED ALUMINUM EXTRUSION

See page 21 for details on the drop-lock feature

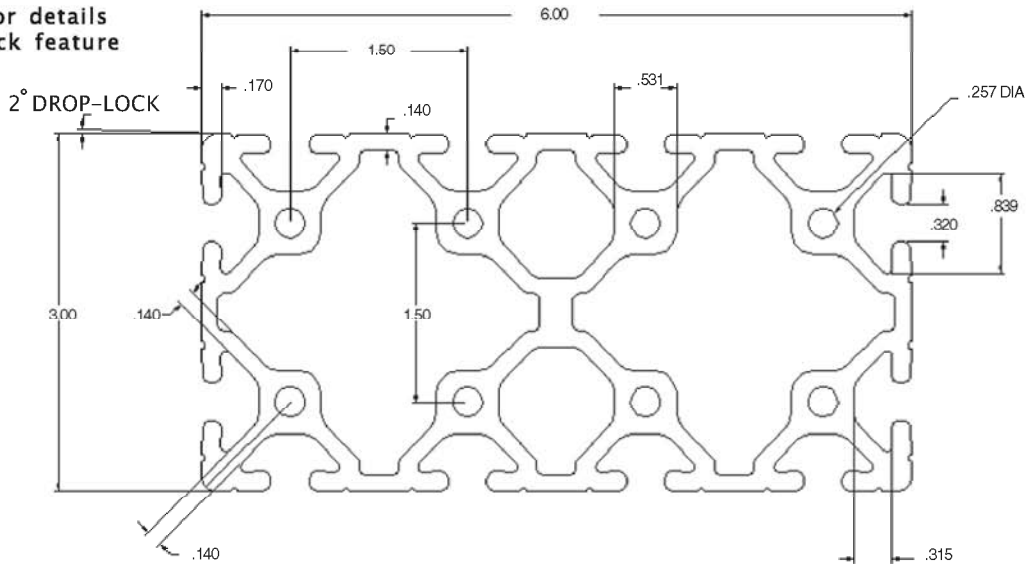

MATERIAL SPECIFICATIONS

15EX3060 T-SLOTTED EXTRUSION	
MATERIAL	6063-T6
FINISH	CLEAR ANODIZE
	204R1 / .0004dp
SURFACE HARDNESS	250HV
WEIGHT PER FOOT	6.684 LBS
STOCK LENGTHS	97" +/- .125
	145" +/- .125
MOMENT OF INERTIA	IX = 5.6669" ⁴
	IY = 19.4672" ⁴
ESTIMATED AREA	5.638 Sq. In.

For 15 series machining services, see pages 160-170

Applications for 15EX3060:

- Large Machine Bases
- In Plant Offices
- Heavy Duty Material Handling
- Heavy Duty Mezzanines
- Custom Robot Stands
- Dual / Quad Air Manifolds

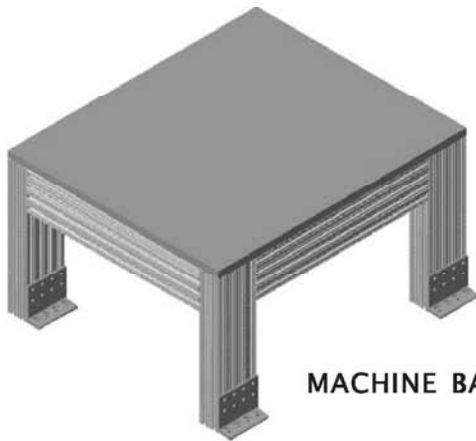

MACHINE BASE

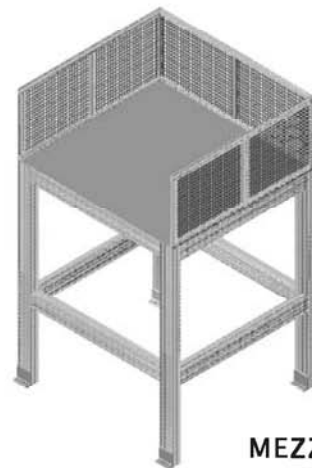

MEZZANINE

15QE3060

3.0" x 6.0" HEAVY T-SLOTTED ALUMINUM EXTRUSION

See page 21 for details on the drop-lock feature

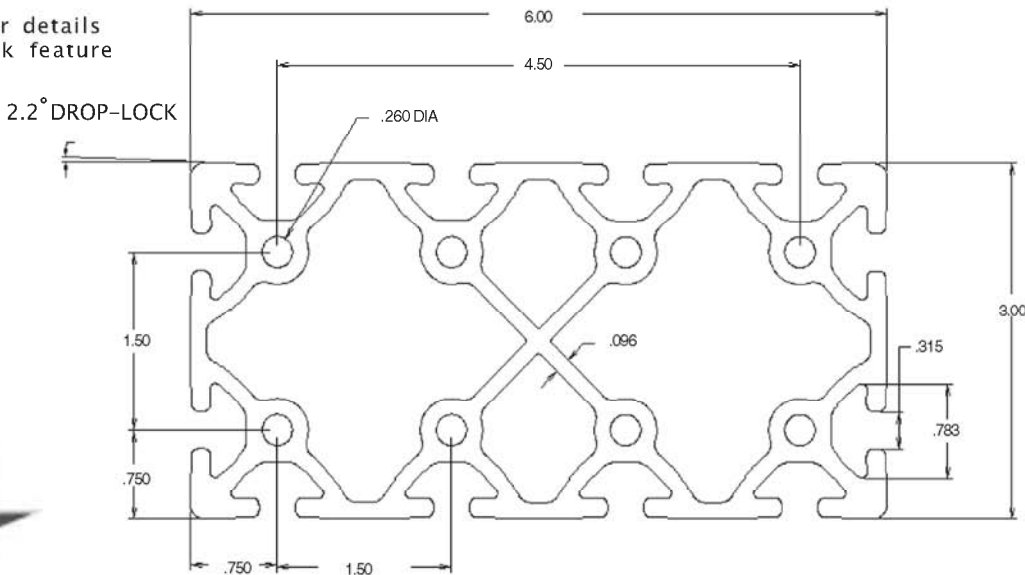

MATERIAL SPECIFICATIONS

15QE3060 T-SLOTTED EXTRUSION

MATERIAL	6063-T6
FINISH	CLEAR ANODIZE
	204R1 / .0004dp
SURFACE HARDNESS	250HV
WEIGHT PER FOOT	7.703 LBS
STOCK LENGTHS	97" +/- .125
	145" +/- .125
MOMENT OF INERTIA	IX = 5.9795" ⁴
	IY = 20.4845" ⁴
ESTIMATED AREA	5.6387 Sq. In.

For 15 series machining services, see pages 160-170

Applications for 15QE3060:

- Large Machine Bases
- In Plant Offices
- Heavy Duty Material Handling
- Heavy Duty Mezzanines
- Custom Robot Stands
- Dual / Quad Air Manifolds

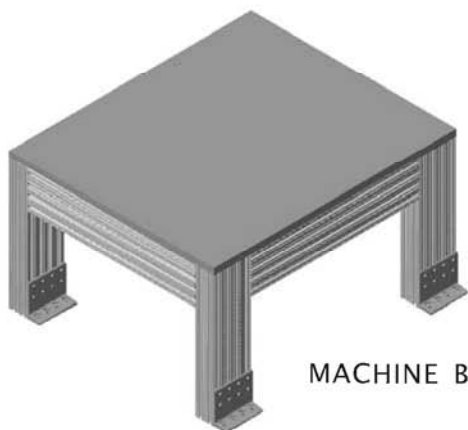

MACHINE BASE

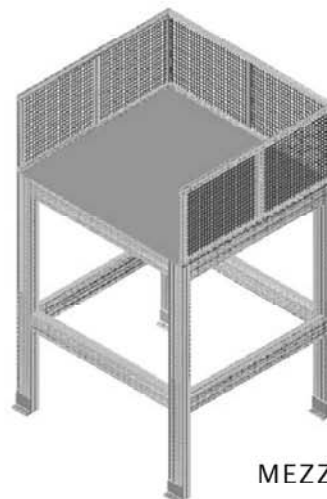

MEZZANINE

15QE1717L

1.75" x 1.75" LITE T-SLOTTED ALUMINUM EXTRUSION

See page 21 for details on the drop-lock feature

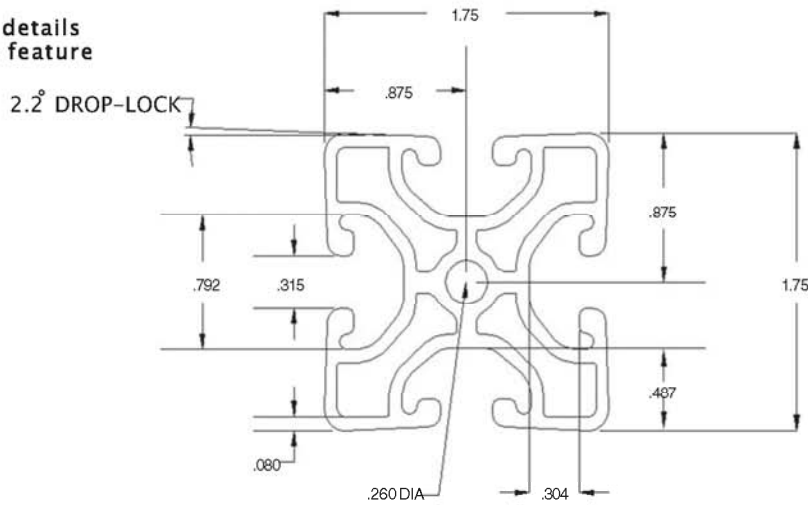

Extrusions

For 15 series machining services, see pages 160-170

MATERIAL SPECIFICATIONS

15QE1717L T-SLOTTED EXTRUSION	
MATERIAL	6063-T6
FINISH	CLEAR ANODIZE
	204R1 / .0004dp
SURFACE HARDNESS	250HV
WEIGHT PER FOOT	1.317 LBS
STOCK LENGTHS	97" +/- .125
	145" +/- .125
MOMENT OF INERTIA	IX = 0.3122" ⁴
	IY = 0.3122" ⁴
ESTIMATED AREA	1.0975 Sq. In.

Applications for 15QE1717L:

- Large Machine Bases
- In Plant Offices
- Heavy Duty Material Handling
- Heavy Duty Mezzanines
- Custom Robot Stands
- Dual / Quad Air Manifolds

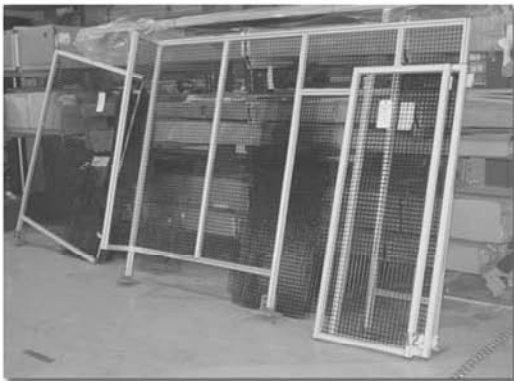

PERIMETER GUARD SECTIONS

DISPLAY CENTER



15QE2323L

2.375" x 2.375" LITE T-SLOTTED ALUMINUM EXTRUSION

See page 21 for details on the drop-lock feature

2.2° DROP-LOCK

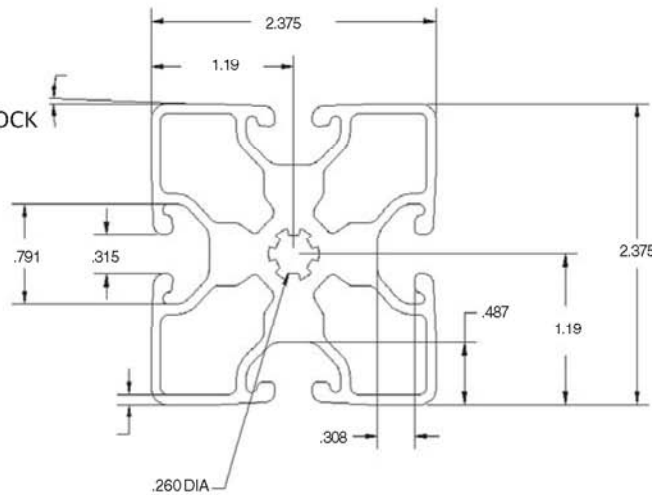

For 15 series machining services, see pages 160-170

MATERIAL SPECIFICATIONS

15QE2323L T-SLOTTED EXTRUSION

MATERIAL	6063-T6
FINISH	CLEARANODIZE
	204R1 / .0004dp
SURFACE HARDNESS	250HV
WEIGHT PER FOOT	1.745 LBS
STOCK LENGTHS	97" +/- .125
	145" +/- .125
MOMENT OF INERTIA	IX = 0.8683" ⁴
	IY = 0.8683" ⁴
ESTIMATED AREA	5.638 Sq. In.

Applications for 15QE2323L:

- Large Machine Bases
- In Plant Offices
- Heavy Duty Material Handling
- Custom Robot Stands
- Dual / Quad Air Manifolds
- Fixture Carts



FIXTURE CART

FIXTURE CARTS

