

SECTION 18

25 SERIES

T-SLOTTED ALUMINUM
EXTRUSIONS

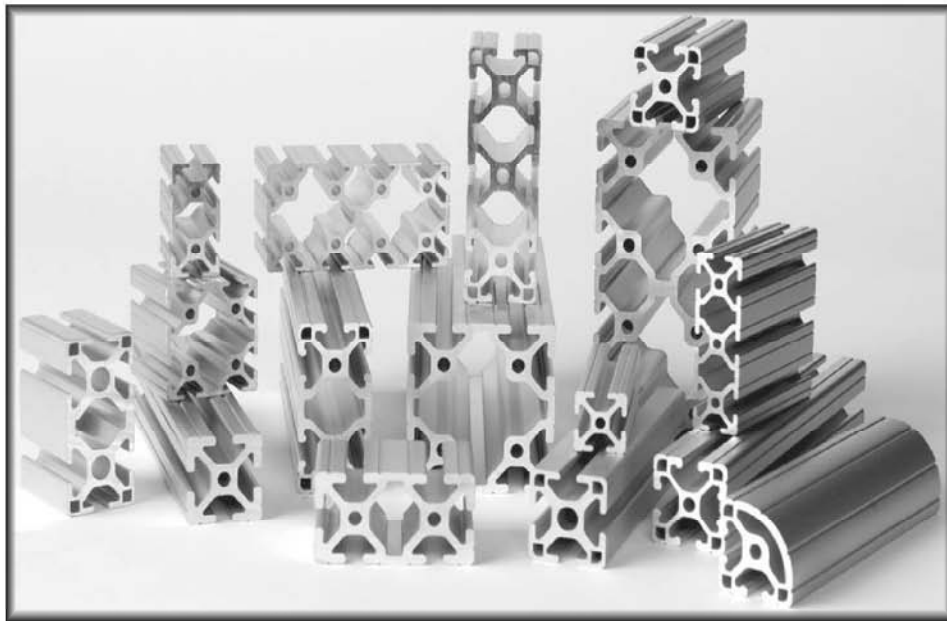

25QE2525

25mm x 25mm T-SLOTTED ALUMINUM EXTRUSION

See page 21 for details on the drop-lock feature

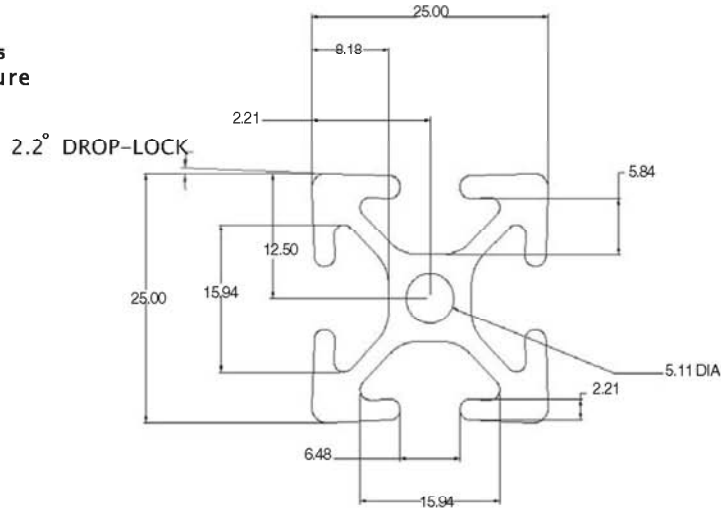

For 25 series machining services, see pages 374-379

MATERIAL SPECIFICATIONS

25QE2525 T-SLOTTED EXTRUSION

MATERIAL	6063-T6
FINISH	CLEAR ANODIZE
	204R1 / .0004dp
SURFACE HARDNESS	250HV
WEIGHT PER FOOT	.954 LBS
STOCK LENGTHS	97" +/- .125
	145" +/- .125
MOMENT OF INERTIA	IX = .0834" ⁴
	IY = .3137" ⁴
ESTIMATED AREA	.795 Sq. In.

Applications for 25QE2525:

- Small Bases for Machines or Fixtures
- Small Workstations
- Conveyors
- Small Test Stations

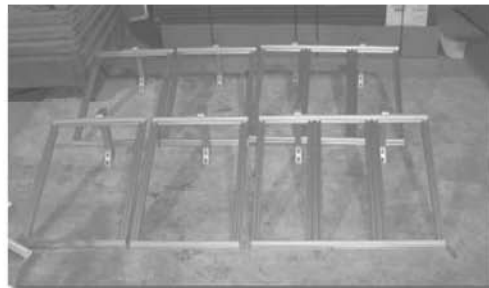
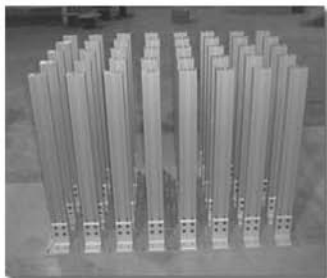

Extrusions

25QEB2525

25mm x 25mm 90° BI-SLOTTED ALUMINUM EXTRUSION

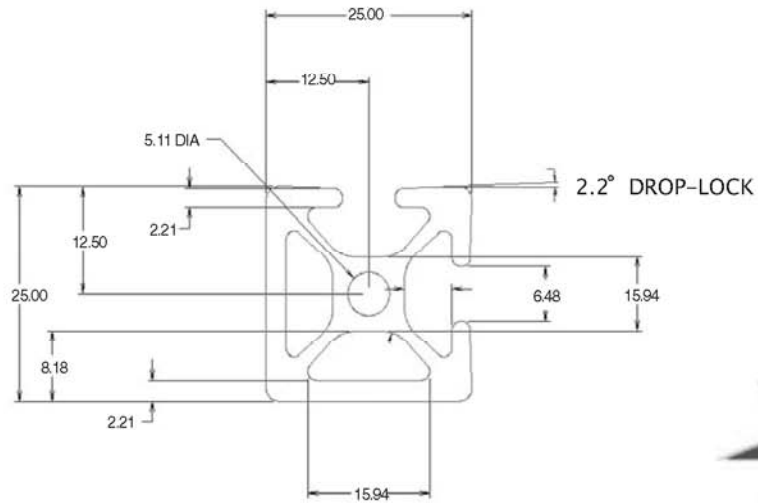

MATERIAL SPECIFICATIONS

25QEB2525 T-SLOTTED EXTRUSION

MATERIAL	6063-T6
FINISH	CLEAR ANODIZE
	204R1 / .0004dp
SURFACE HARDNESS	250HV
WEIGHT PER FOOT	1.800 LBS
STOCK LENGTHS	97" +/- .125
	145" +/- .125
MOMENT OF INERTIA	IX = .1202" ⁴
	IY = .9769" ⁴
ESTIMATED AREA	1.146 Sq. In.

For 25 series machining services, see pages 374-379

Applications for 25QEB2525:

- *Conveyors*
- *Custom Machine Bases*
- *Custom Workstations*
- *Light Duty Material Handling*

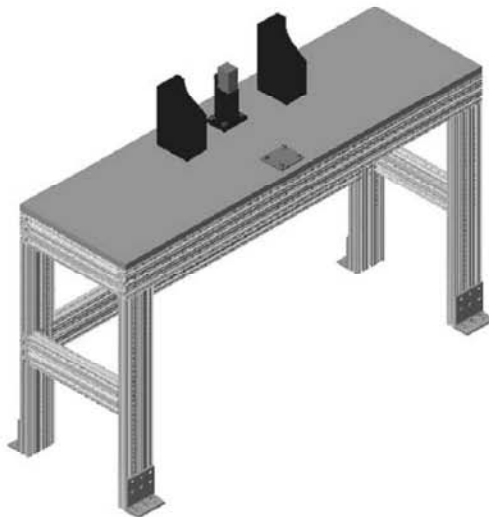

25QEA2525

25mm x 25mm 90° BI-SLOTTED ALUMINUM EXTRUSION

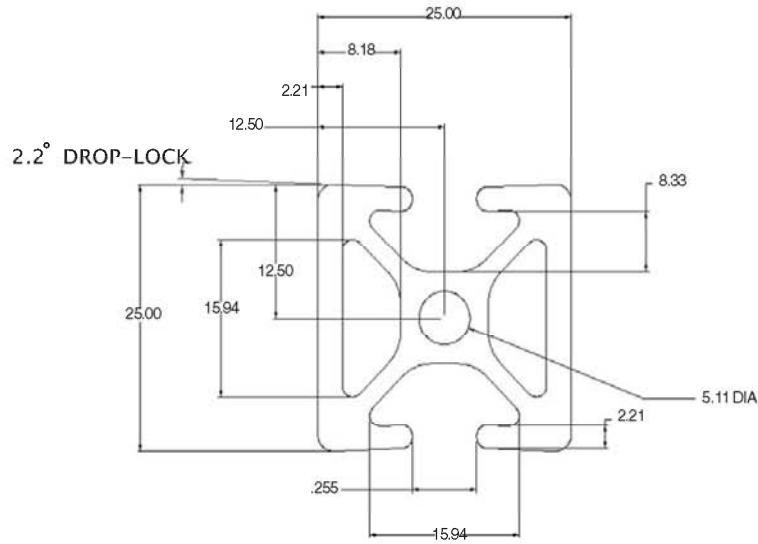

For 25 series machining services, see pages 374-379

MATERIAL SPECIFICATIONS

25QEA2525 T-SLOTTED EXTRUSION	
MATERIAL	6063-T6
FINISH	CLEAR ANODIZE
	204R1 / .0004dp
SURFACE HARDNESS	250HV
WEIGHT PER FOOT	.954 LBS
STOCK LENGTHS	97" +/- .125
	145" +/- .125
MOMENT OF INERTIA	IX = .0834" ⁴
	IY = .3137" ⁴
ESTIMATED AREA	.795 Sq. In.

Applications for 25QEA2525:

- **Small Bases for Machines or Fixtures**
- **Small Workstations**
- **Conveyors**
- **Small Test Stations**
- **Machine Guarding**

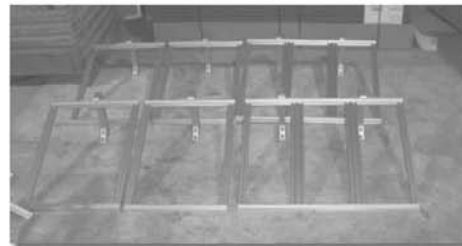
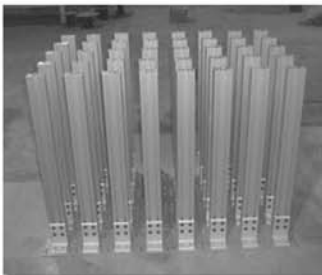

Extrusions

25QEM2525

25mm x 25mm MONO-SLOTTED ALUMINUM EXTRUSION

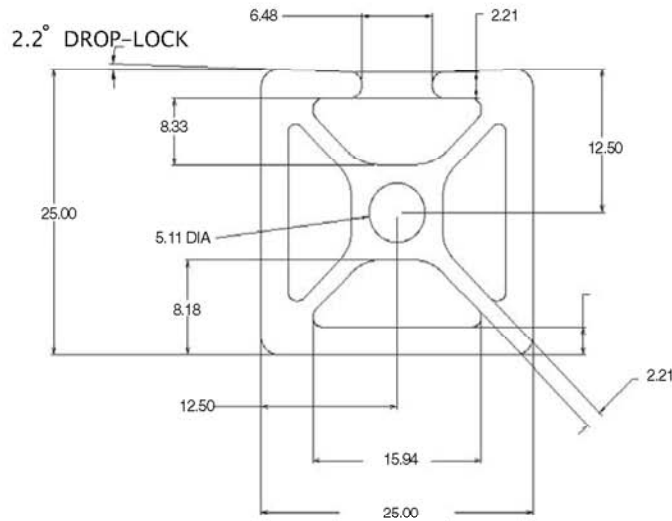

MATERIAL SPECIFICATIONS

25QEM2525 T-SLOTTED EXTRUSION

MATERIAL	6063-T6
FINISH	CLEARANODIZE
	204R1 / .0004dp
SURFACE HARDNESS	250HV
WEIGHT PER FOOT	1.800 LBS
STOCK LENGTHS	97" +/- .125
	145" +/- .125
MOMENT OF INERTIA	IX = .1202" ⁴
	IY = .9769" ⁴
ESTIMATED AREA	1.146 Sq. In.

For 25 series machining services, see pages 374-379

Applications for 25QEM2525:

- **Conveyors**
- **Machine Guarding**
- **Custom Machine Bases**
- **Custom Workstations**
- **Light Duty Material Handling**

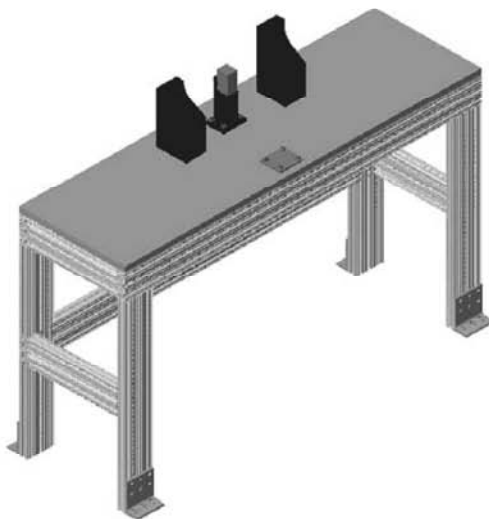

25QE2530

25mm x 25mm QUARTER ROUND T-SLOTTED ALUMINUM EXTRUSION

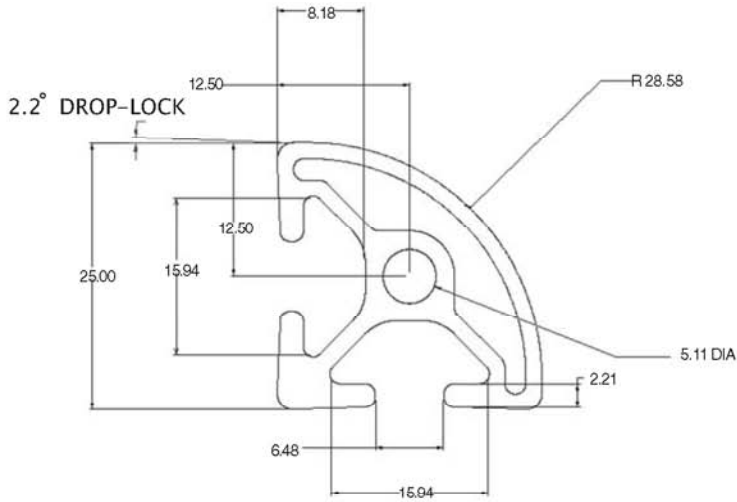

For 25 series machining services, see pages 374-379

MATERIAL SPECIFICATIONS

25QE2530 T-SLOTTED EXTRUSION

MATERIAL	6063-T6
FINISH	CLEAR ANODIZE
	204R1 / .0004dp
SURFACE HARDNESS	250HV
WEIGHT PER FOOT	.954 LBS
STOCK LENGTHS	97" +/- .125
	145" +/- .125
MOMENT OF INERTIA	IX = .0834" ⁴
	IY = .3137" ⁴
ESTIMATED AREA	.795 Sq. In.

Applications for 25QE2530:

- *Small Bases for Machines or Fixtures*
- *Small Workstations*
- *Conveyors*
- *Custom Desks*
- *Small Test Stations*

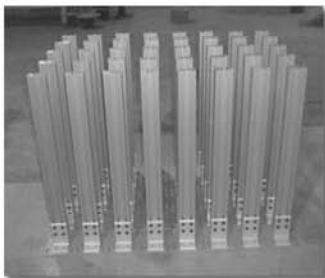

Extrusions

25QE2550

25mm x 50mm T-SLOTTED ALUMINUM EXTRUSION

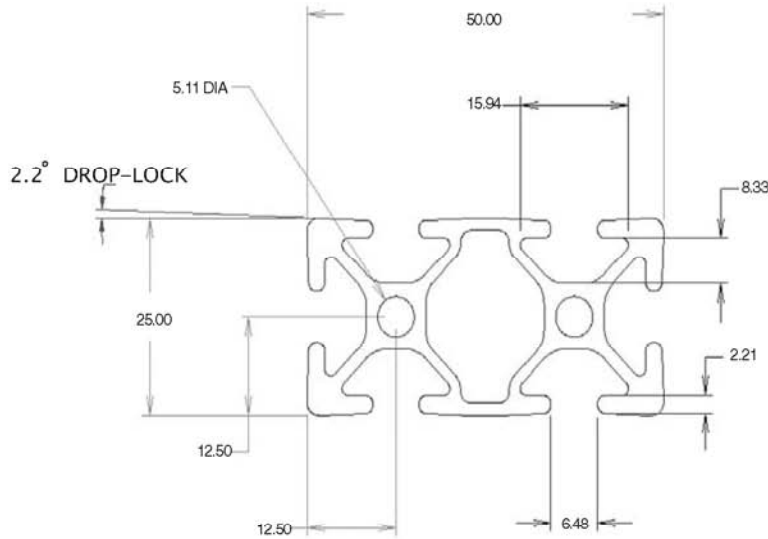

MATERIAL SPECIFICATIONS

25QE2550 T-SLOTTED EXTRUSION

MATERIAL	6063-T6
FINISH	CLEAR ANODIZE
	204R1 / .0004dp
SURFACE HARDNESS	250HV
WEIGHT PER FOOT	1.800 LBS
STOCK LENGTHS	97" +/- .125
	145" +/- .125
MOMENT OF INERTIA	IX = .1202" ⁴
	IY = .9769" ⁴
ESTIMATED AREA	1.146 Sq. In.

For 25 series machining services, see pages 374-379

Applications for 25QE2550:

- *Conveyors*
- *Custom Machine Bases*
- *Custom Workstations*
- *Light Duty Material Handling*
- *Air Manifolds*

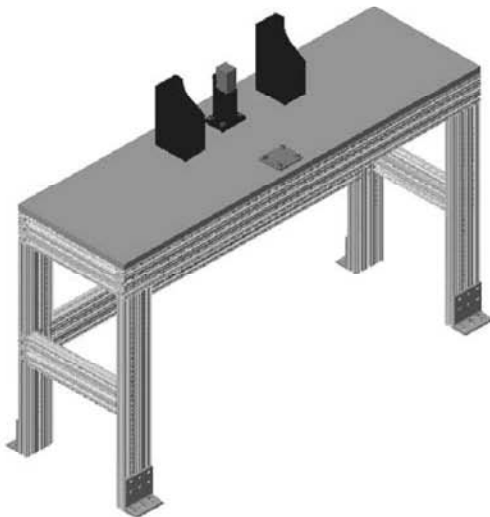

25QE2575

25mm x 75mm QUARTER ROUND T-SLOTTED ALUMINUM EXTRUSION

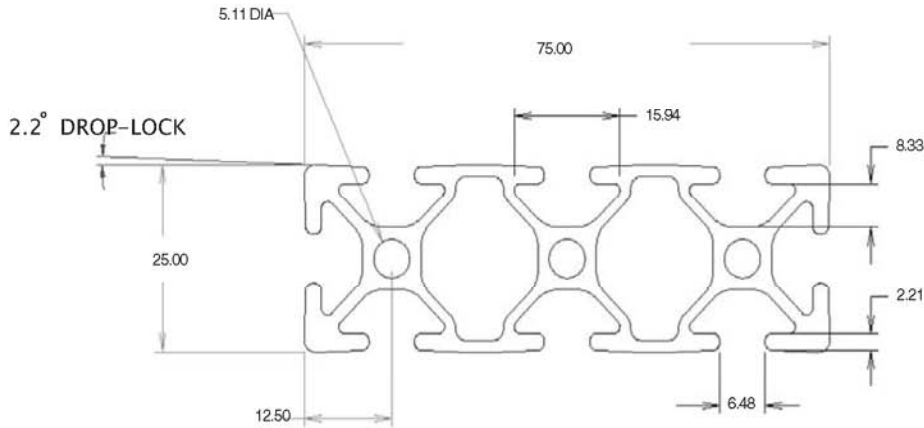

MATERIAL SPECIFICATIONS

25QE2575 T-SLOTTED EXTRUSION

MATERIAL	6063-T6
FINISH	CLEAR ANODIZE
	204R1 / .0004dp
SURFACE HARDNESS	250HV
WEIGHT PER FOOT	.954 LBS
STOCK LENGTHS	97" +/- .125
	145" +/- .125
MOMENT OF INERTIA	IX = .0834" ⁴
	IY = .3137" ⁴
ESTIMATED AREA	.795 Sq. In.

For 25 series machining services, see pages 374-379

Applications for 25QE2575:

- **Small Bases for Machines or Fixtures**
- **Small Workstations**
- **Conveyors**
- **Small Test Stations**

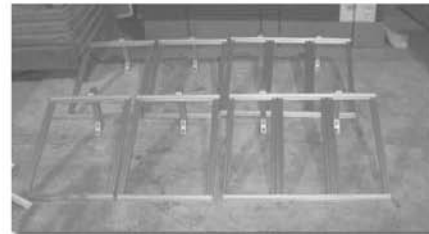
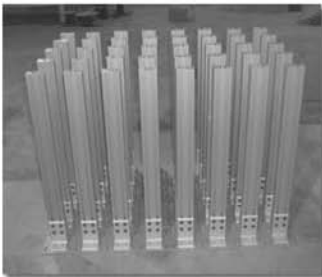

Extrusions

25QE5050

50mm x 50mm T-SLOTTED ALUMINUM EXTRUSION

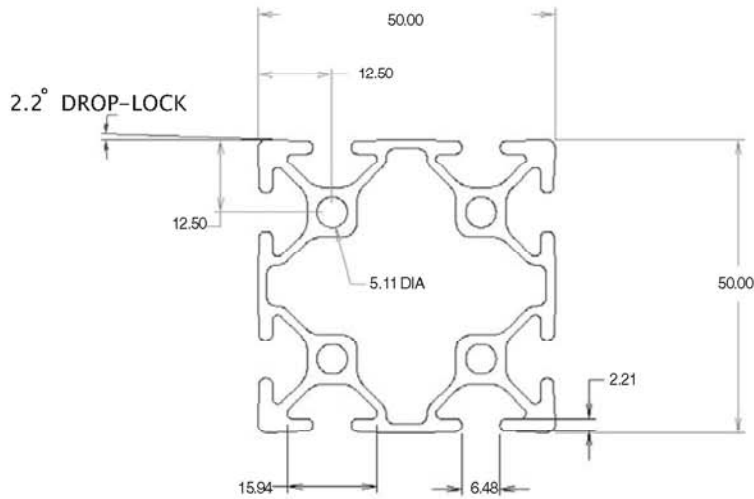

MATERIAL SPECIFICATIONS

25QE5050 T-SLOTTED EXTRUSION	
MATERIAL	6063-T6
FINISH	CLEAR ANODIZE
	204R1 / .0004dp
SURFACE HARDNESS	250HV
WEIGHT PER FOOT	1.800 LBS
STOCK LENGTHS	97" +/- .125
	145" +/- .125
MOMENT OF INERTIA	IX = .1202" ⁴
	IY = .9769" ⁴
ESTIMATED AREA	1.146 Sq. In.

For 25 series machining services, see pages 374-379

Applications for 25QE5050:

- **Conveyors**
- **Custom Machine Bases**
- **Custom Workstations**
- **Light Duty Material Handling**
- **Air Manifolds**

